

GARMIN

CTU WITH SCREEN
P12534 07/01/2025 Rev A

CLIENT GUIDE

Tools Required (supplied)



Parts

Ⓐ x1

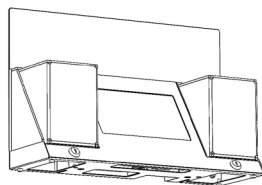

Ⓑ x1

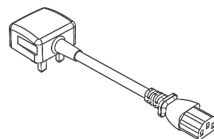

1

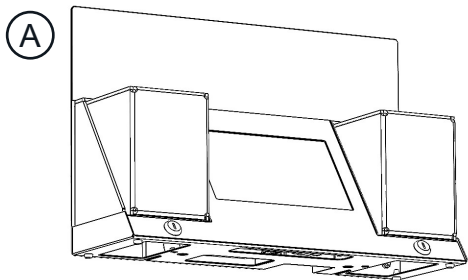

UNBOX AND REMOVE UNIT
FROM CARTON

2

IF POWER CABLE IS NOT FITTED FOLLOW THESE STEPS

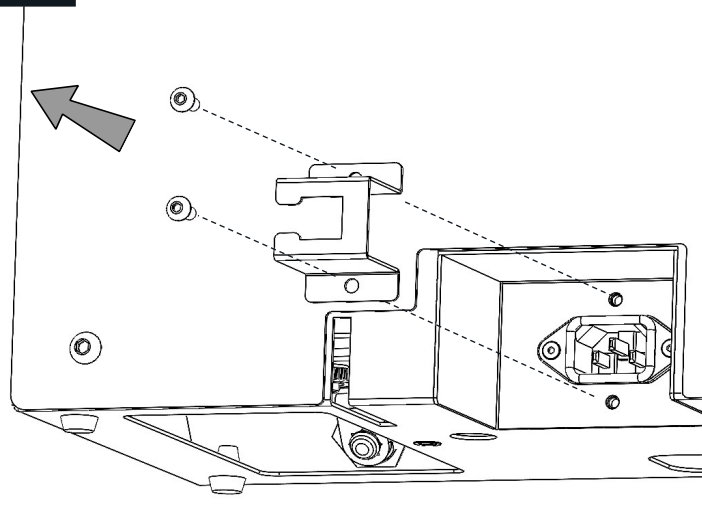

3

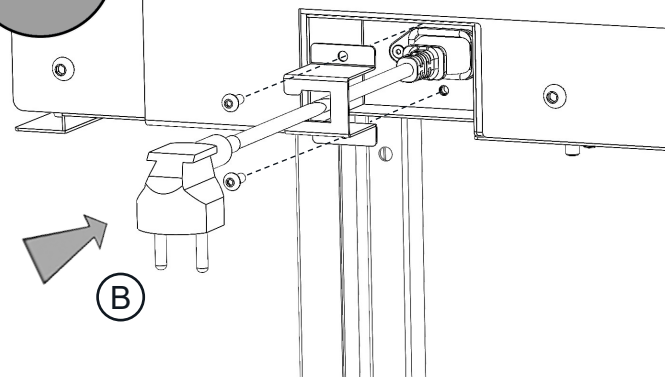
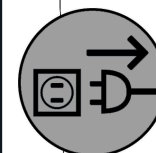

4

ACCESSING SCREEN DATA

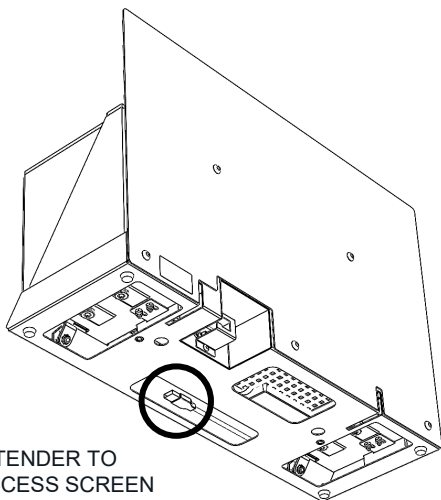

USE USB EXTENDER TO
UPDATE AND ACCESS SCREEN

5

ACCESSING LOCKED PRODUCT BOX

USE THE SUPPLIED
KEYS TO UNLOCK
THE LOCK ON THE
FRONT FACE.

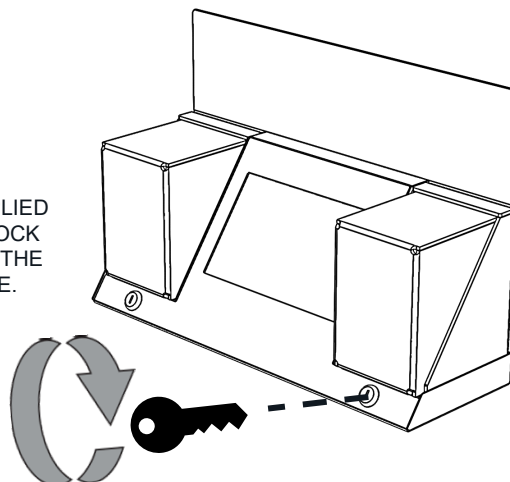

6

SLIDE THE FRONT
SECTION OF THE
PRODUCT CASE OUT.

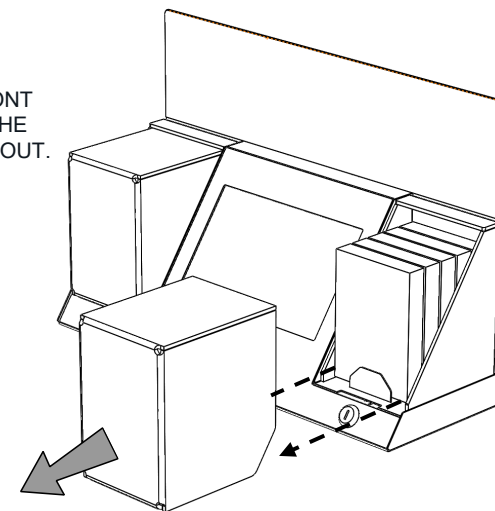

7

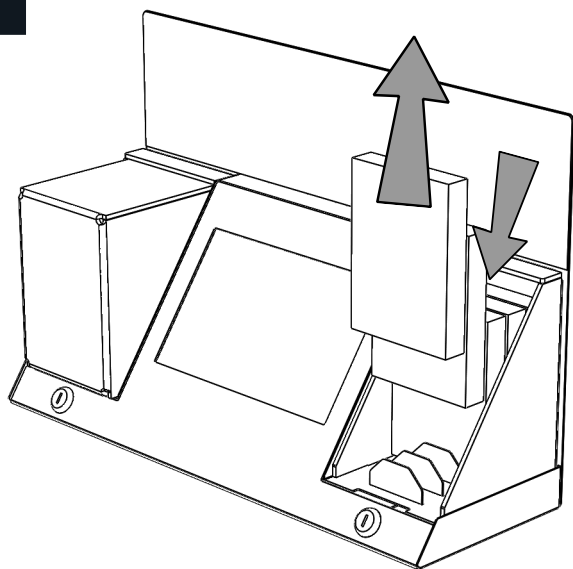

REMOVE AND ADD PRODUCT
UNITS TO THE SLOTTED
SECTIONS IN THE BASE.

8

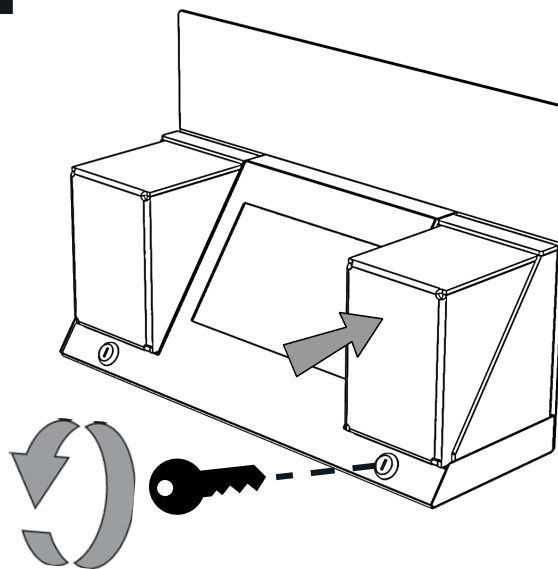

RETURN CASE FRONT AND
LOCK USING THE KEY.