

GARMIN

CCD DISPLAY

P12676

31/07/2024

# ASSEMBLY GUIDE TOP SCREEN + BASE

## TOOLS REQUIRED

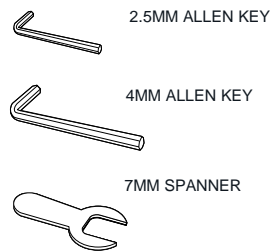

## Parts

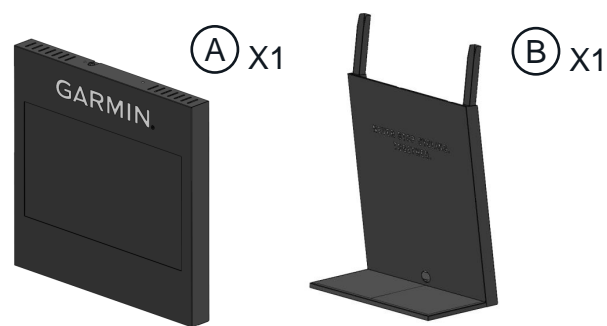

TOP  
SCREEN

BASE

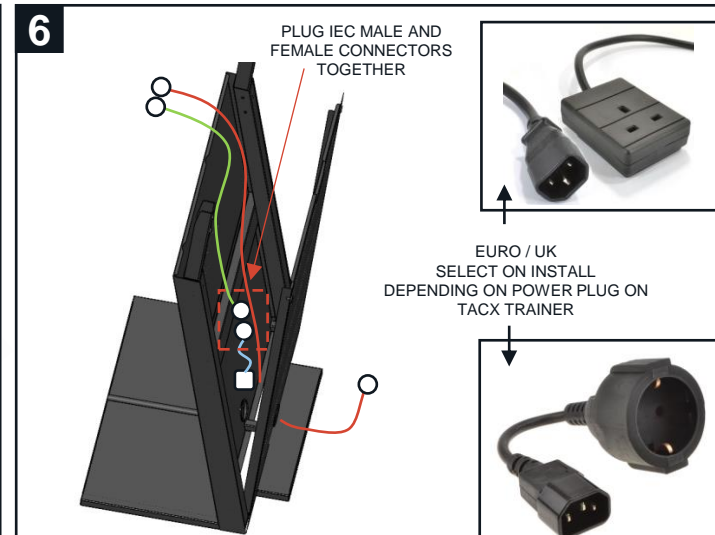
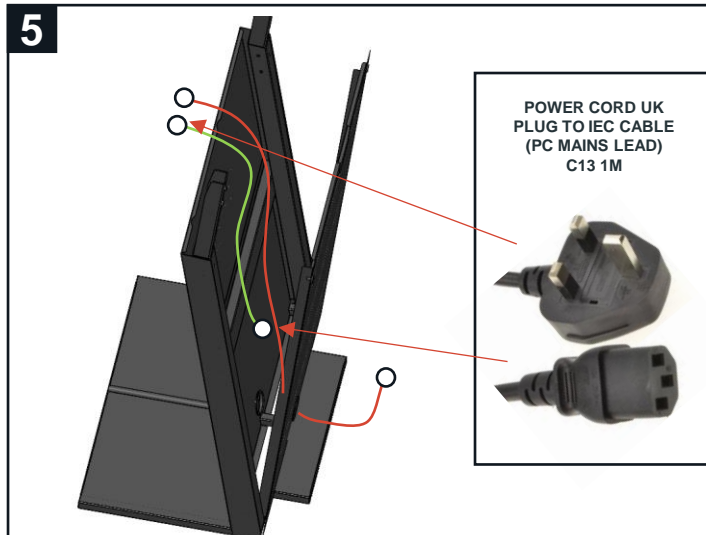
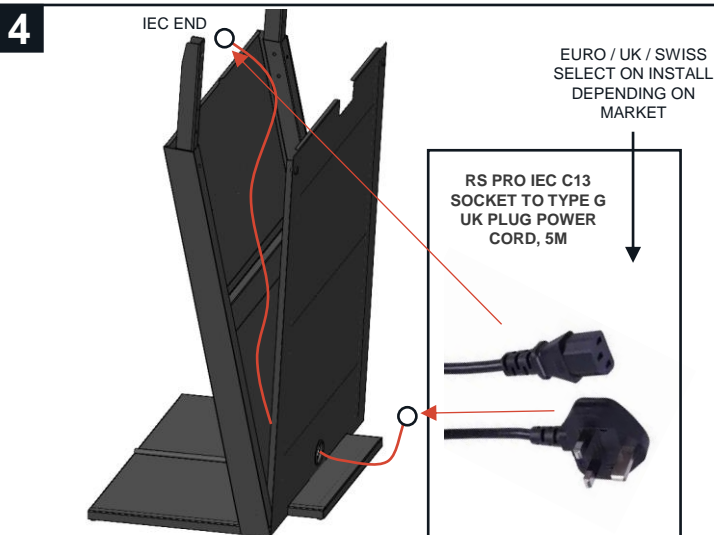
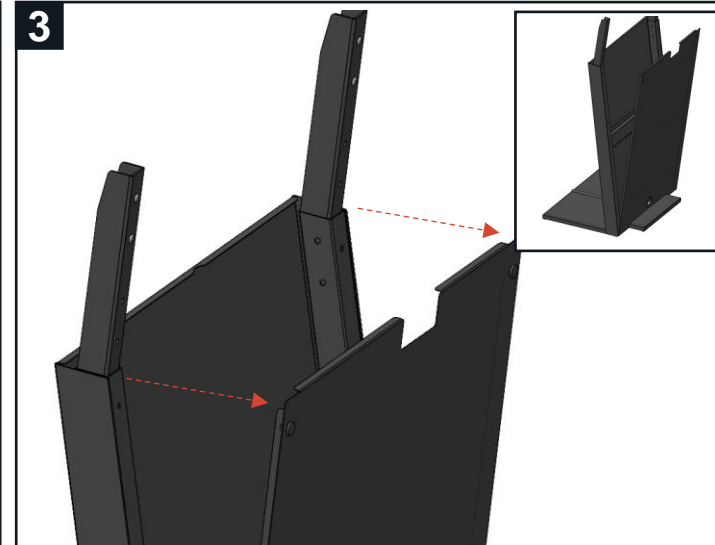
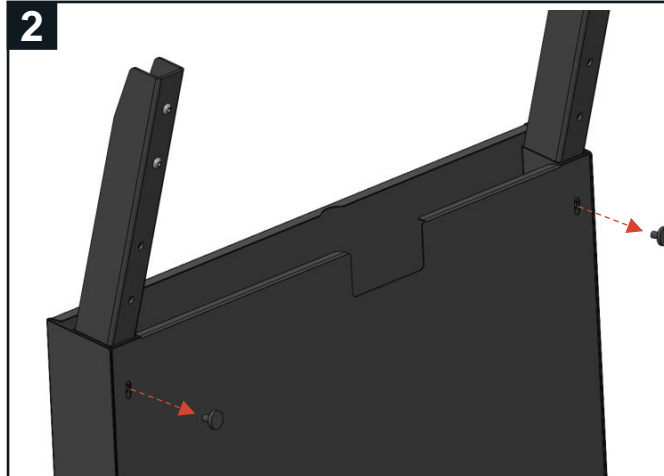
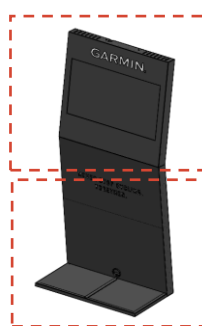

GARMIN®

7

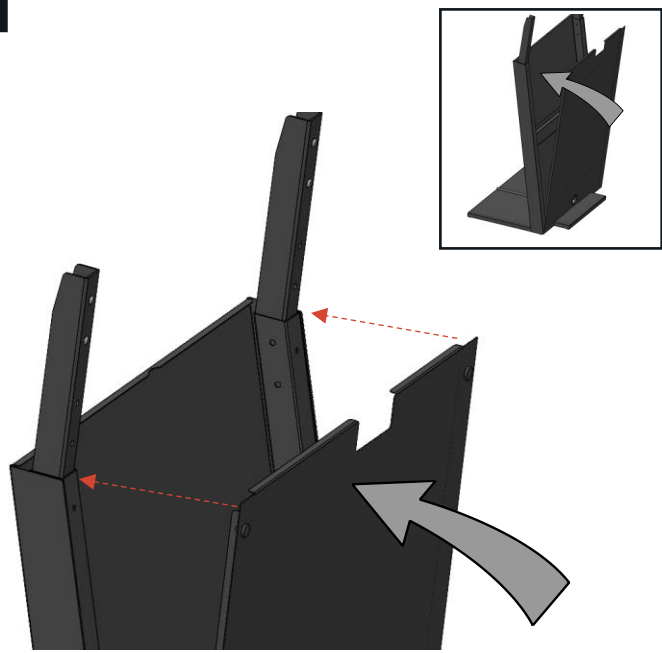

8

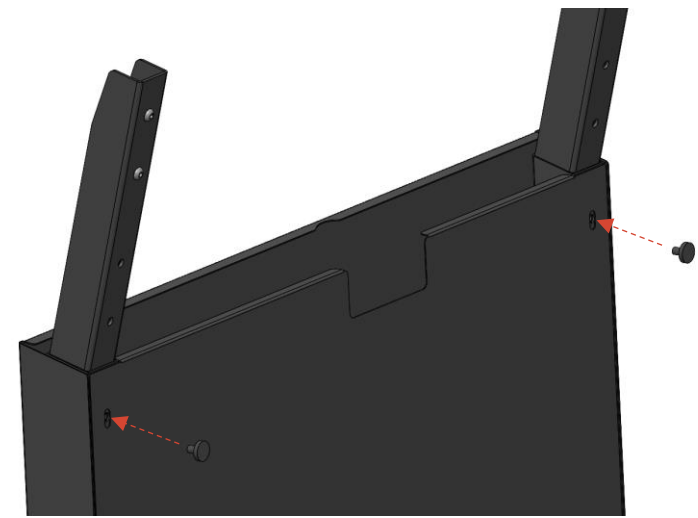

9



10

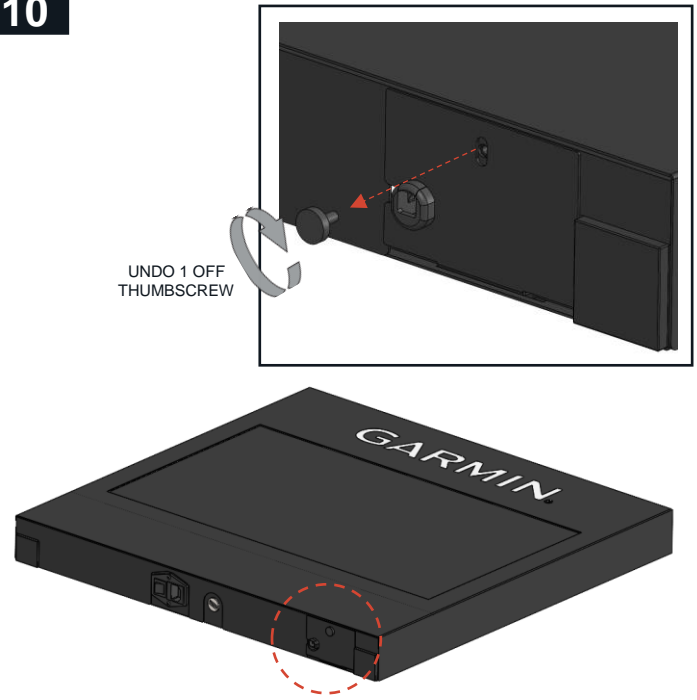

11

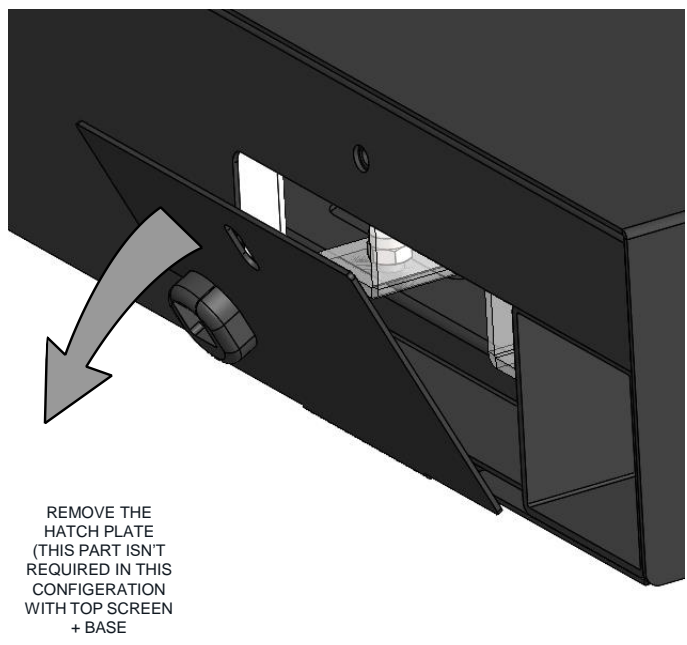

12

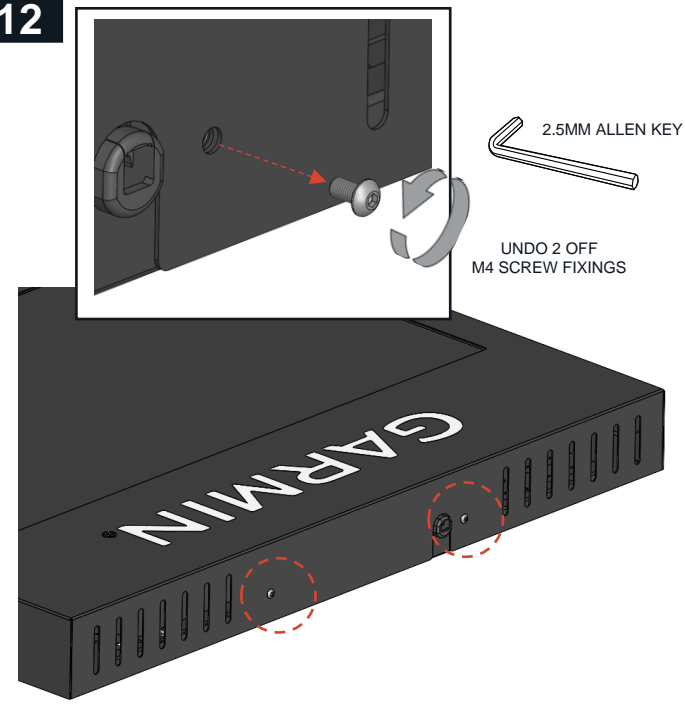

13

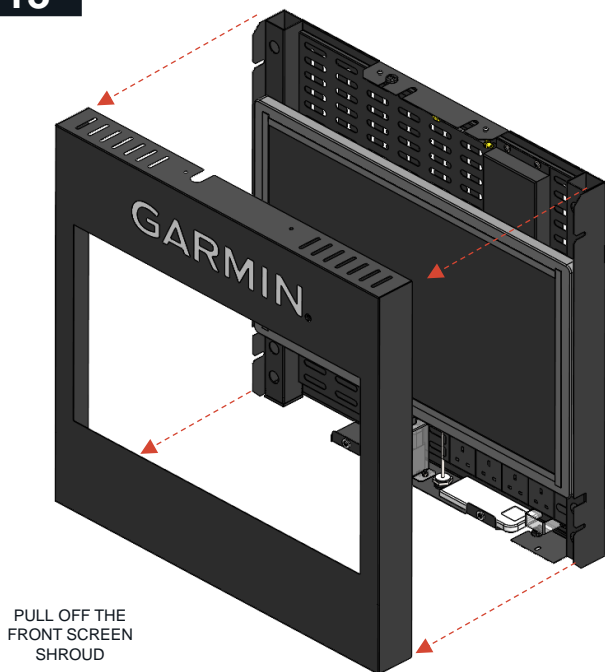

14



CAREFUL NOT TO TRAP FINGERS WHEN SEPARATE COMPONENTS MEET

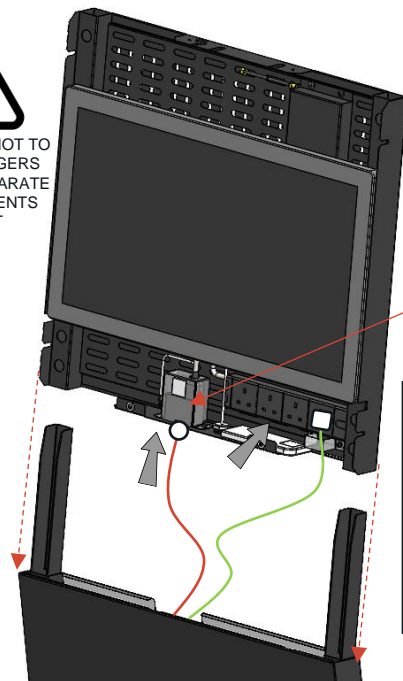

RS PRO IEC C13 SOCKET TO TYPE G UK PLUG POWER CORD, 5M

PLUG IEC END INTO MAINS POWER INLET



POWER CORD UK PLUG TO IEC CABLE (PC MAINS LEAD) C13 1M

PLUG UK END INTO MAINS POWER GANG SOCKET

15

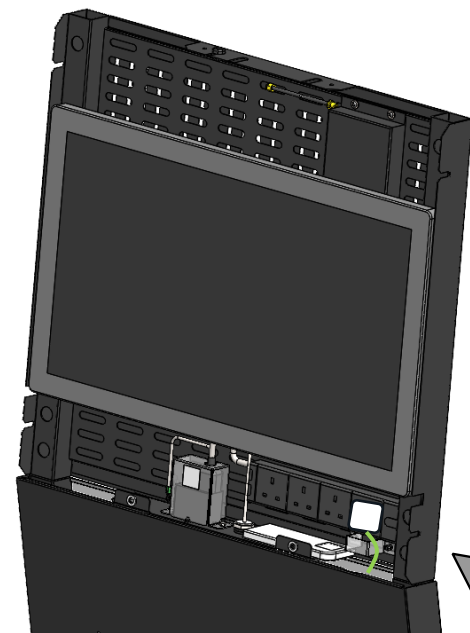

SLIDE TOP ASSEMBLY OVER THE 2 OFF SPIGOTS ON THE BASE ASSEMBLY

16

7MM SPANNER

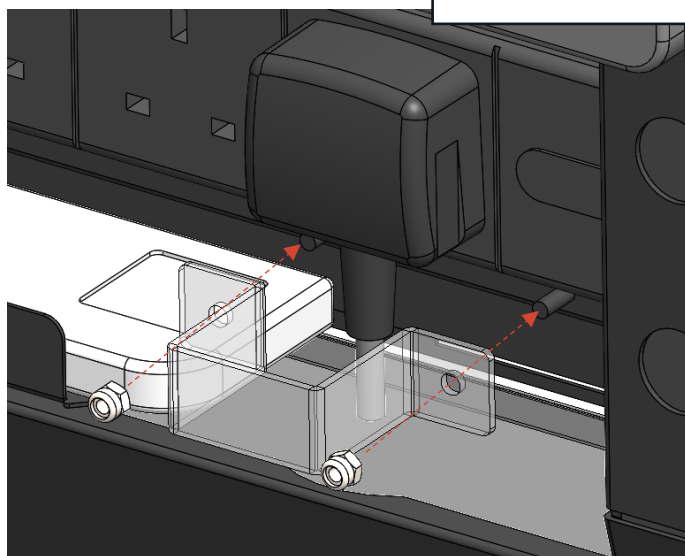

21

CHECK THE HDMI CABLE IS IN THE CORRECT PORT

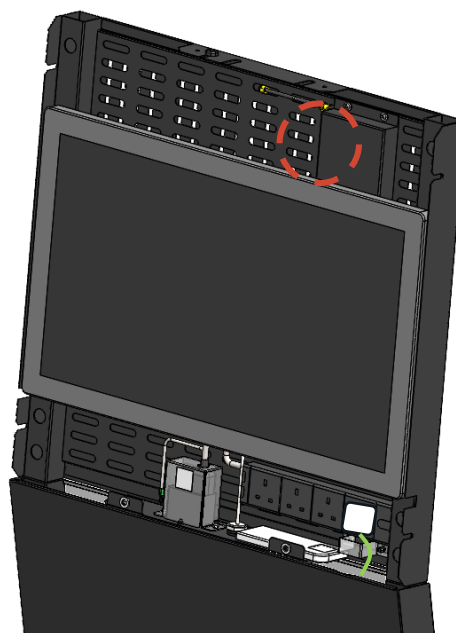

22

MAKE SURE THAT HDMI CABLE IS PLUGGED INTO THE HDMI OUT PORT

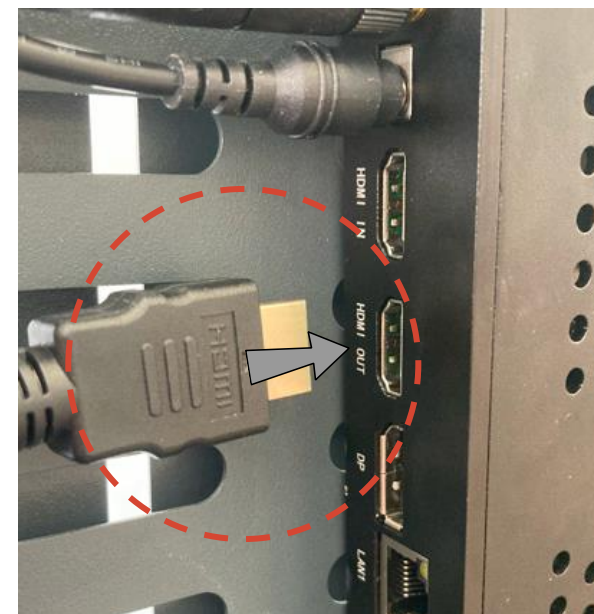

**GARMIN®**



23

SWAP THE USB CABLES OVER (SO THAT THE USB CABLE FROM THE SCREEN GOES INTO THE SECOND PORT DOWN (AND IS PLUGGED INTO USB 2.0))

24

USB CABLE FROM SCREEN  
(CURENRT IN WRONG PORT)

25

SWAP OVER

MOVE SCREEN USB CABLE UP TO THIS

PORTS 2.0

AND MOVE THE EXISTING USB CABLE DOWN INTO

PORT 3.0

26

AT THIS STAGE REMOVE THE MINI KEYBOARD (THIS WILL BE REPLACED INTO THE UNIT LATER)

SLIDE BACK ON FRONT SCREEN SHROUD

27

RE-ATTACH 2 OFF M4 SCREW FIXINGS

2.5MM ALLEN KEY

28

FASTEN THE TOP SCREEN ASSEMBLY TO BASE WITH 4 OFF M6X10 BLACK SCREWS

4MM ALLEN KEY

## 29 INSTALLING THE TACX TRAINER

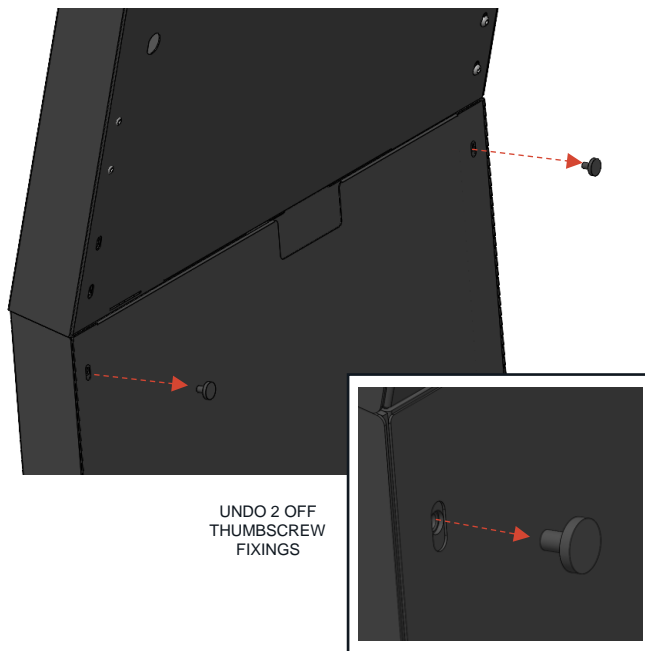

30

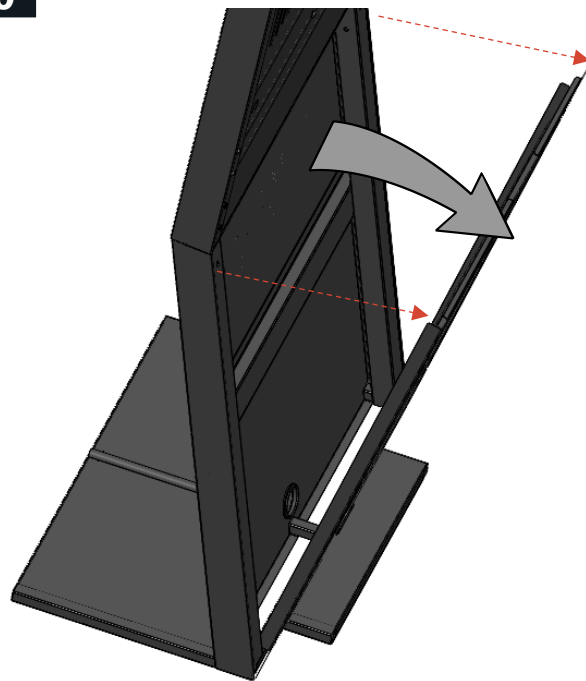

31

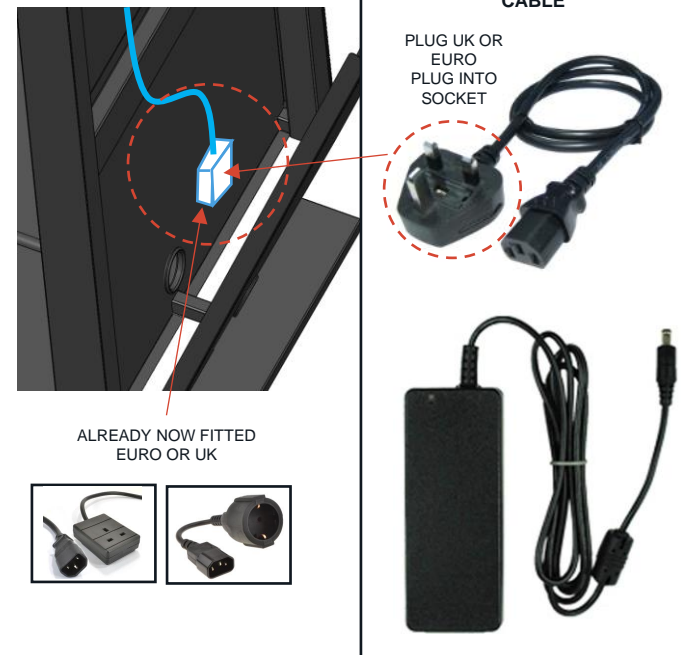

32

FEED THE IEC SOCKET END THROUGH FRONT BOTTOM GROMMET HOLE IN DISPLAY  
(FROM INSIDE)

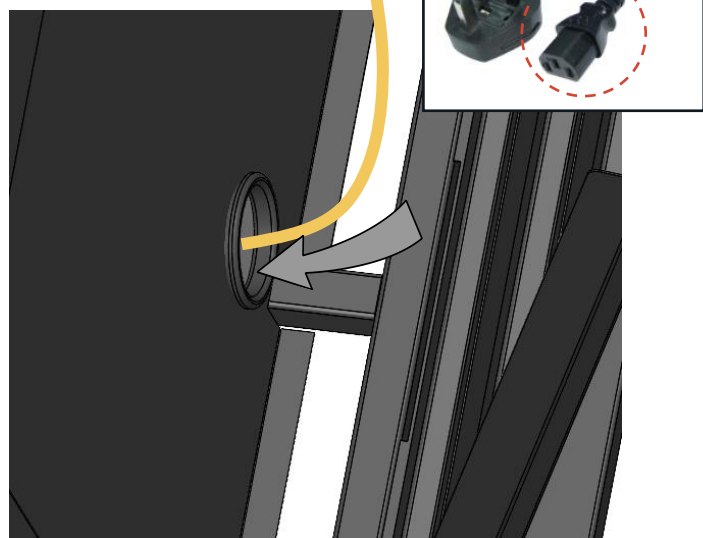

33

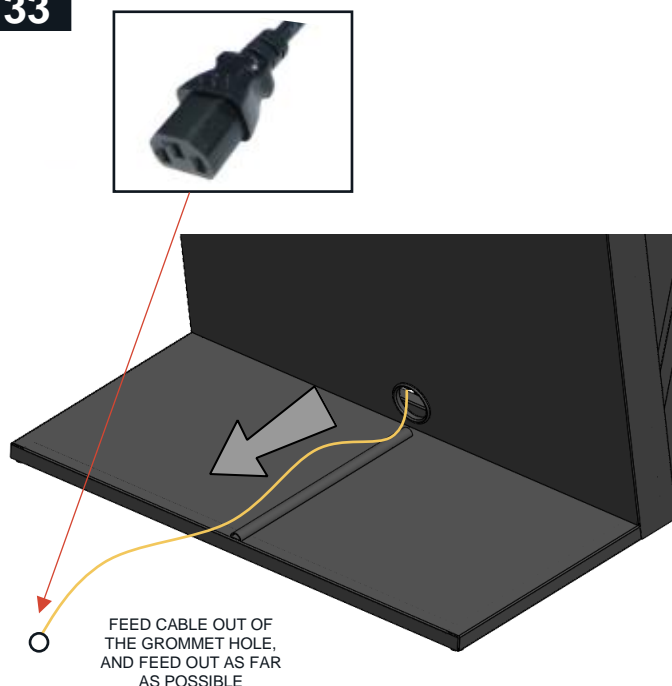

34

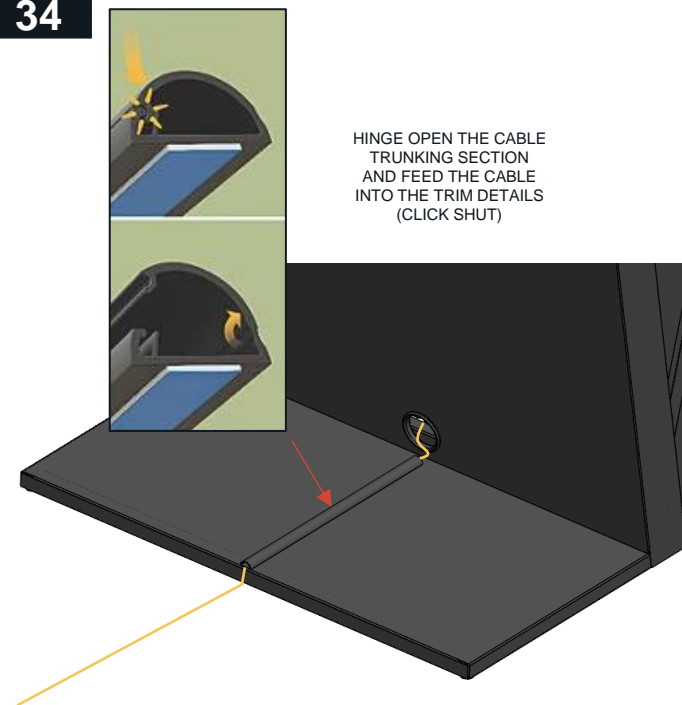

35

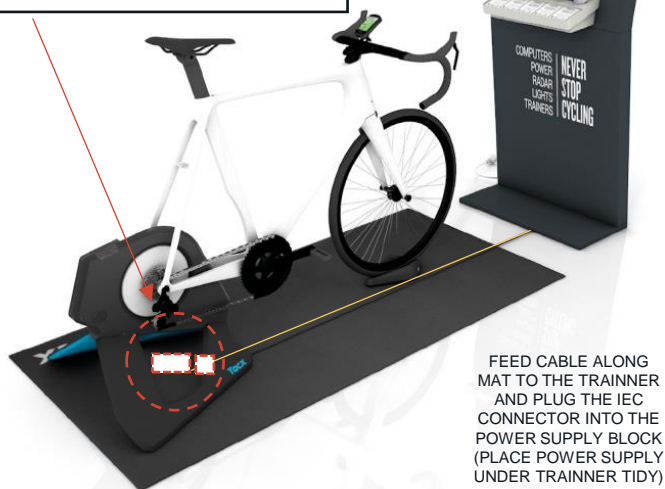
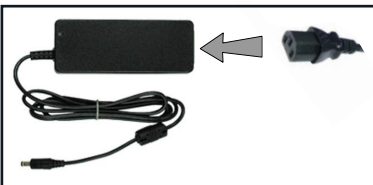

FEED CABLE ALONG MAT TO THE TRAINER AND PLUG THE IEC CONNECTOR INTO THE POWER SUPPLY BLOCK (PLACE POWER SUPPLY UNDER TRAINER TIDY)

36

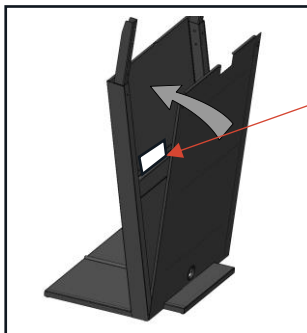

PLACE KEYBOARD ONTO THIS LEDGE DETAIL INSIDE THE DISPLAY

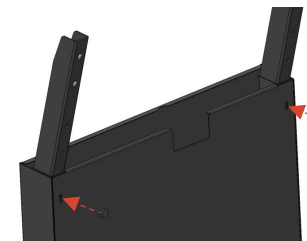

37

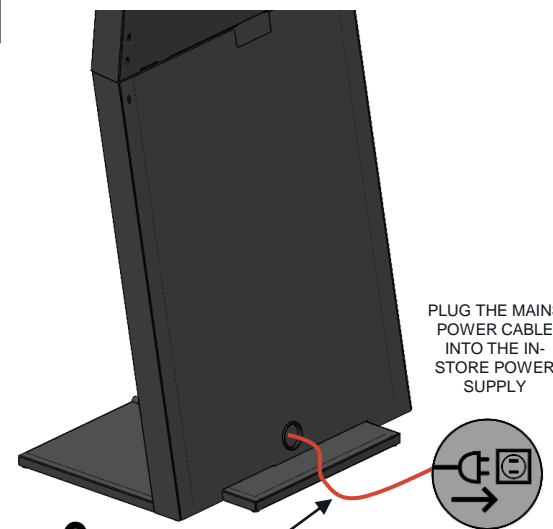

PLUG THE MAINS POWER CABLE INTO THE IN-STORE POWER SUPPLY



TRAILING CABLE MUST NOT BE PLACED ALONG WALKWAY AREA WHERE IT COULD BE A POTENTIAL TRIP HAZARD

38

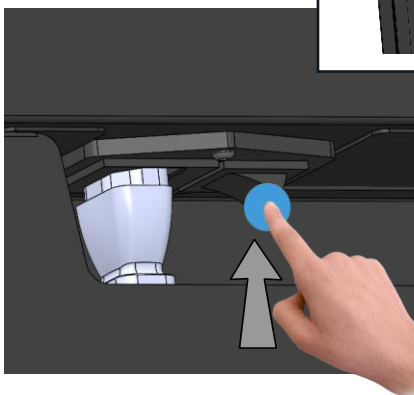
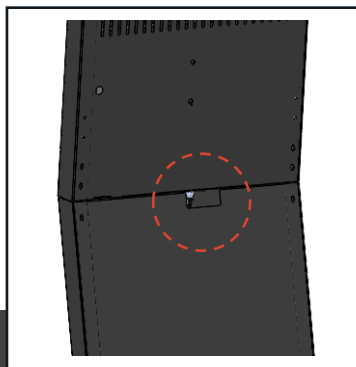

SWITCH ON THE DISPLAY

39

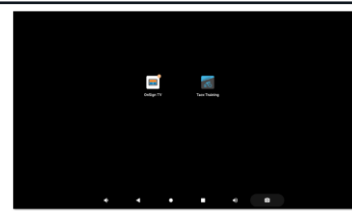

Once the device is booted, you will see these 2 apps on the Home Screen.

ONCE DISPLAY IS PLUGGED INTO POWER SUPPLY AND SWITCHED ON

(YOU WILL BE PRESENTED WITH THIS SCREEN)

NOW REFER TO DOCUMENT

**GARMIN CCD –  
DIGITAL  
CONFIGURATION -  
ANDROID**