

ASSEMBLY GUIDE

TOOLS REQUIRED - NOT SUPPLIED

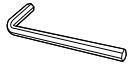

SECURITY
TORX X10

Parts

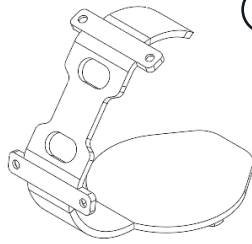

(A) x1

(B) x2

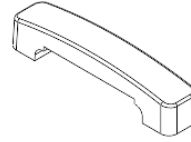

(C) x4
M3x6 SECURITY
SCREW

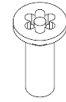

(D) x4
M3x10 SECURITY
SCREW

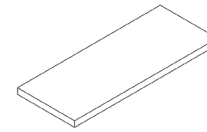

(E) x1

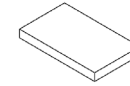

(F) x2

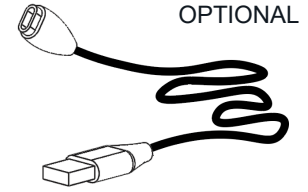

(G) x1
OPTIONAL

1

(A) x1

(F) x2

(E) x1

STICK RUBBER PADS TO UNDERSIDE OF CRADLE BETWEEN SCREW HOLES AND UNDER EACH STRAP RESTRAINT

2

FOLD THE WATCH BACK ON ITSELF, LEAVING THE GARMIN LOGO FACING FORWARDS

3

(B) x2

(C) x4
OR
(D) x4

(G) x1

USB-C END

4

ENSURE WATCH STRAP AND CHARGING CABLE ARE TUCKED UNDER CRADLE WHEN ATTACHING TO SECURITY MOUNT

REF. ONLY

5

6