

GARMIN

CORPORATE DISPLAY

P12674 | 23/02/2026

600 CTU + GRAPHIC HEADER
+ BRONZE POSTS

TOOLS REQUIRED – SUPPLIED

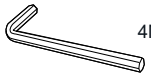

4MM ALLEN KEY

Parts

(A) X1

600MM

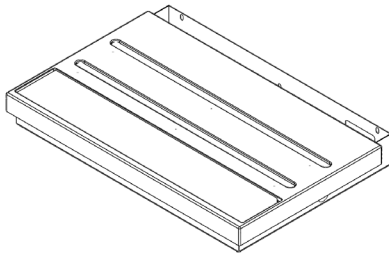

(B) X1

600MM

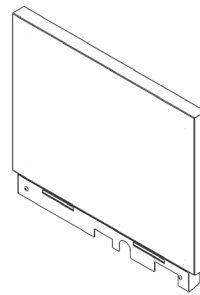

(D) X7

BRONZE
SECURITY
POSTS
(PRE-FITTED)

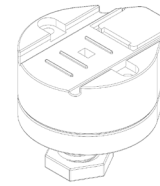

(E) X5

M6X8MM
SCREW

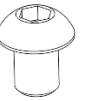

(C) X1



1

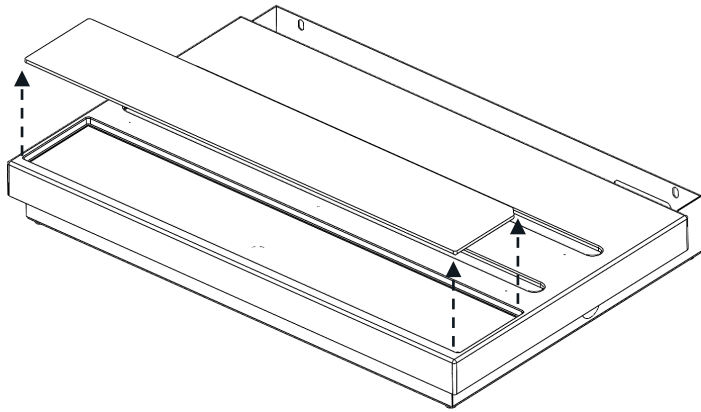

2

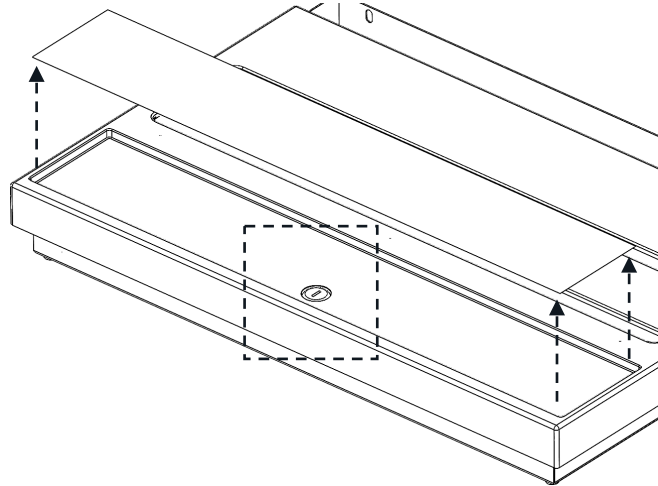

3

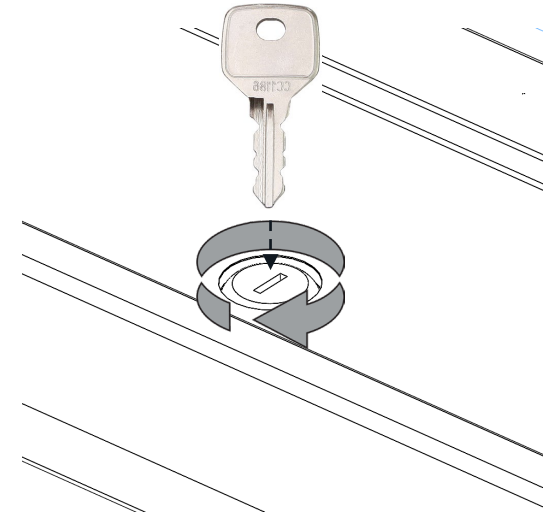

4

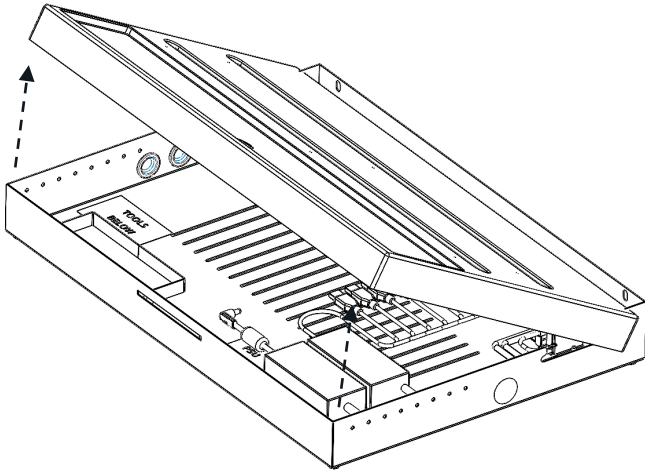

5

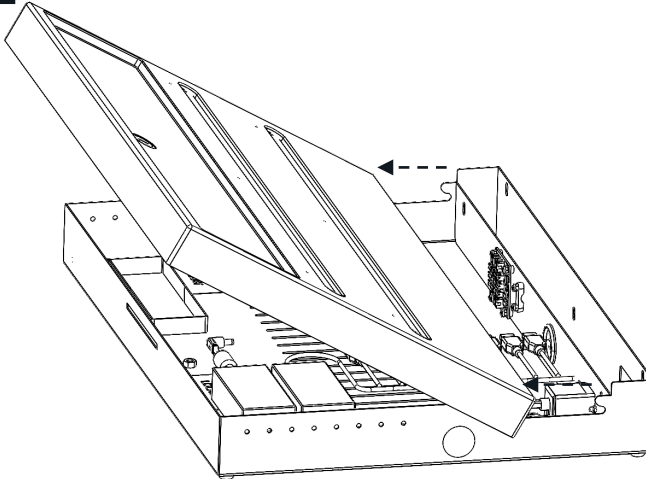

6



MUST TWIST LOCKING PLATES
TO HOLD TOP SURFACE IN
POSITION
(REPEAT BOTH SIDES)

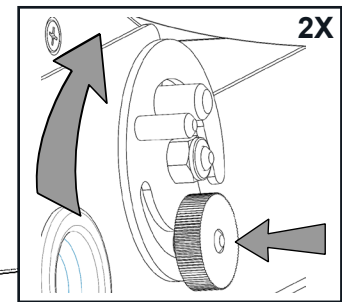

2X

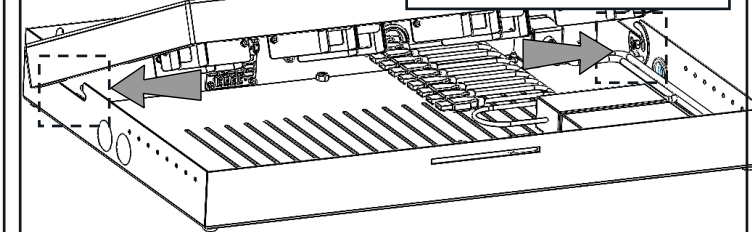

GARMIN

7



RED SUPPORT ARM MUST BE SWUNG INTO POSITION TO SUPPORT TOP PLATE

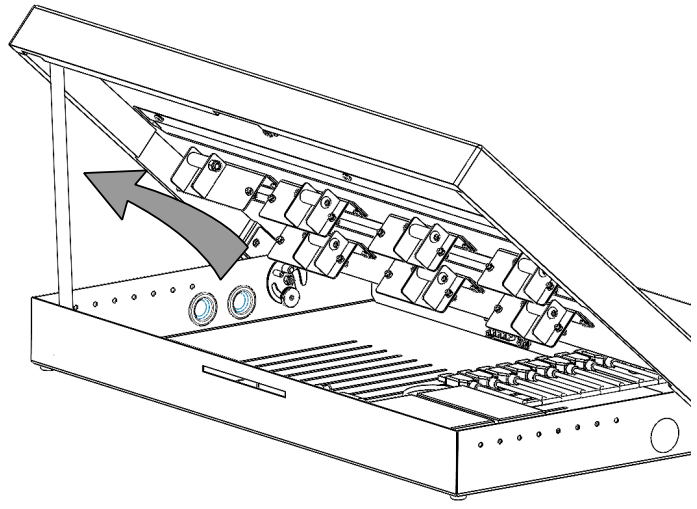

8

(B) X1

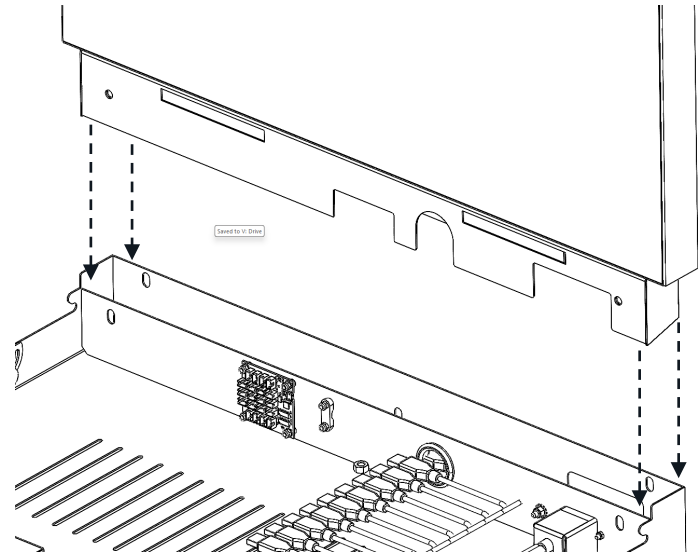

9

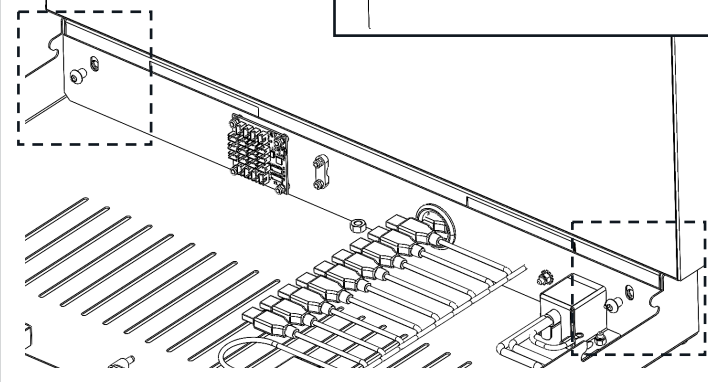
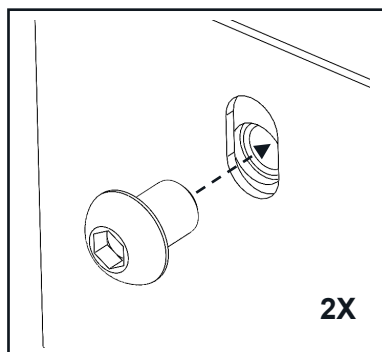

10

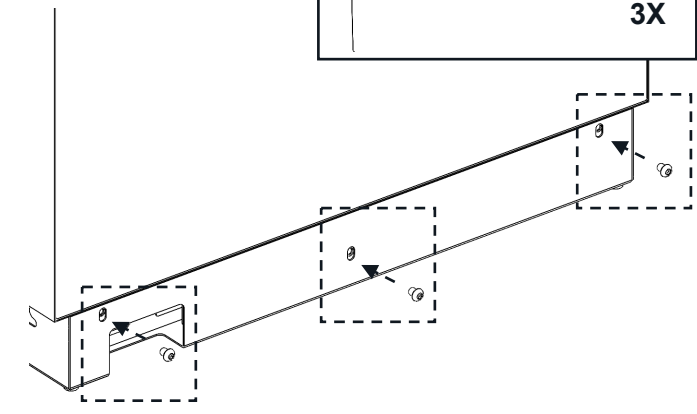
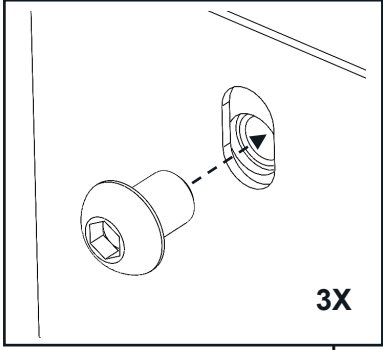

11

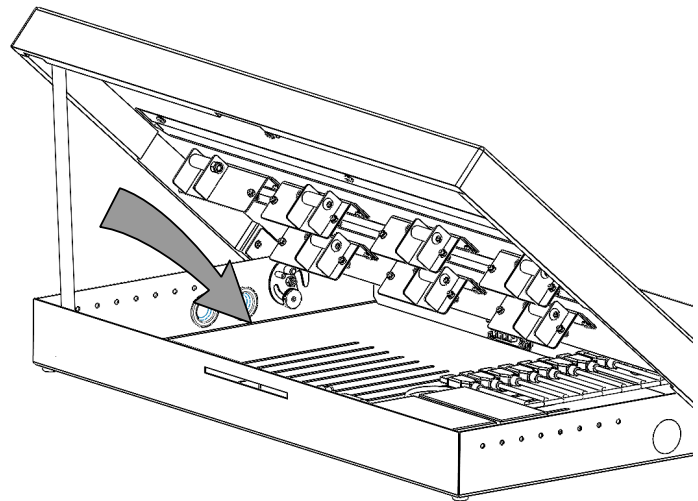

12

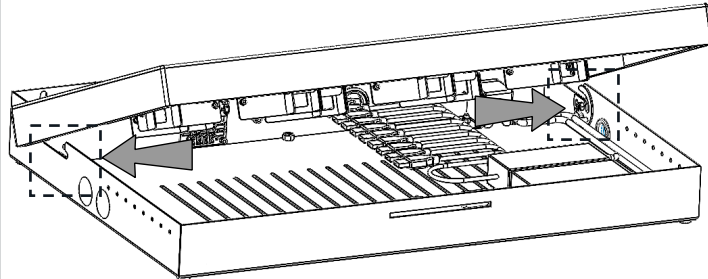
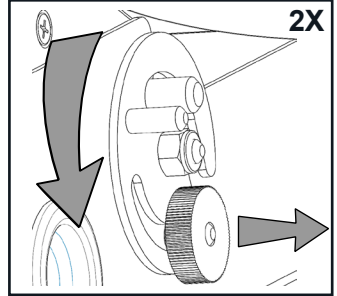

13

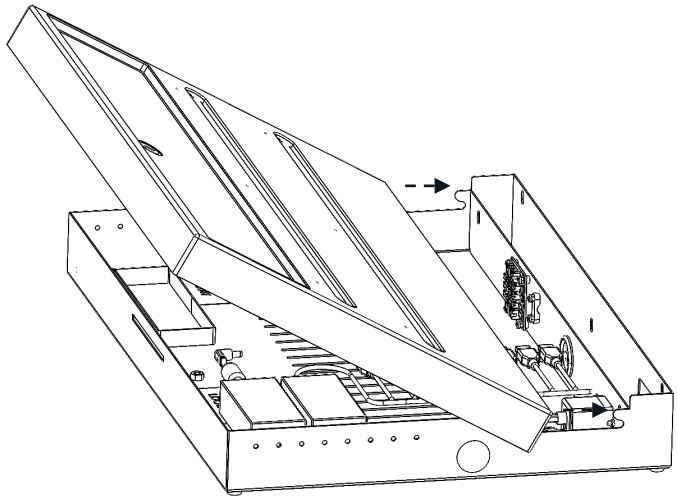

14

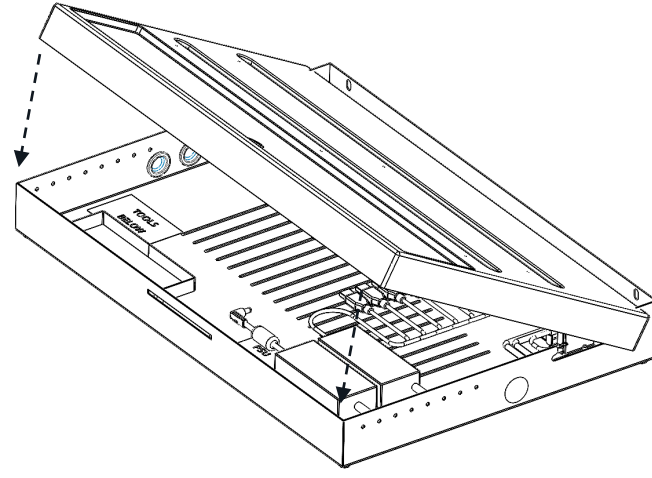

15

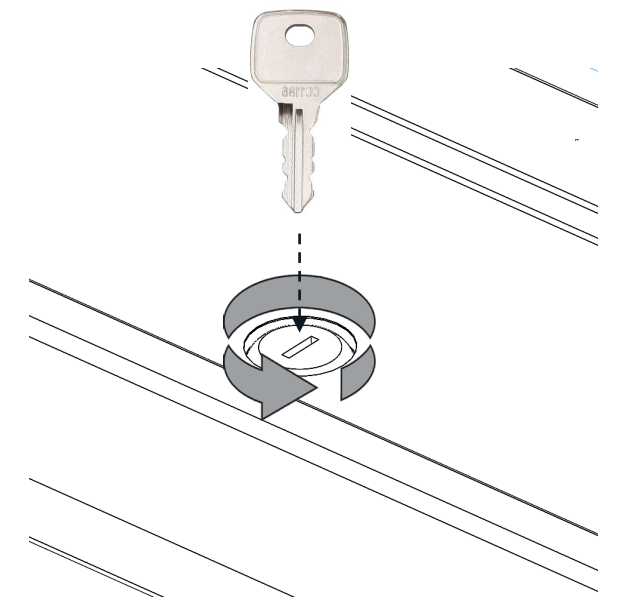

16

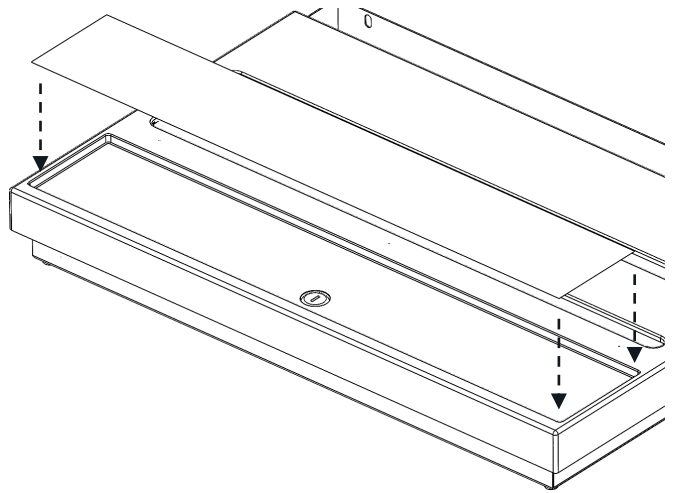

17

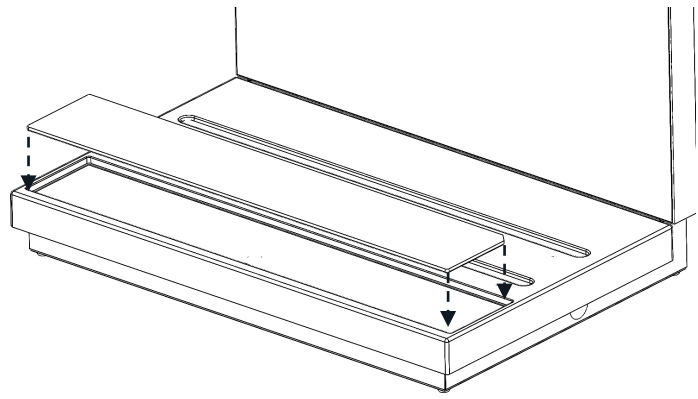

18

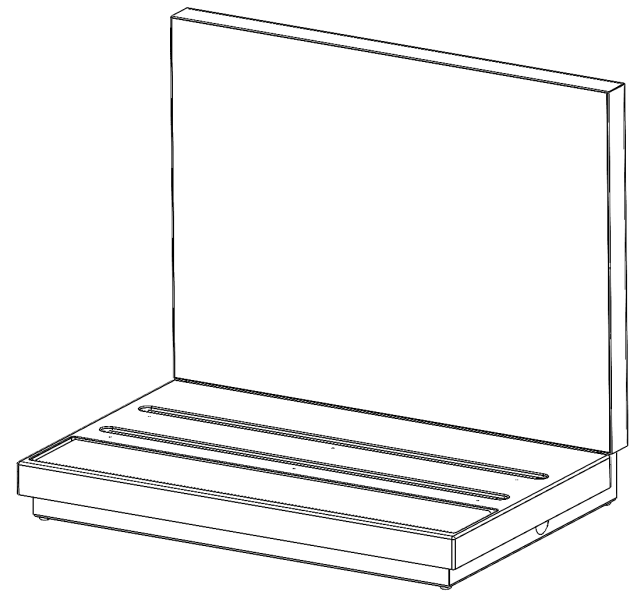

Fitting security to your CTU

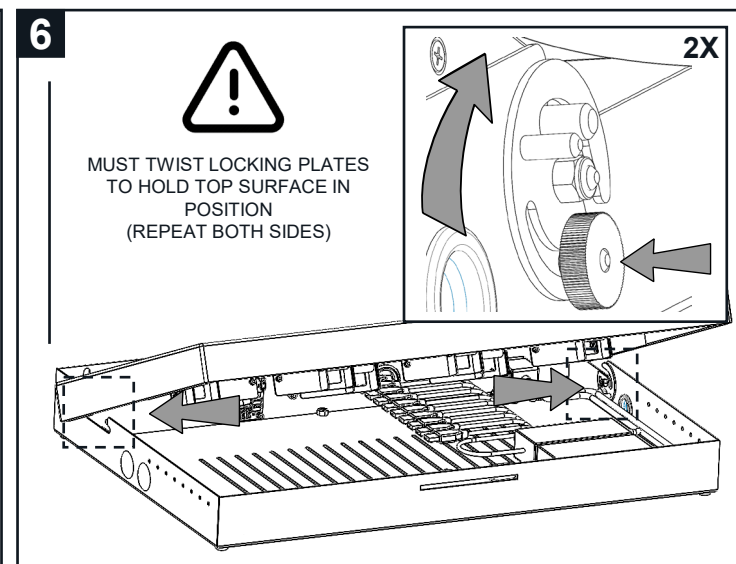
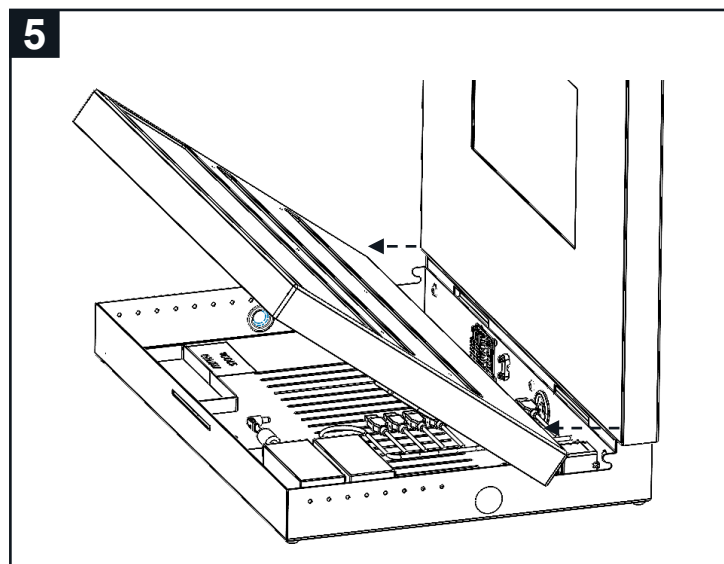
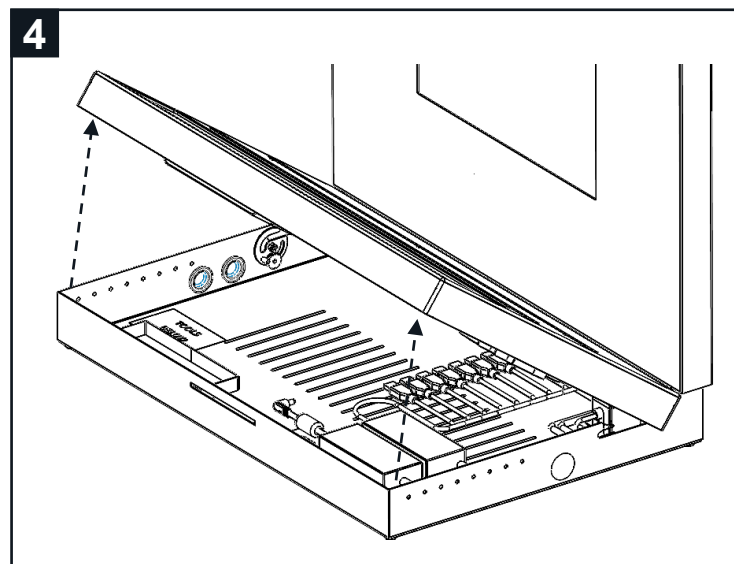
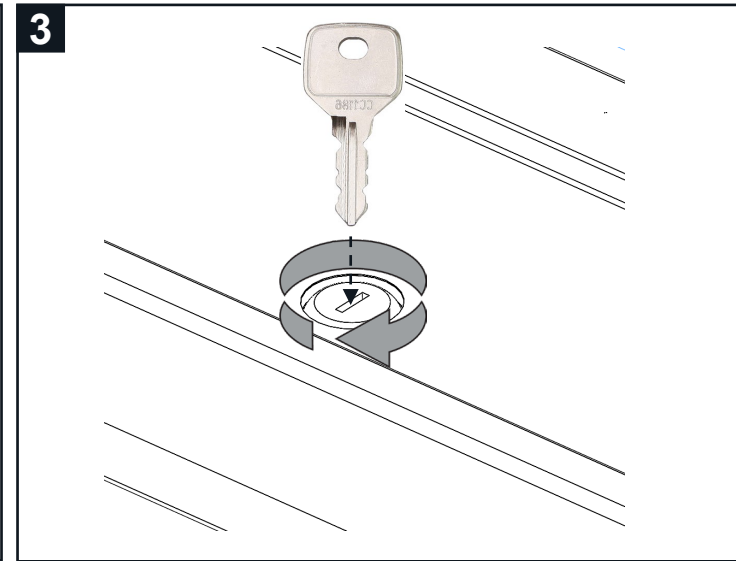
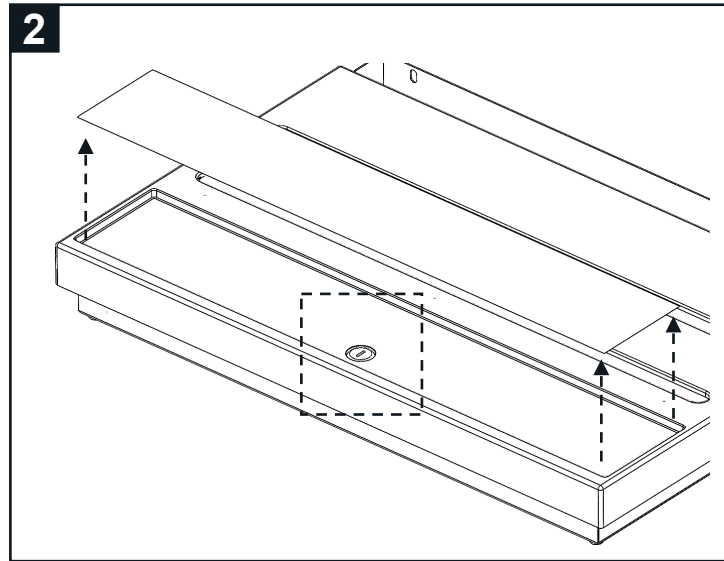
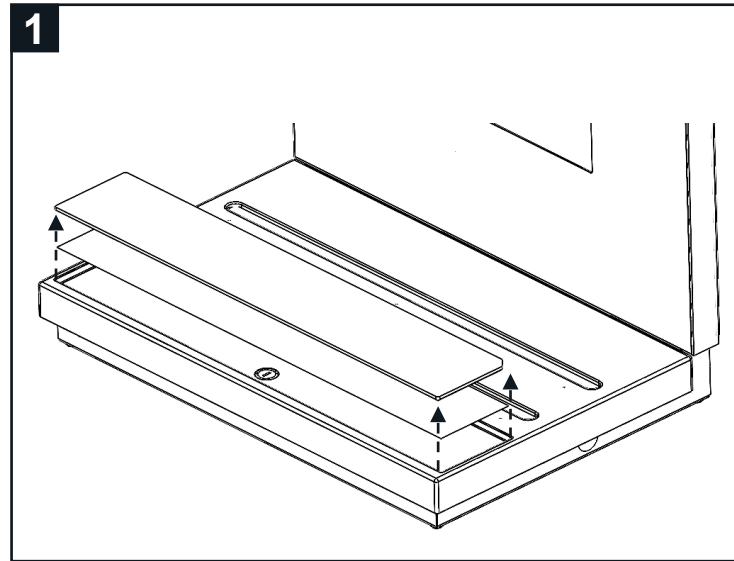

7



RED SUPPORT ARM MUST BE SWUNG INTO POSITION TO SUPPORT TOP PLATE

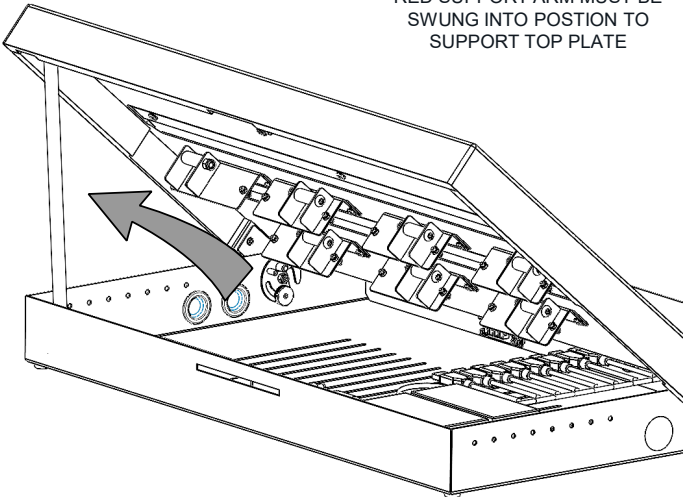

8

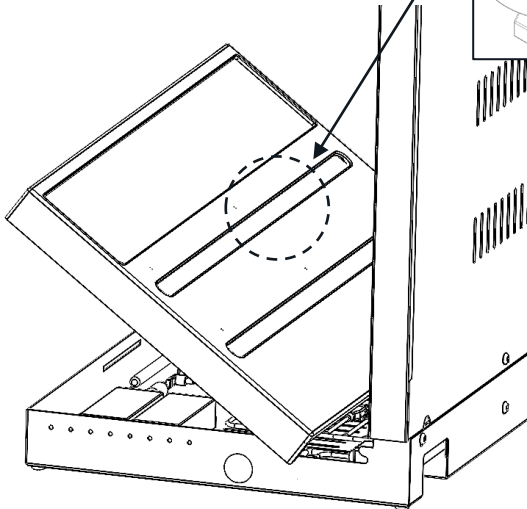
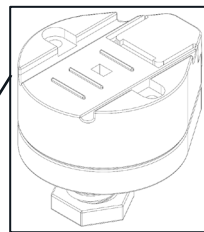

9

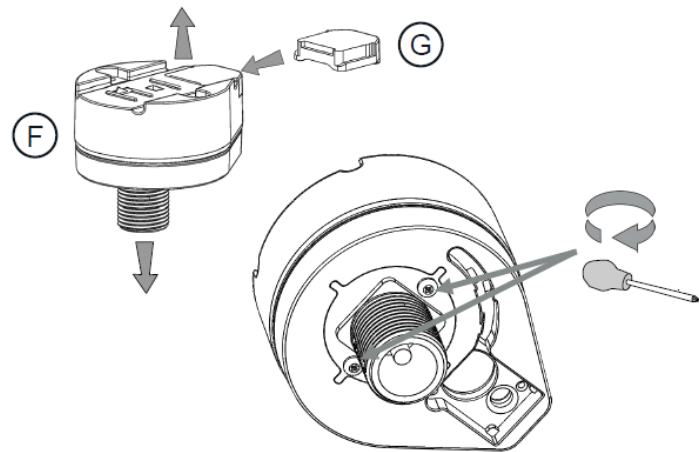

10

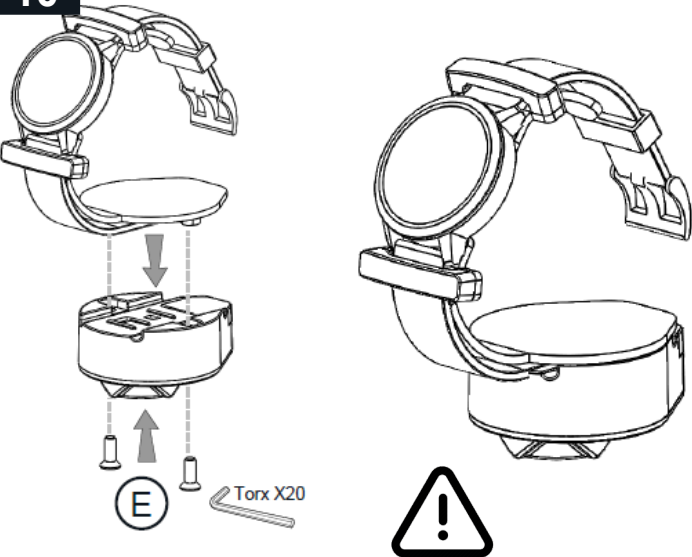

ON BRONZE FIXED CRADLES IT IS IMPORTANT THAT THE METAL CRADLE IS FITTED TO THE TOP SECTION OF THE PLASTIC POST FIRST, BEFORE MOUNTING ONTO UNIT

11

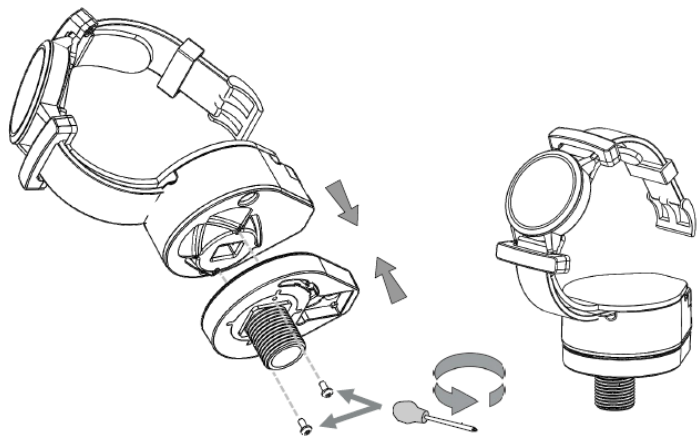

12

REPEAT THE FOLLOW PROCESS FOR ALL POSTS (NO. DEPENDING ON 400 OR 600 CTU)

7 OFF FOR 600MM
5 OFF FOR 400MM

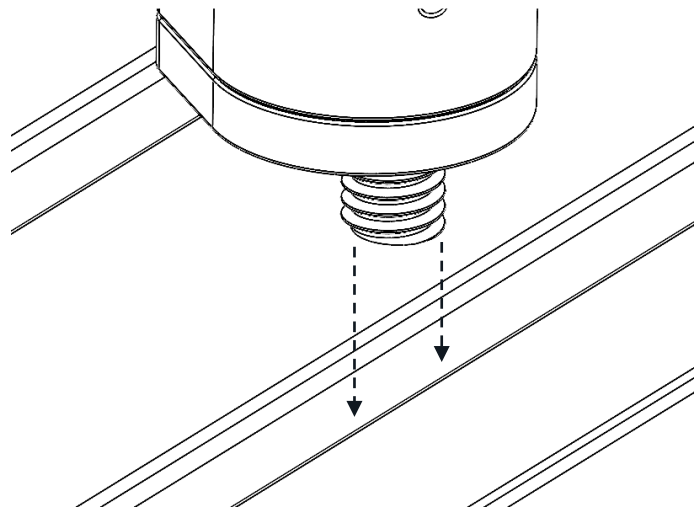

13

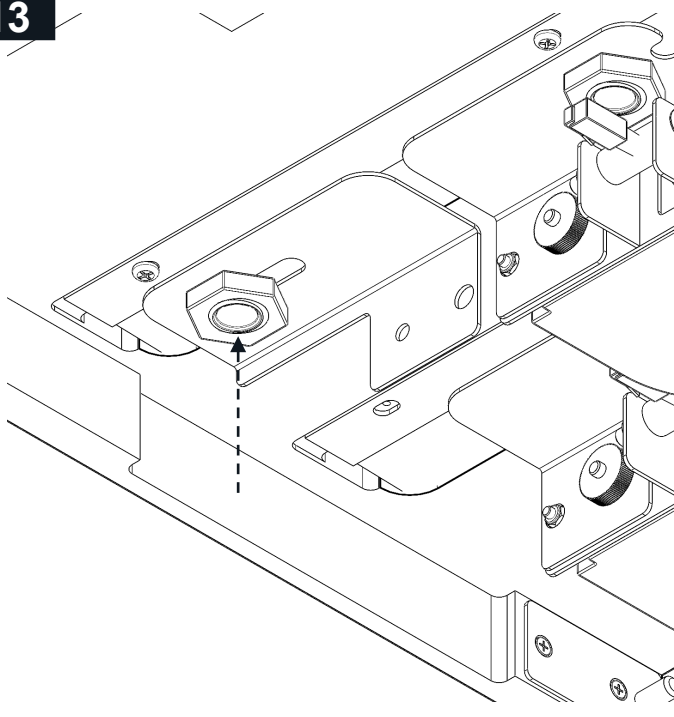

14

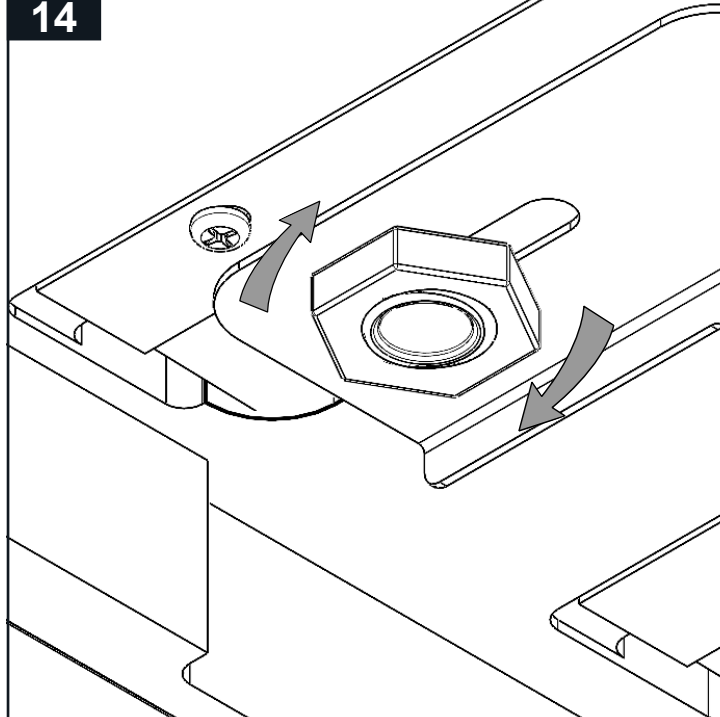

15

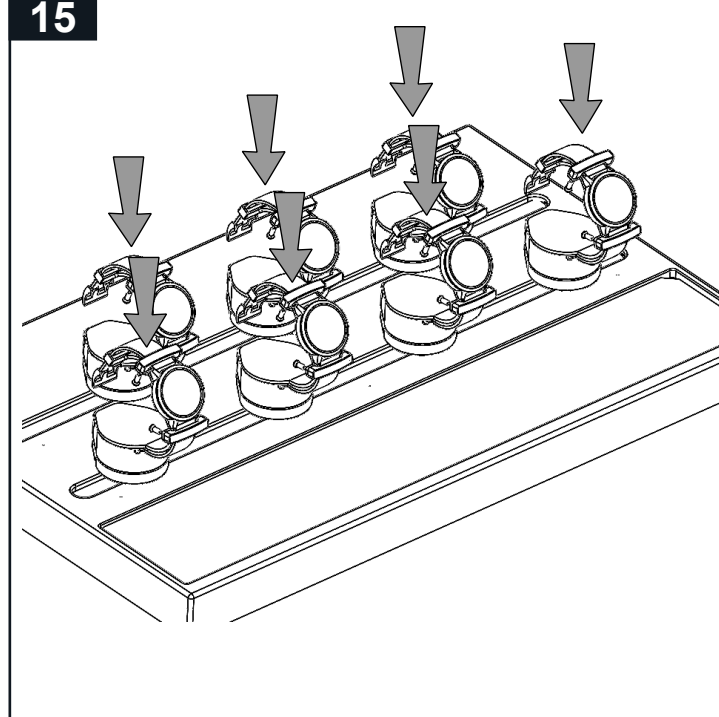

16

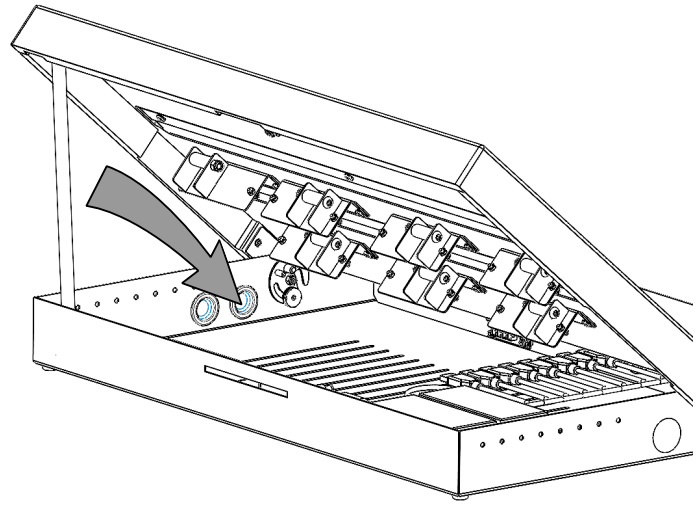

17

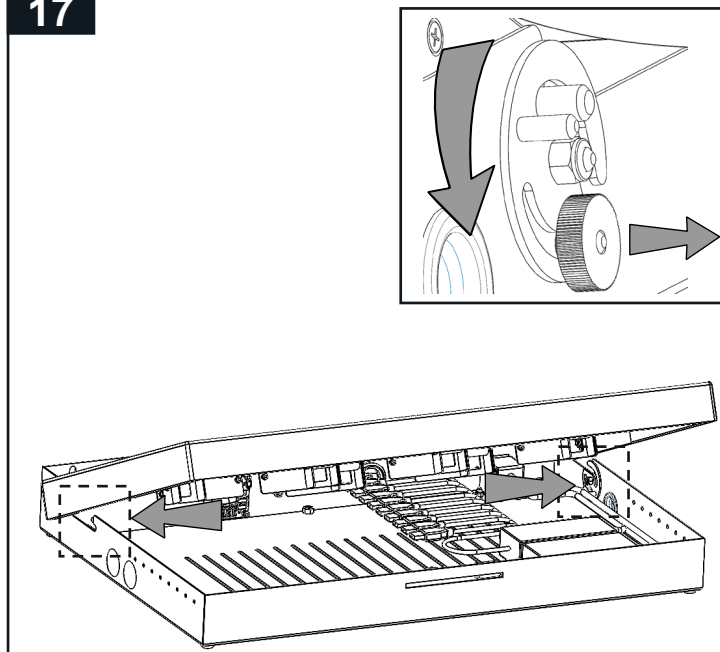

18

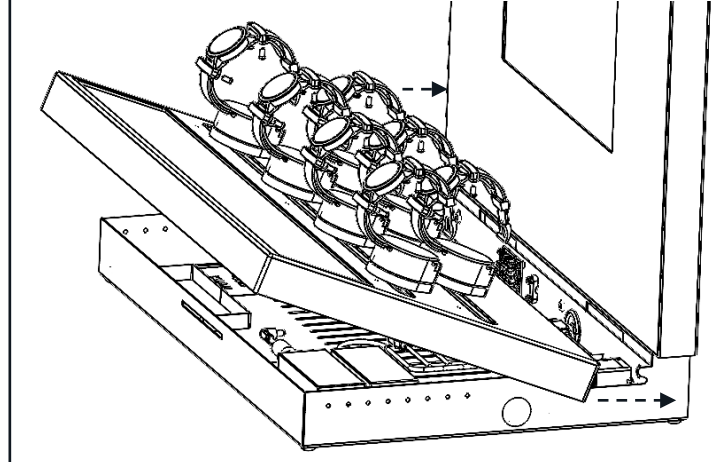

19

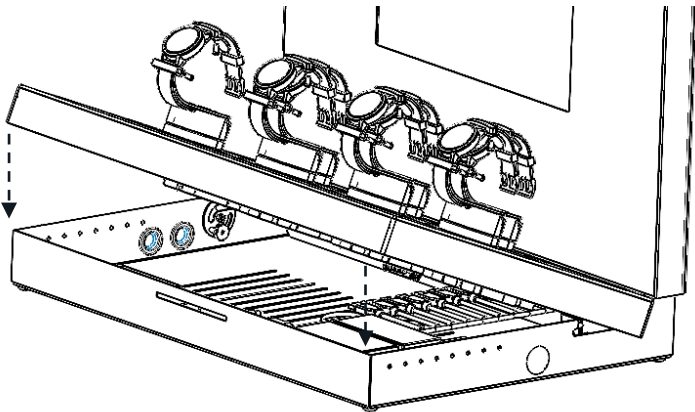

20

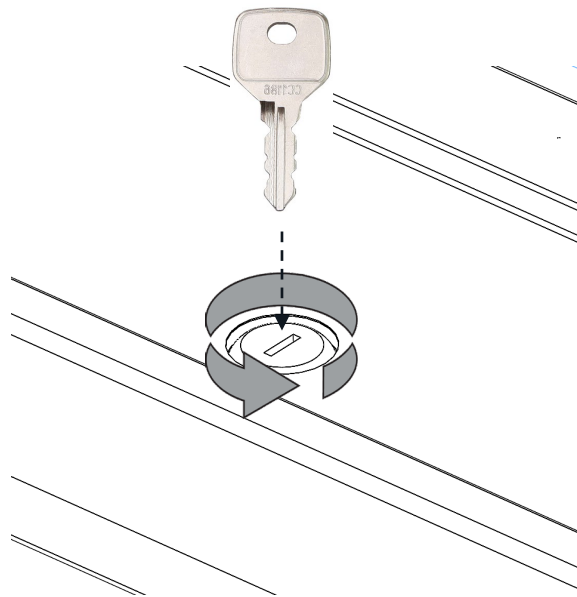

21

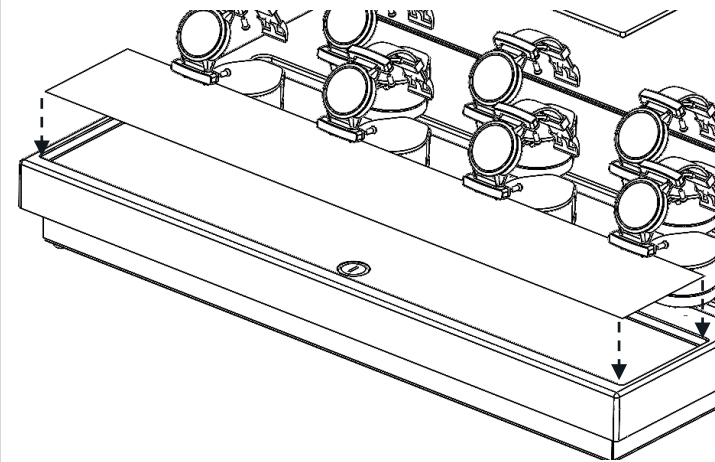

22

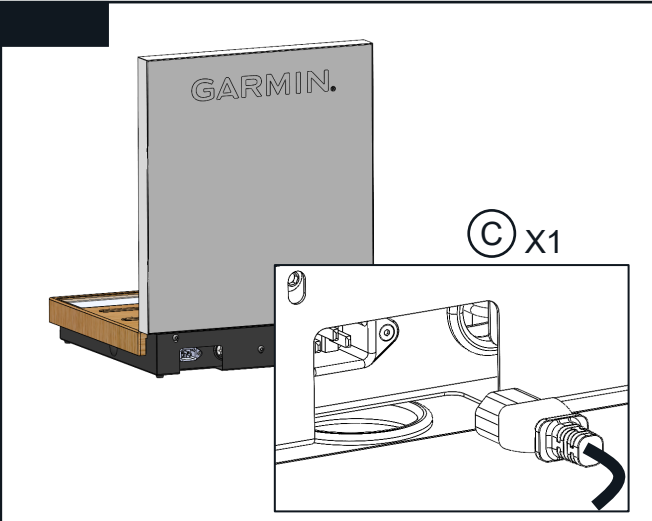
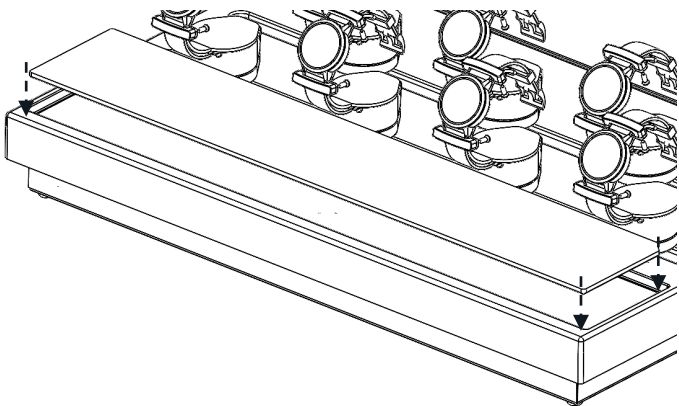

Bronze Security
Fixed posts only
Positions 1-7

