

GARMIN

ACCESSORIES CTU - 600

P12674 | 22/10/2025

ASSEMBLY GUIDE

TOOLS REQUIRED - SUPPLIED



TOOLS REQUIRED - NOT SUPPLIED

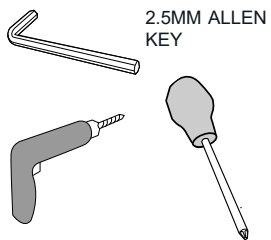

Parts

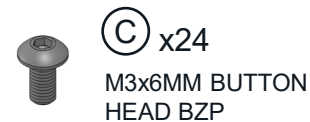
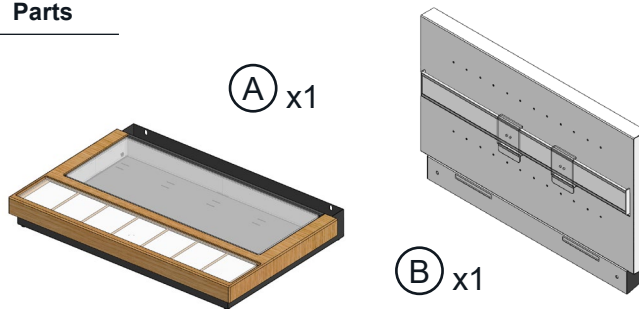

(C) x24

M3x6MM BUTTON HEAD BZP



(E) x5

M6x8MM BUTTON HEAD BLACK

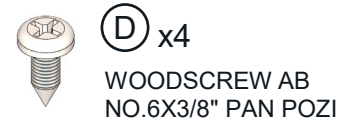

(D) x4

WOODSCREW AB NO.6X3/8" PAN POZI

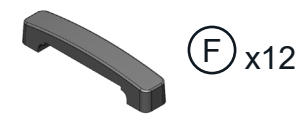

(F) x12

1 SEPARATE WATCH STRAPS FOR MOUNTING TO HEADER



x2 DUMMY WATCH FACE

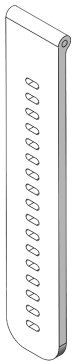

x6

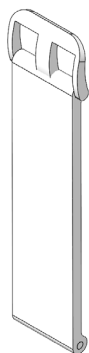

x6

MUST USE DUMMY WATCH - DO NOT DRILL LIVE PRODUCT

2 BEFORE STARTING ASSEMBLY, ENSURE PRODUCT GOING INSIDE BASE IS TIGHTNED TO APPROPRIATE WIDTH WHEN LAID FLAT.

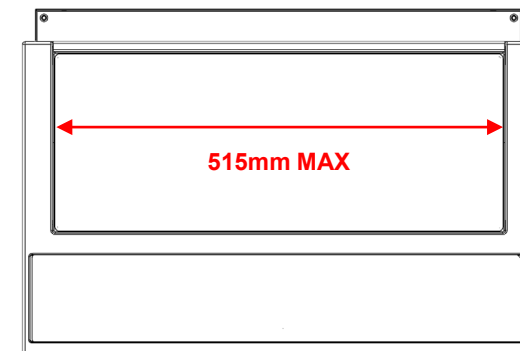
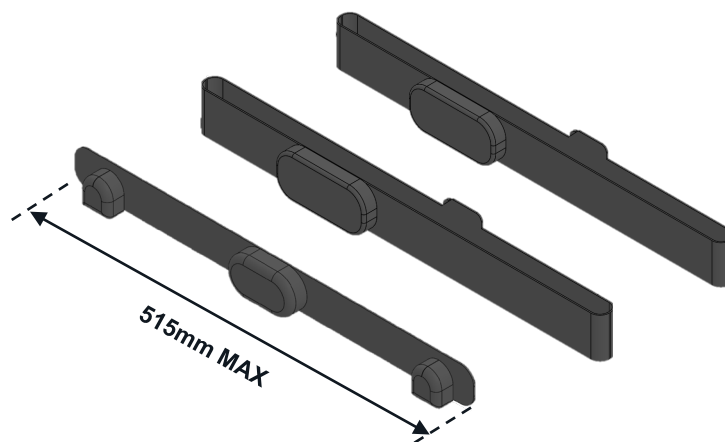

3

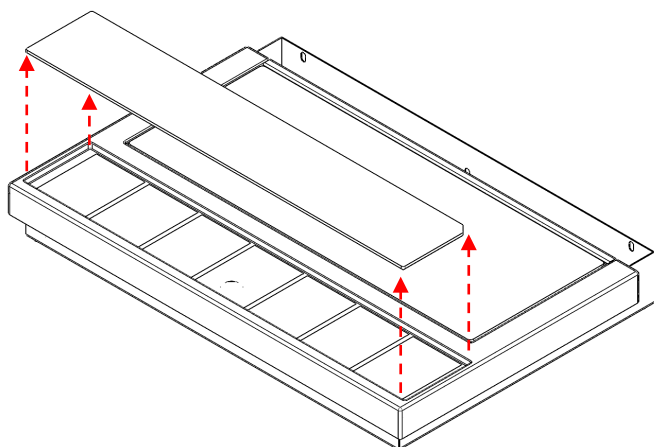

4

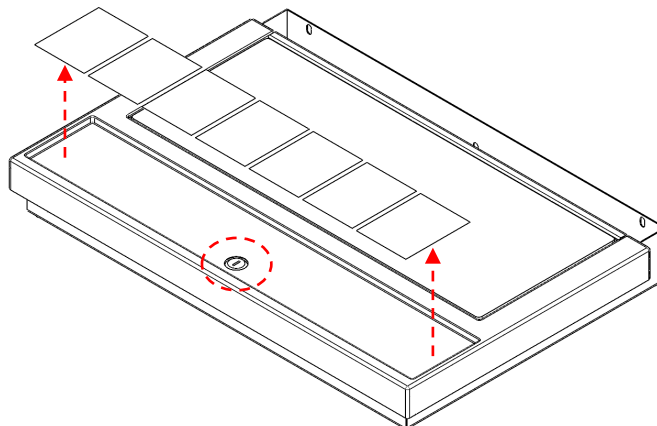

5

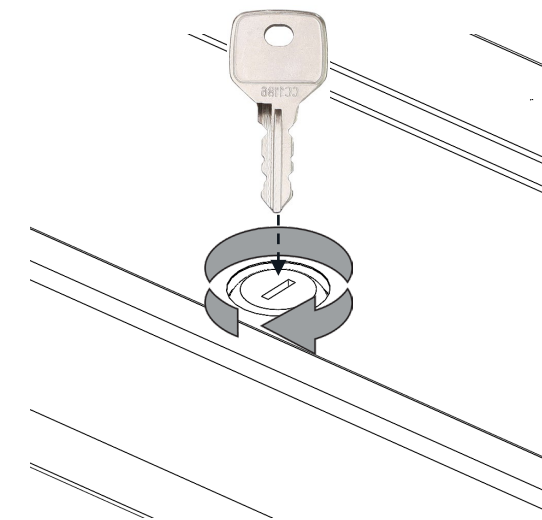

6

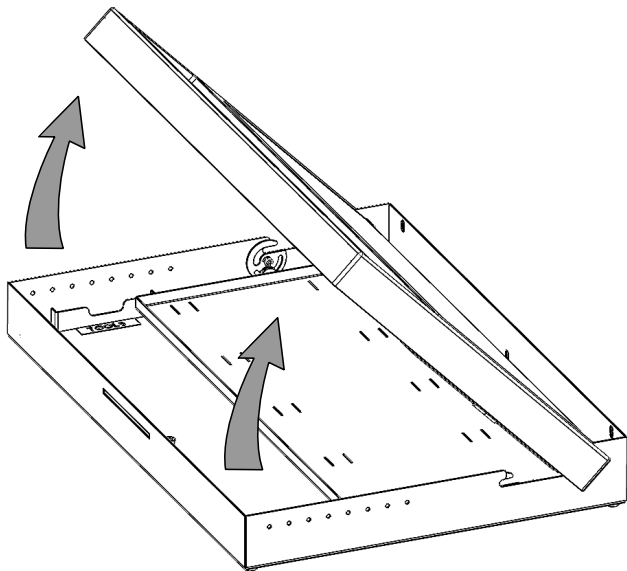

7

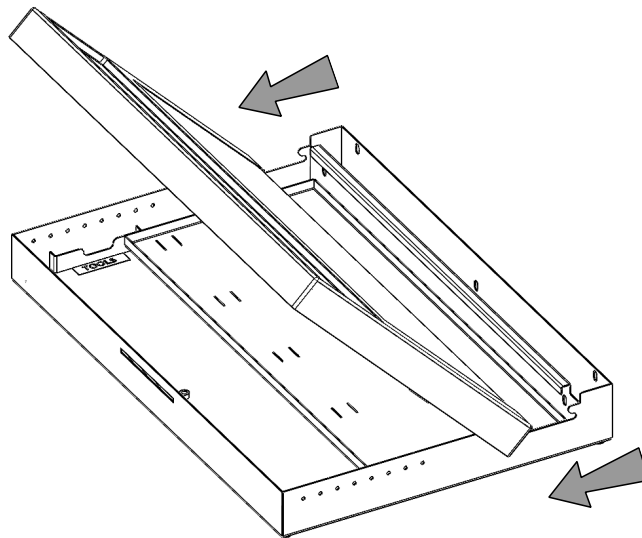

8



MUST TWIST LOCKING PLATES
TO HOLD TOP SURFACE IN
POSITION
(REPEAT BOTH SIDES)

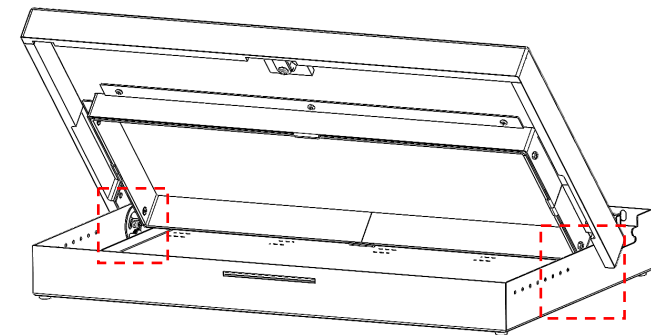
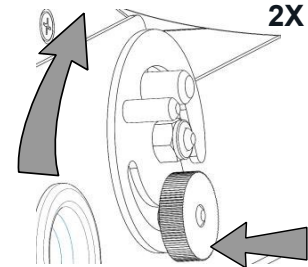

9



RED SUPPORT ARM MUST BE
SWUNG INTO POSITION TO
SUPPORT TOP PLATE

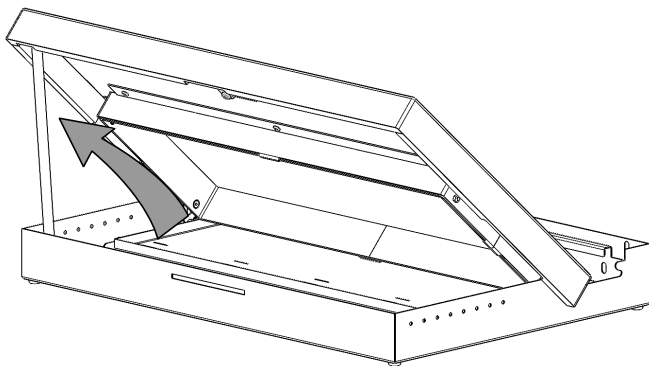

10

(B) x1

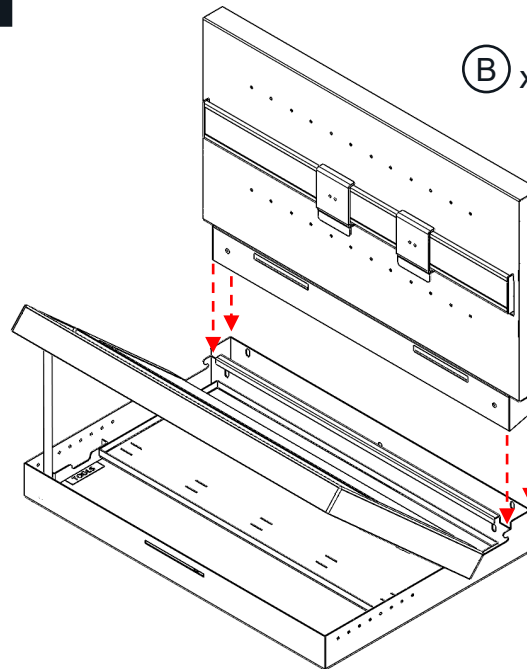

11

(E) x2

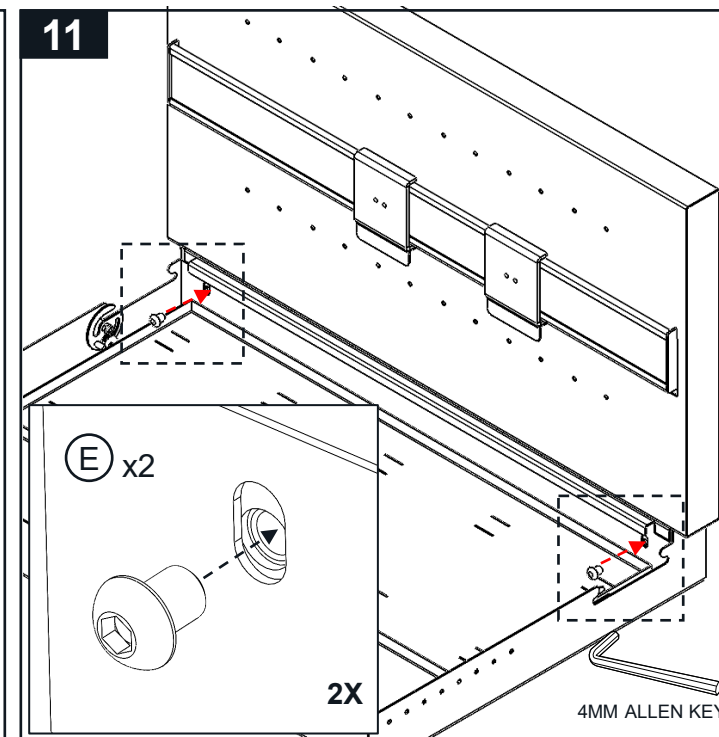

4MM ALLEN KEY

GARMIN

12

4MM ALLEN KEY

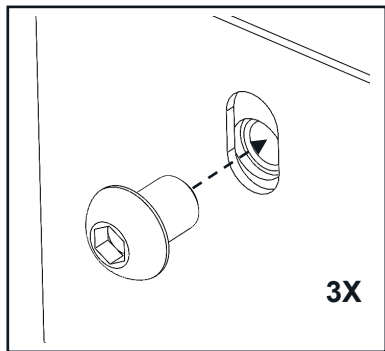

(E) x3

13

ADDING STRAPS TO HEADER

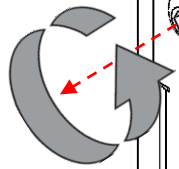

4MM ALLEN KEY

14

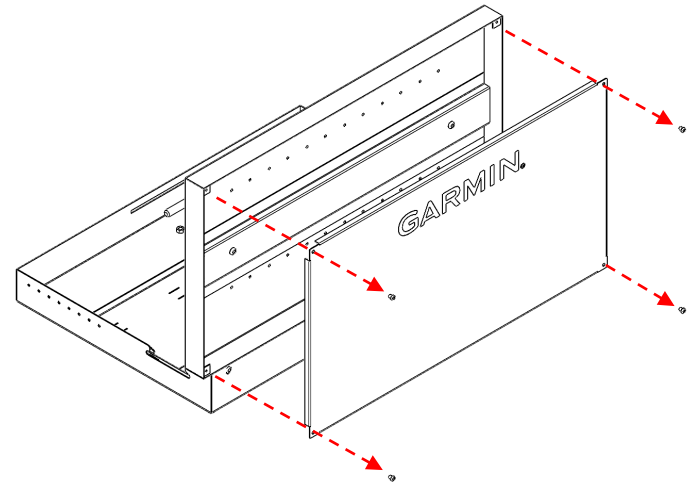

15

(F) x1

16

(C) x2

2.5MM ALLEN KEY

17

ENSURE SUFFICIENT SPACE BETWEEN STRAP AND SLIDER.

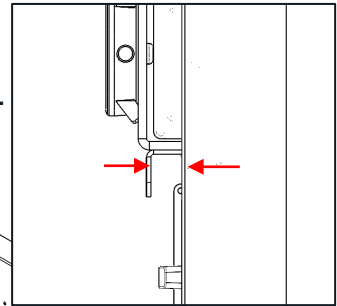

18 REPEAT x11 FOR OTHER WATCH STRAPS. THE CLASP OF STRAP SHOULD ALWAYS BE TOWARDS THE TOP OF THE HEADER.

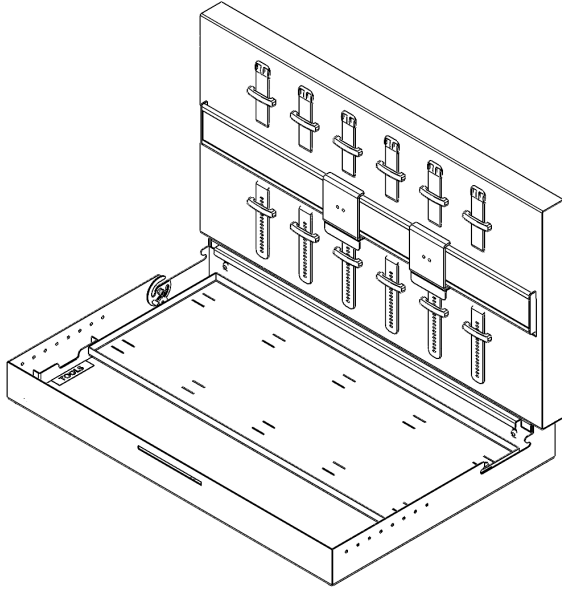

19 ENSURE STRAPS ARE LEVEL.

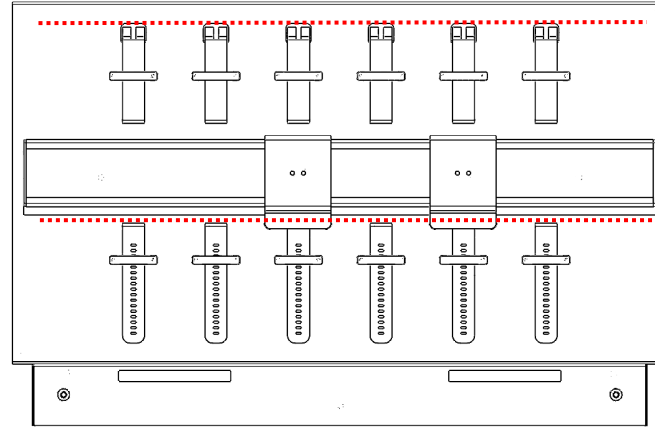

20 ADDING DUMMY FACE TO SLIDER

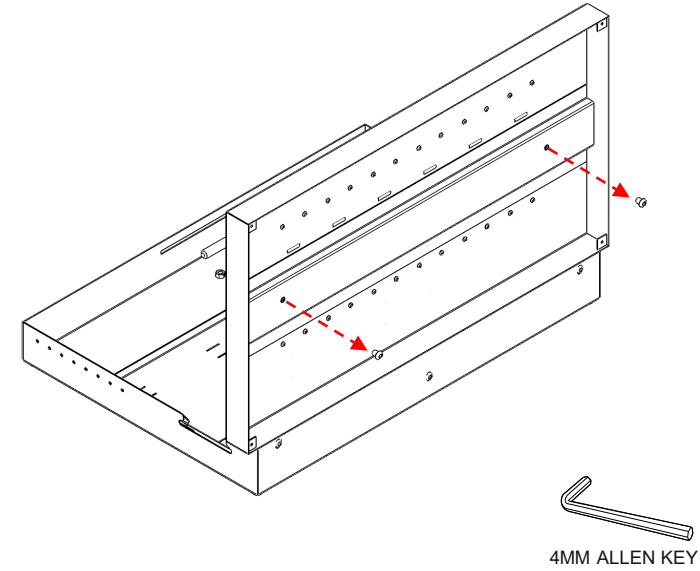

4MM ALLEN KEY

21

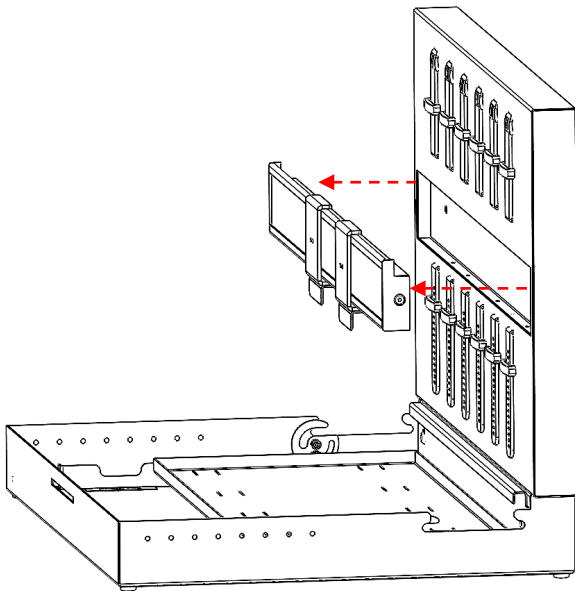

22

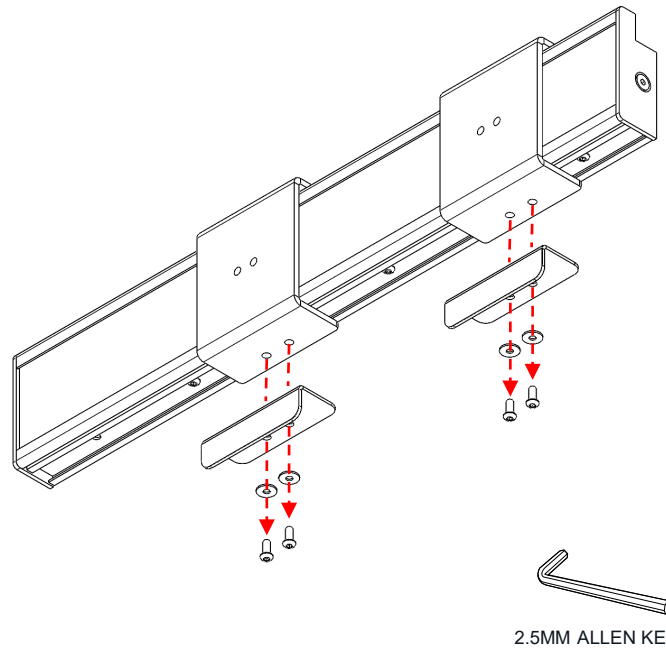

2.5MM ALLEN KEY

23

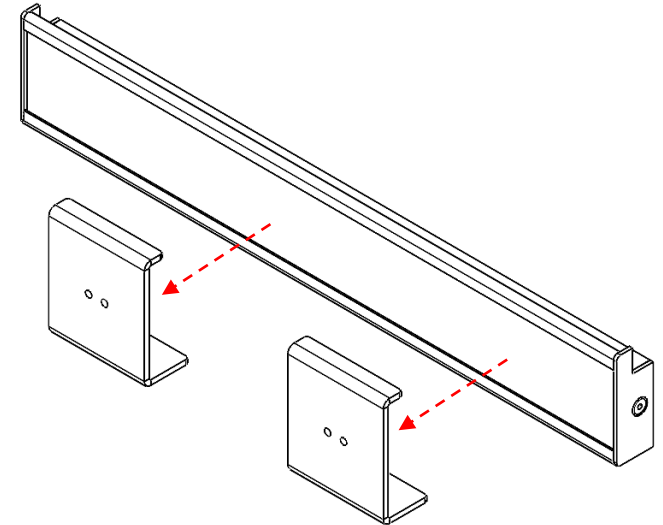

24

DRILL PILOT HOLES IN REAR OF WATCH.
DO NOT DRILL THROUGH ALL – KEEP
FRONT WATCH FACE UNTOUCHED.
CENTRE WATCH ON SLIDER.

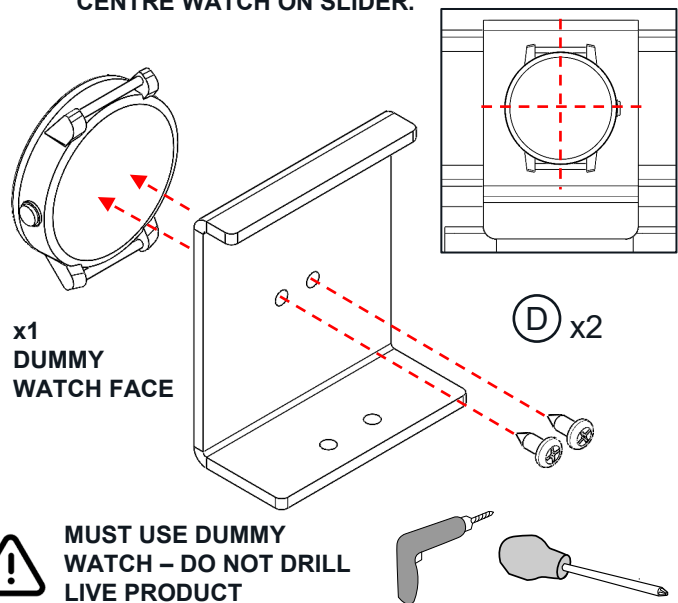

25

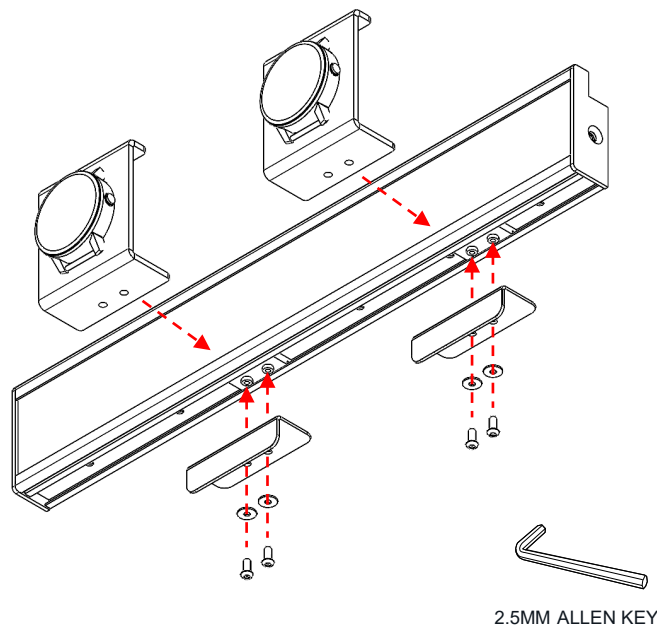

26

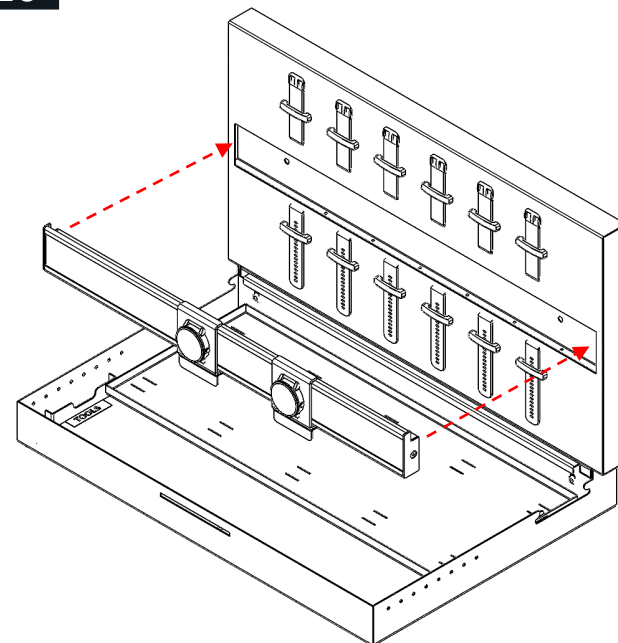

27

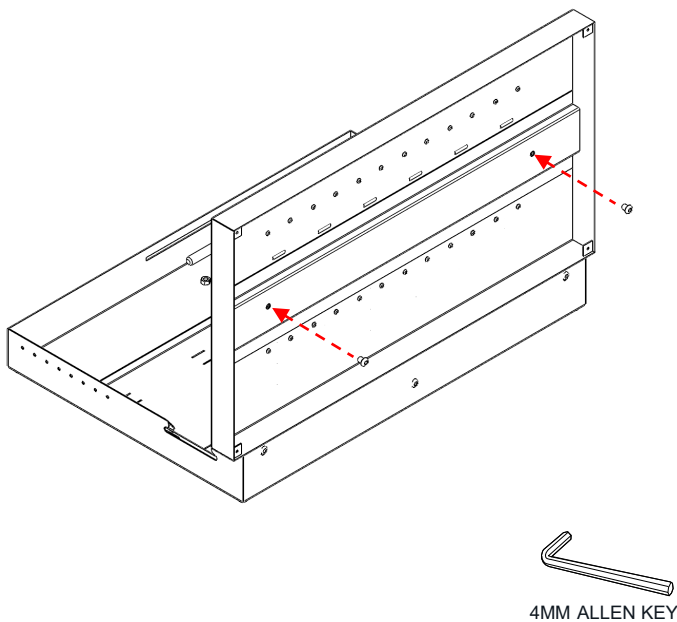

28

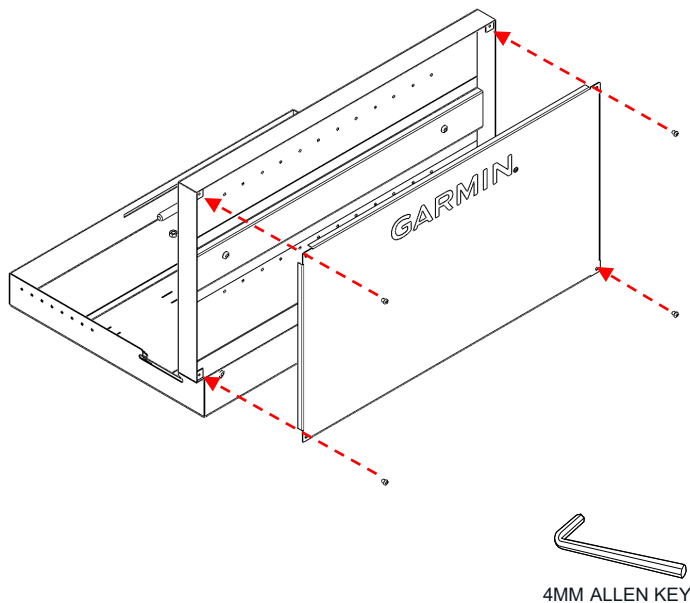

29

CHECK BOTH SLIDERS CAN MOVE FREELY AND ALL STRAPS ARE SECURED IN PLACE.

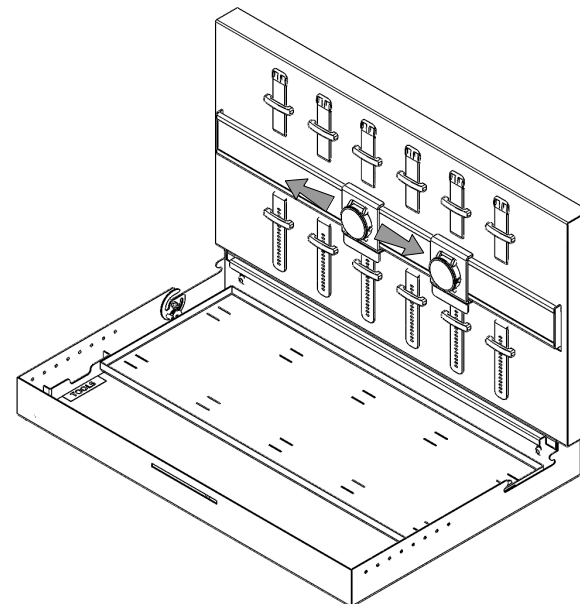

30 ADDING PRODUCT TO BASE TRAY

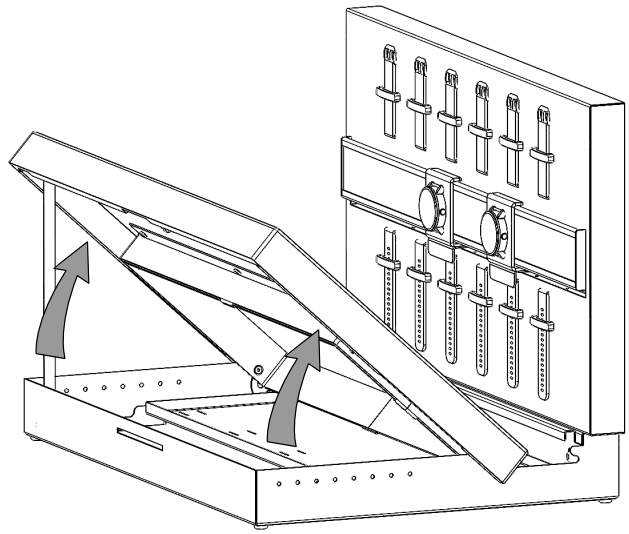

31

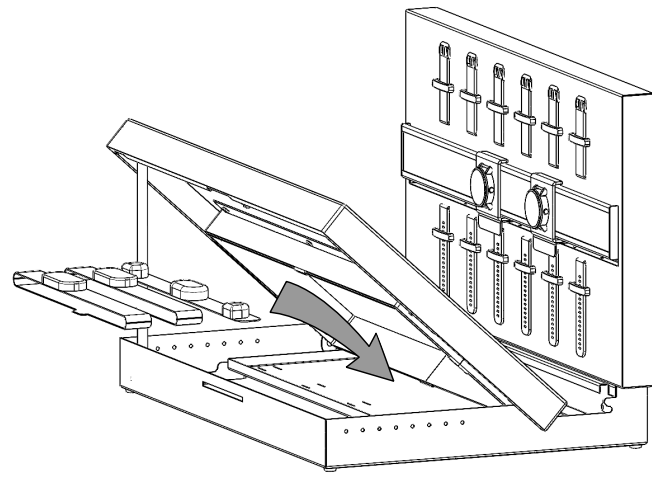

32

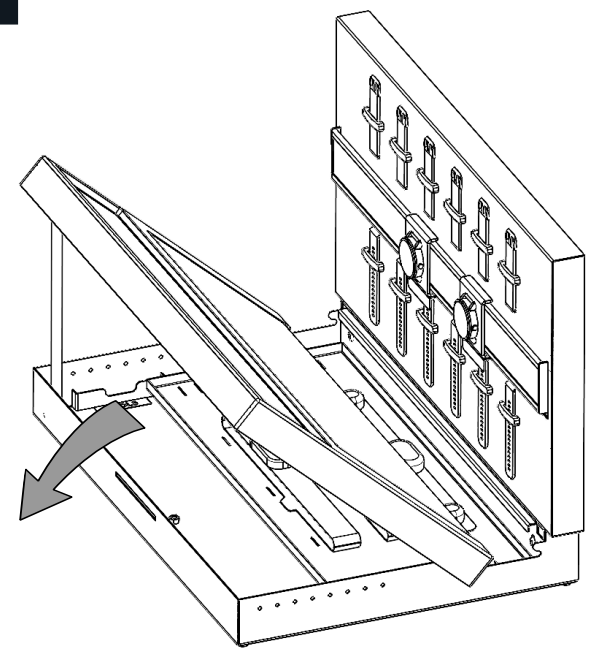

33

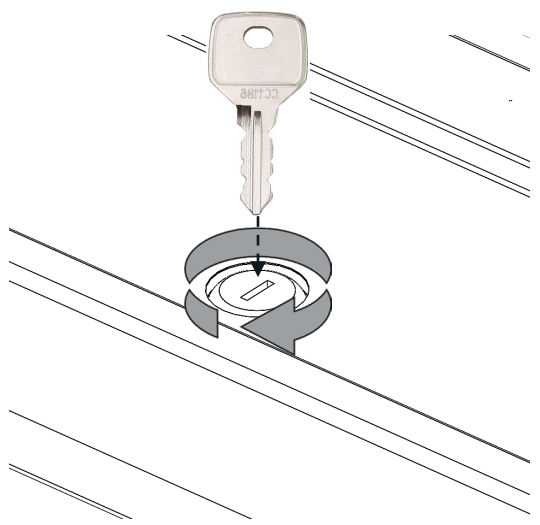

34

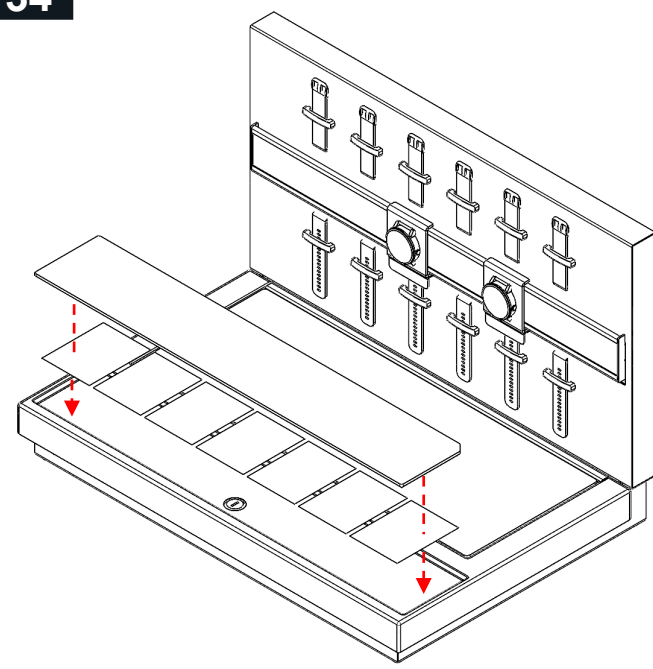

35

