

GARMIN

MID 2 REPLACEMENT PSU
P12674 | 04/11/2025

ASSEMBLY GUIDE

TOOLS REQUIRED – NOT SUPPLIED

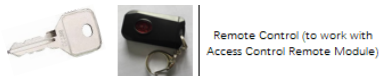

Parts



(A) x1
5V 10A PSU



⌚ 12 minutes

1  BEFORE STARTING, TURN OFF AND UNPLUG THE IEC CABLE FROM THE BACK OF THE UNIT.

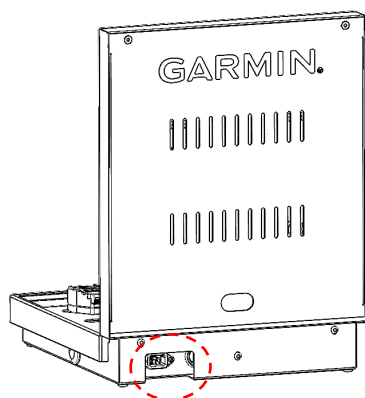

2 LOCATE STORE MANAGER AND ASK FOR ALARM KEY – SHOULD THE ALARM SOUND, POINT THE KEY AT THE RECIEVER ON THE SIDE OF THE UNIT AND CLICK.

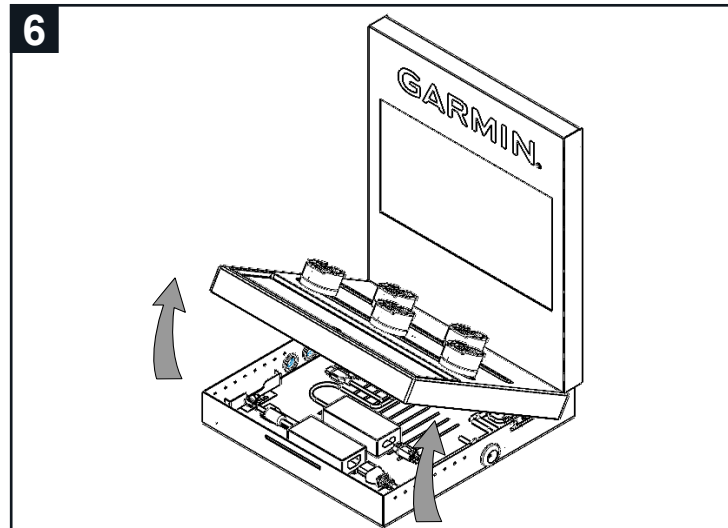
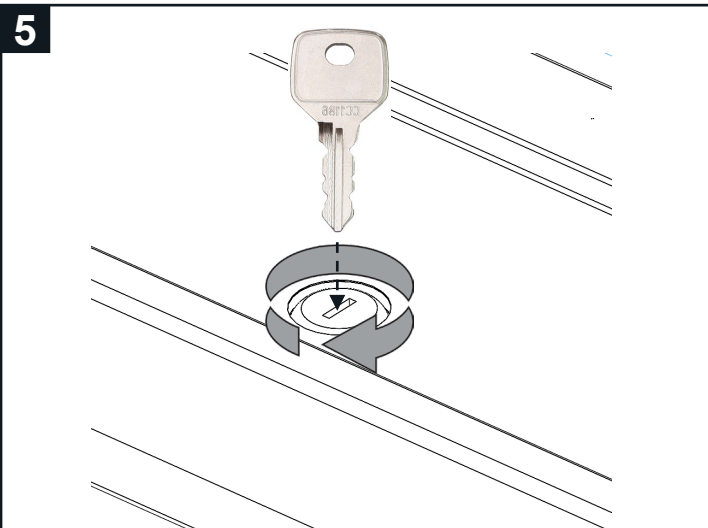
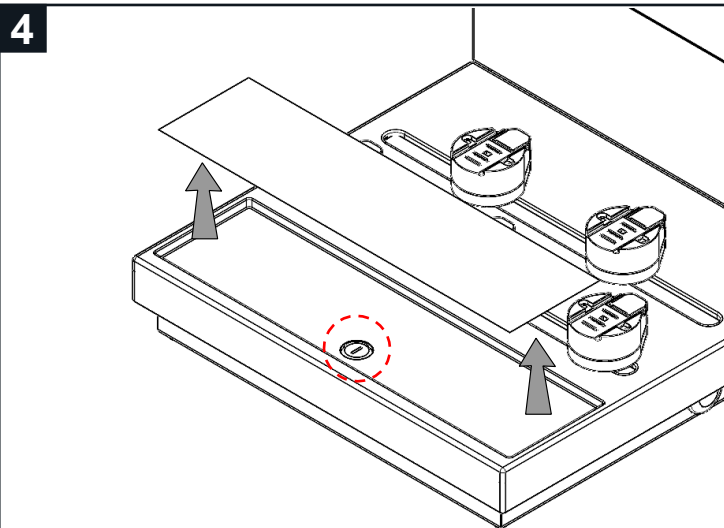
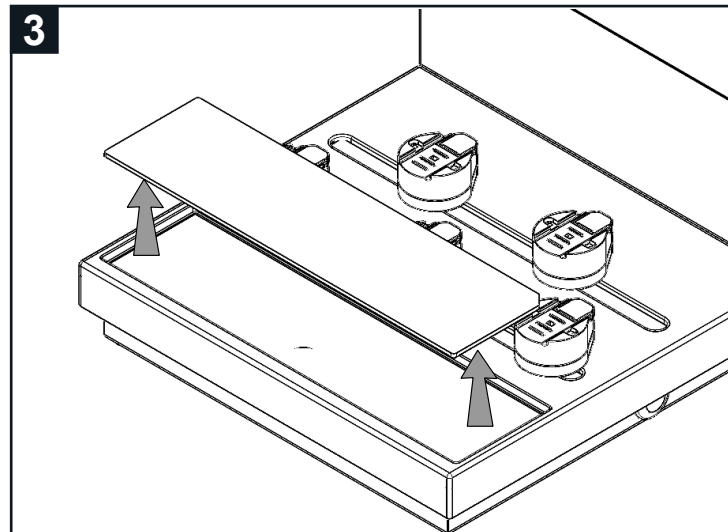
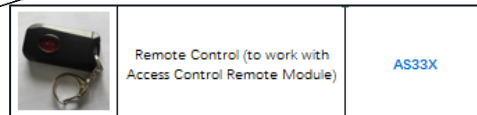
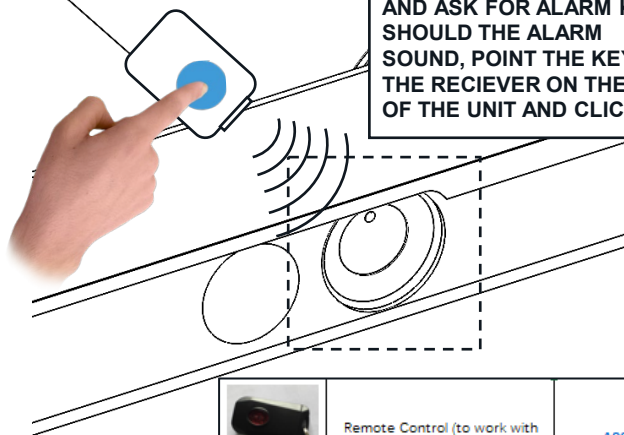

7

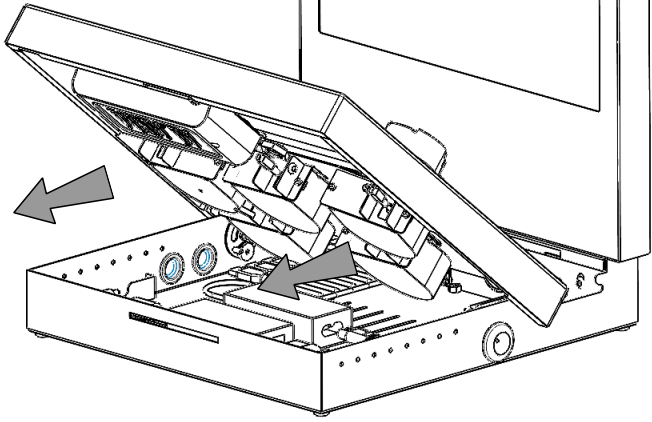

8



MUST TWIST LOCKING PLATES TO HOLD TOP SURFACE IN POSITION (REPEAT BOTH SIDES)

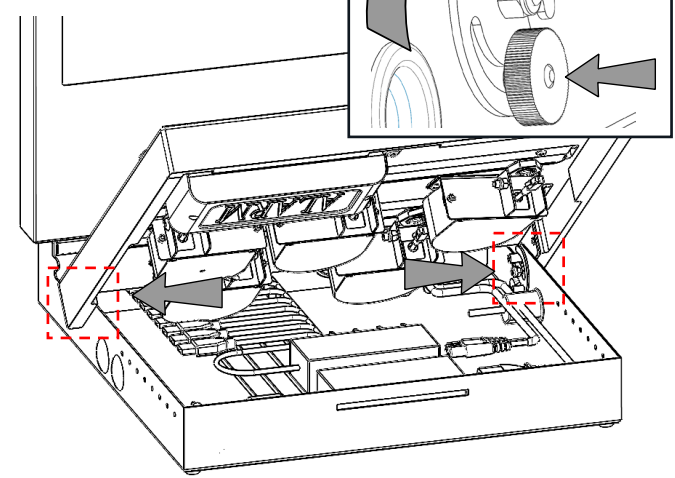

9

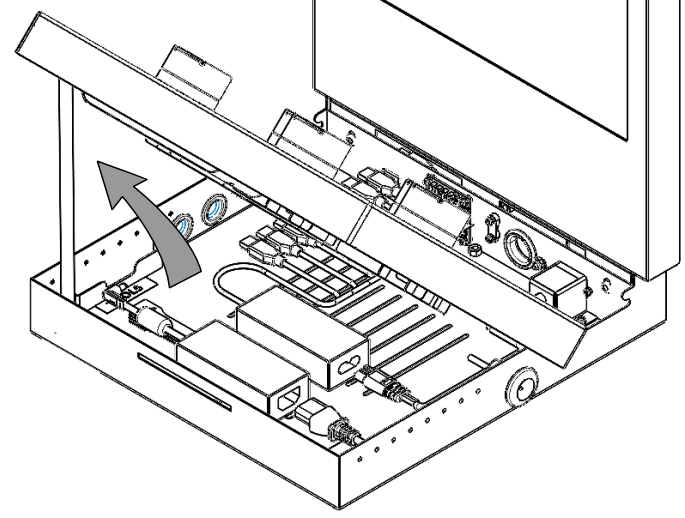

RED SUPPORT ARM MUST BE SWUNG INTO POSITION TO SUPPORT TOP PLATE

10

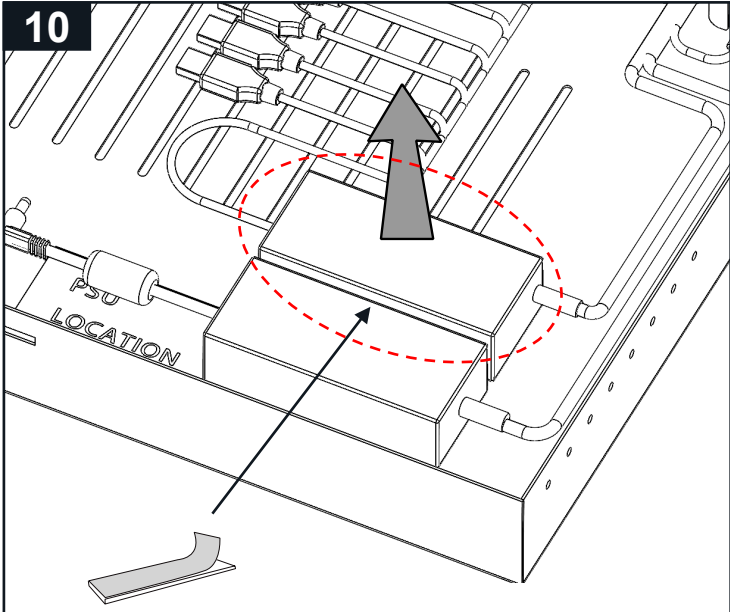

LIFT FAULTY PSU FROM CTU BASE – PSU WILL BE STUCK DOWN WITH TAPE.

11

REMOVE THE IEC C7 PLUG FROM THE PSU

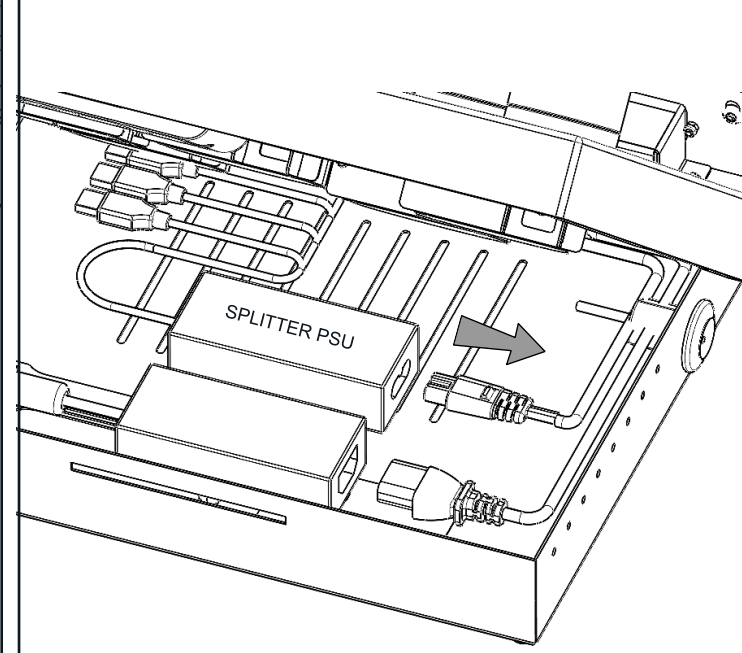

12

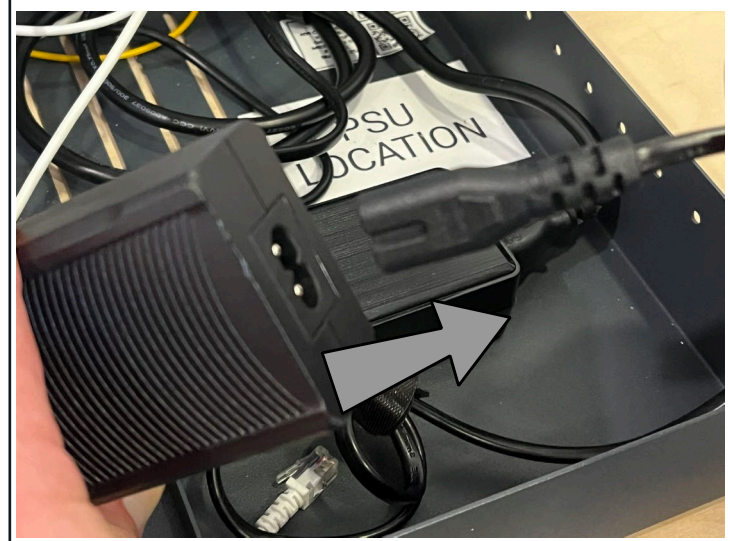

13

KEEP THE USB SPLITTER CABLES PLUGGED IN.

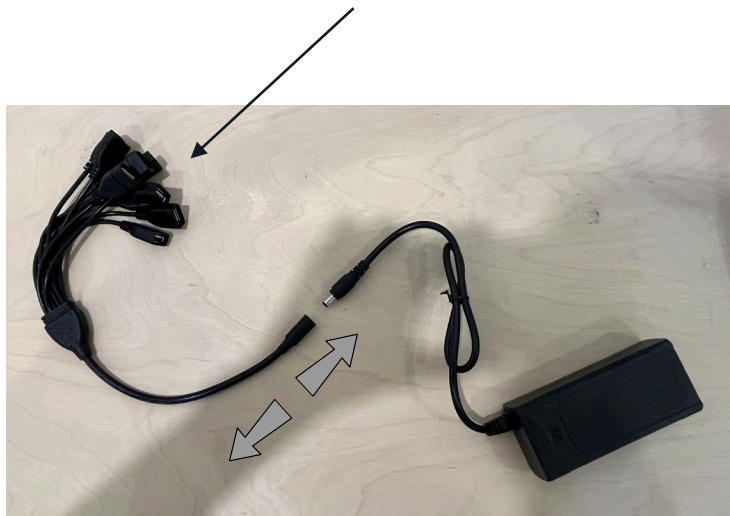

REMOVE THE DC JACK FROM THE USB SPLITTER

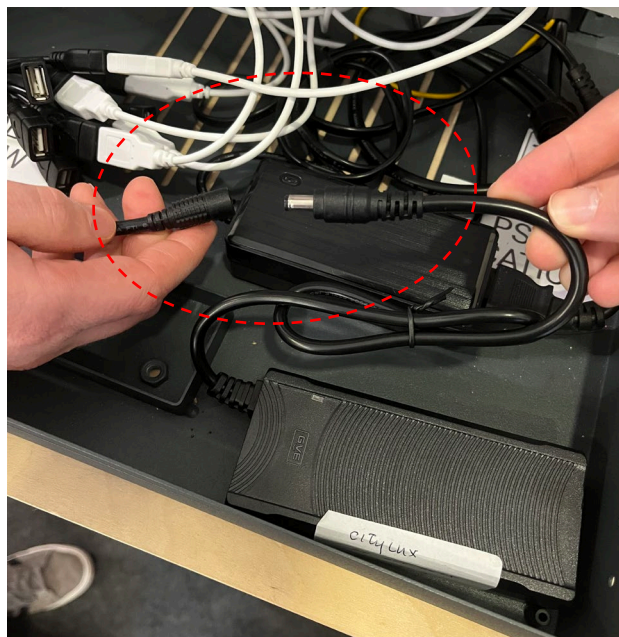

14



SWAP OUT THE OLD PSU FOR THE NEW REPLACEMENT. PLEASE NOTE THE NEW PSU MUST BE RATED AT 5V. IF THE VOLTAGE SHOWN IS INCORRECT, DO NOT INSTALL THE NEW PSU.



(A) x1

15

REPLUG THE C7 IEC PLUG AND SPLITTER DC JACK TO THE NEW PSU



16



BEFORE CONTINUING, CONNECT THE UNIT TO POWER AND TEST EVERY WATCH ON THE UNIT CHARGES.

ALSO CHECK THE ALARM POWERS ON IF APPLICABLE (PLAT SECURITY ONLY).



17

RELOCATE THE NEW PSU INTO POSITION, USING TAPE TO SECURE. ENSURE CABLES ARE TIED UP AND LEFT IN A TIDY STATE.



18

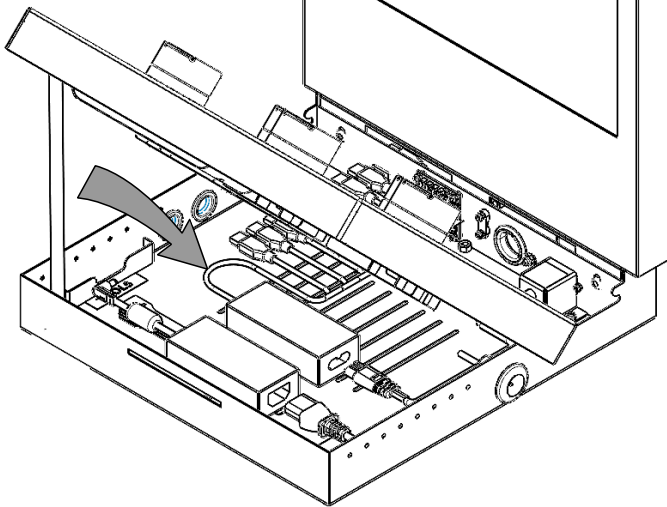

19

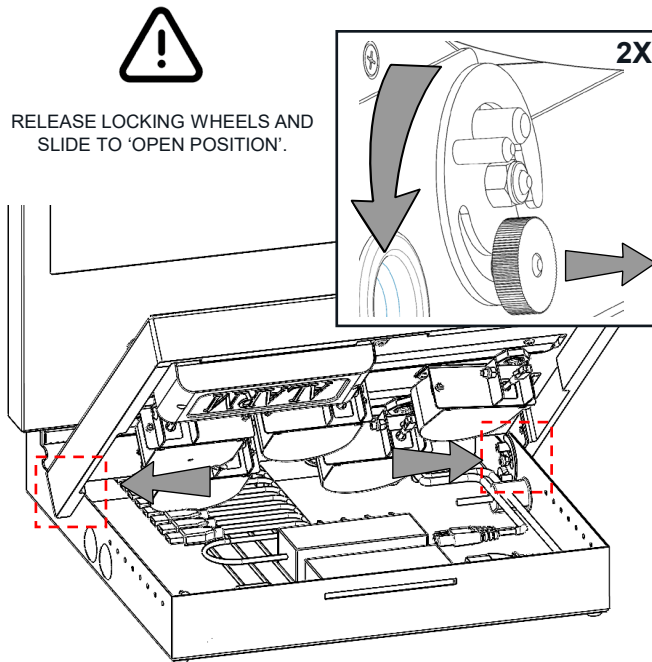

20

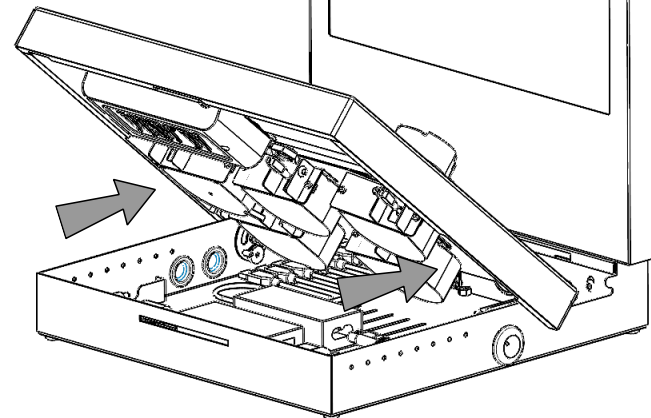

21

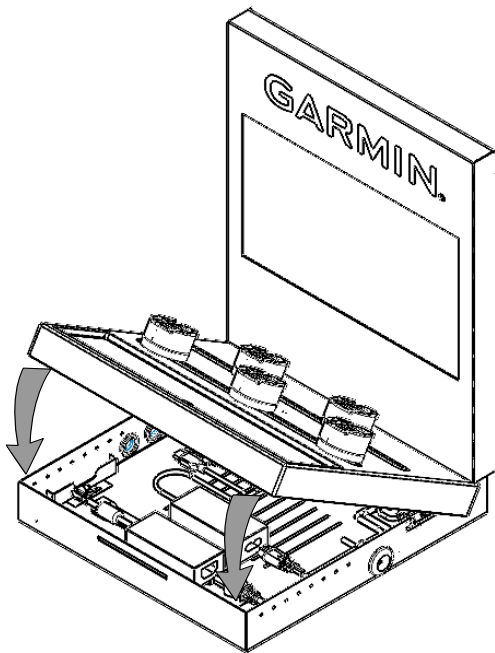

22



23

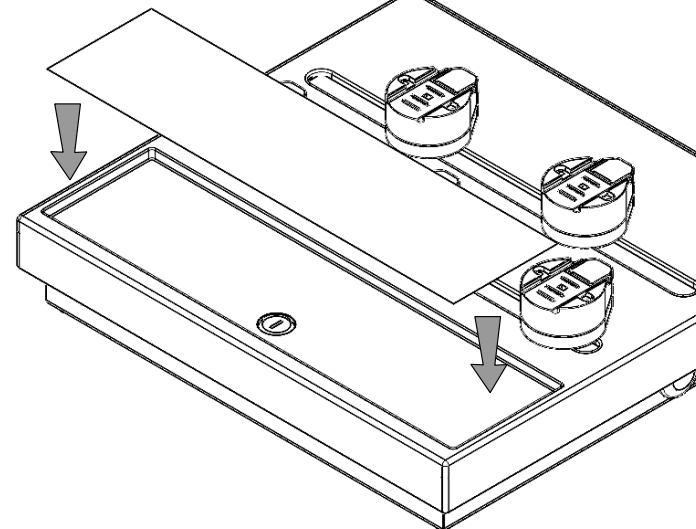

24

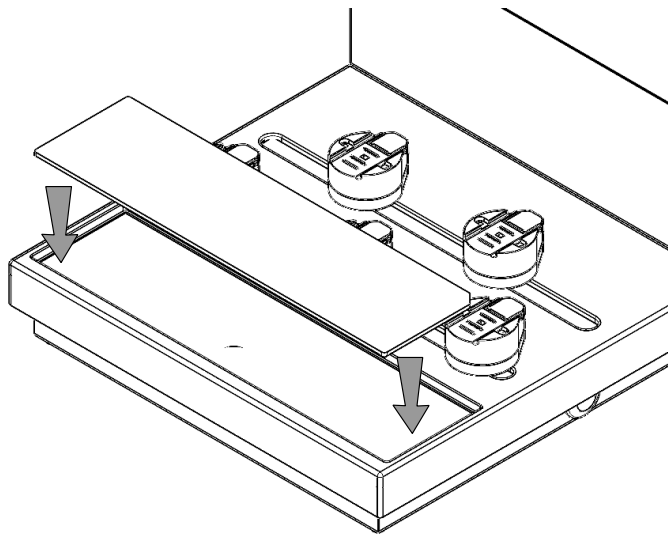

25



PLUG IN IEC SOCKET TO REAR OF UNIT AND POWER ON. CHECK ALL WATCHES CHARGE, ALARM ACTIVATES AND SCREEN TURNS ON.

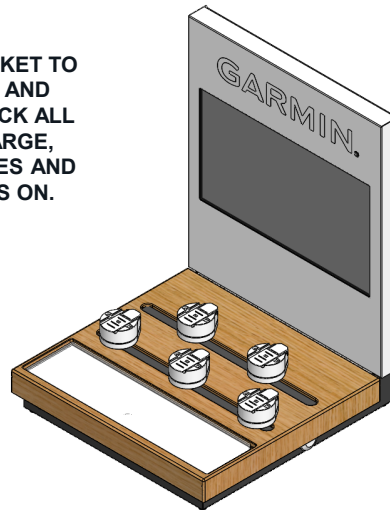

26



DISPOSE THE FAULTY PSU IN ELECTRICAL RECYCLING POINT AND NOT IN GENERAL WASTE

27

28

29