

TOOLS REQUIRED

2.5MM AND 4MM ALLEN KEY

10MM SPANNER

Parts

(A) X1

(B) X1

(C) X1

(D) X2

1

TILT UNIT BACK SLIGHTLY
SO THAT UNIT CAN BE
MOVED INTO POSITION

2

FITTING PRODUCT

4 OFF POS

3

REMOVE FRONT PANEL
SO THAT HOLES CAN BE
MADE FOR PRODUCT
LINE-UP

4

MS-EL602

XS-F65CWB

SG-F77W

SG-S10W

TEMPLATED ON WOODEN
PANEL ARE CUTTER
GUIDES THAT INDICATE
THE AREAS WHERE
SPEAKER CUTOUTS ARE
TO BE MADE

5

150 mm

136.0 mm (5.35")

Signature Series
6.5" Speakers

FUSION®

ADDITIONAL TEMPLATES
CAN USUALLY ALSO BE
FOUND WITHIN THE
PRODUCT BOXES

6

150 mm

Signature Series
6.5" Speakers

FUSION®

MADE SURE ALL THE
CUTOUTS REQUIRED
ARE DONE AT THIS
STAGE. SPACING OUT
USING THE LOCATION
TEMPLATE PROVIDED

© Confidential Intellectual Property of Garmin Ltd. | Page 1

GARMIN®

7

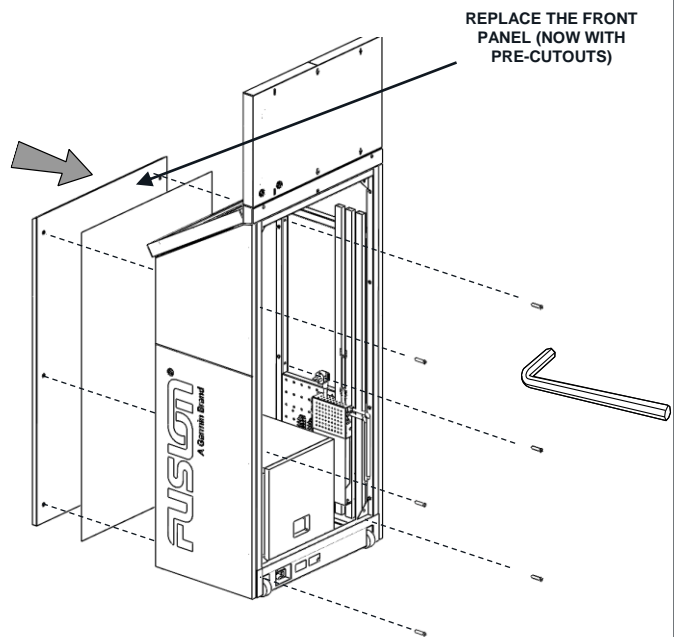

8

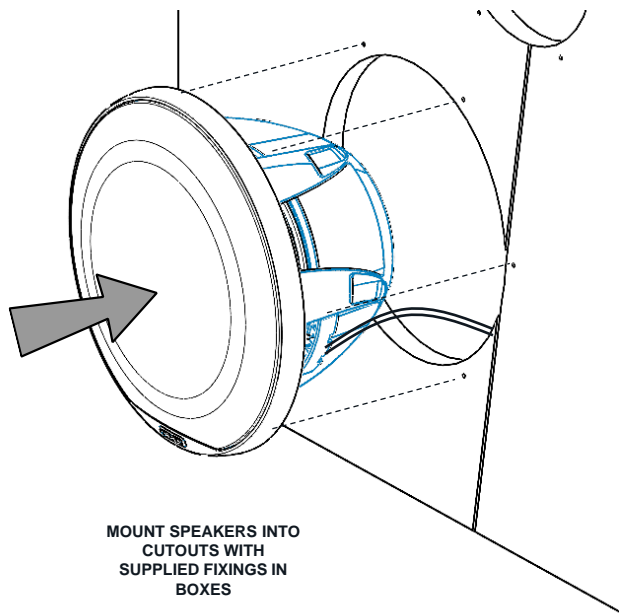

9

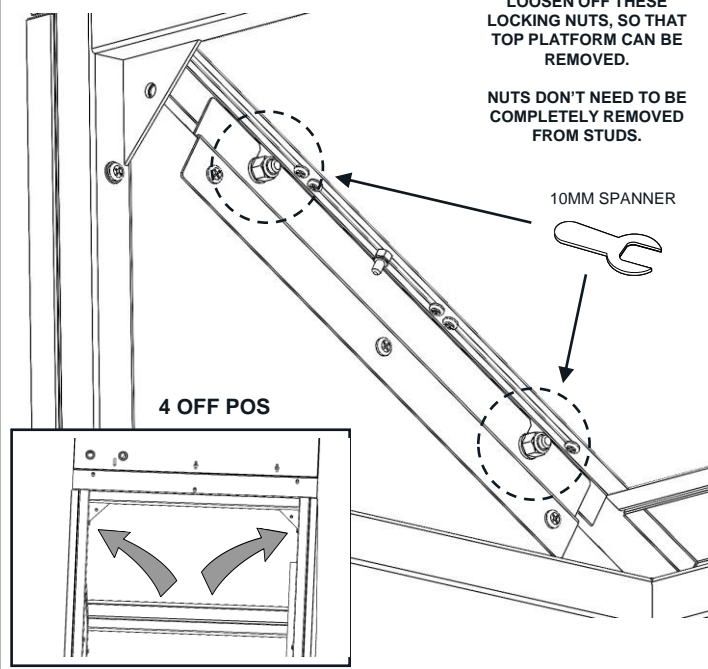

10

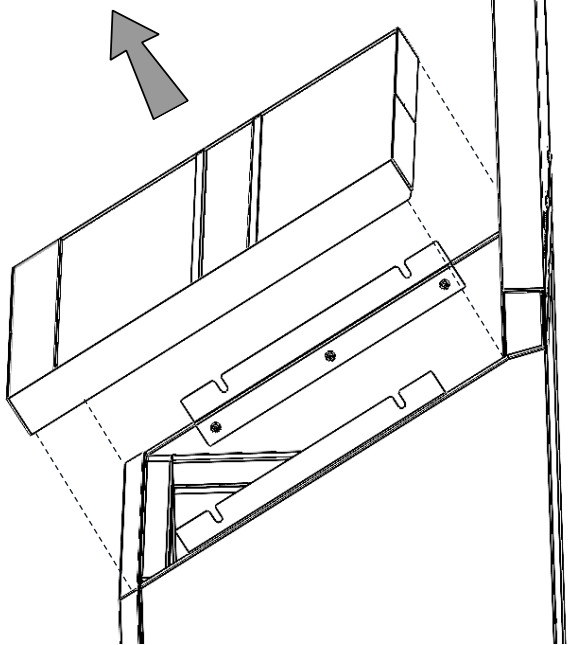

11

TEMPLATED ON WOODEN PANEL ARE CUTTER GUIDES THAT INDICATE THE AREAS WHERE SPEAKER CUTOUTS ARE TO BE MADE

- CUT LINES FOR SECOND TICKET RETAINER
- MS-RA770
- MS-RA670
- MS-RA60
- MS-ERX400

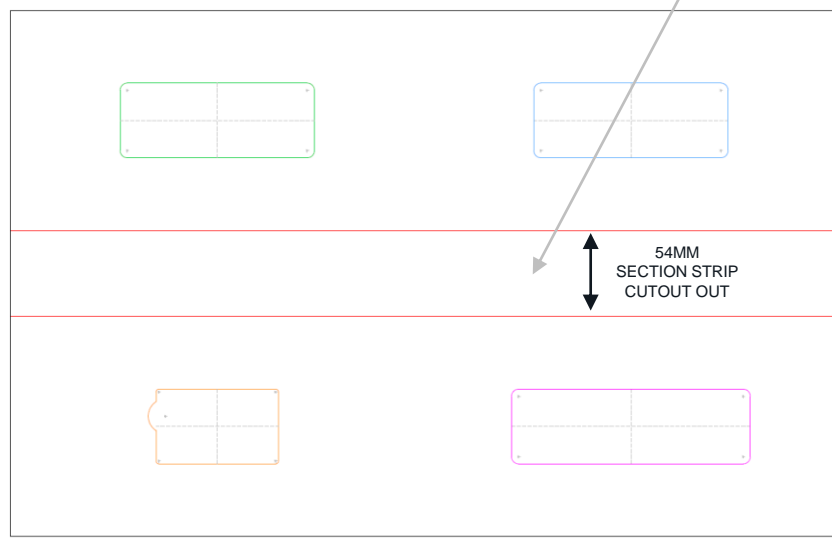

THE 2 TIER LAYOUT REQUIRES THE REMOVAL OF A 53MM STRIP TO CREATE SLOT FOR THE PART D TICKET STRIP TRAY. THIS 53MM STRIP CAN BE CUT ALONG ANY POSITION TO ENSURE THAT THE SPACING IS CORRECT RELATIVE TO THE PRODUCTS CHOSEN

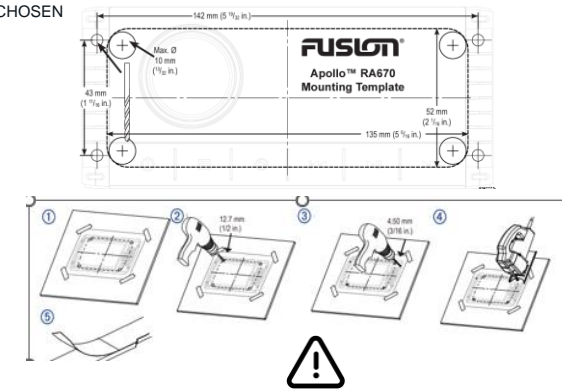

BEFORE CUTTING ANY HOLES FOR PRODUCT THE TEMPLATES FOR PRODUCTS MUST BE PRINTED OUT TO SCALE ON PAPER AND PLACED ONTO PART C BLANK PLATE TO ENSURE CHOSEN LINE-UP ISN'T TOO LARGE FOR 2 TIER LAYOUT.

12

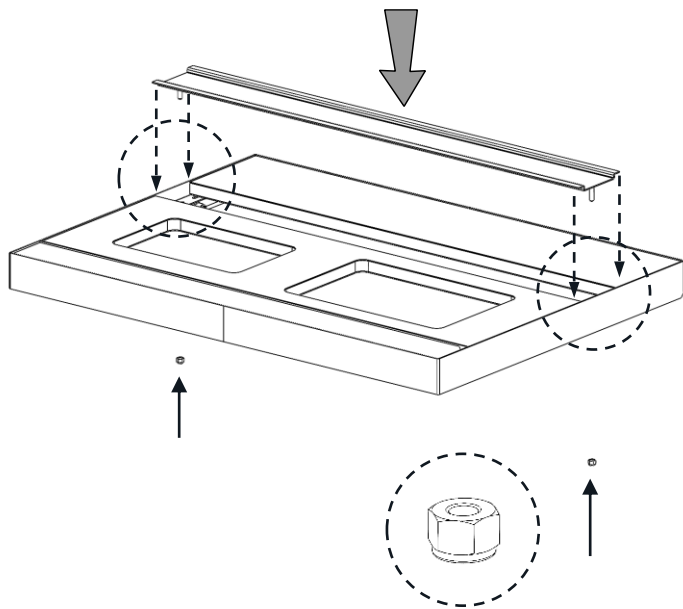

13

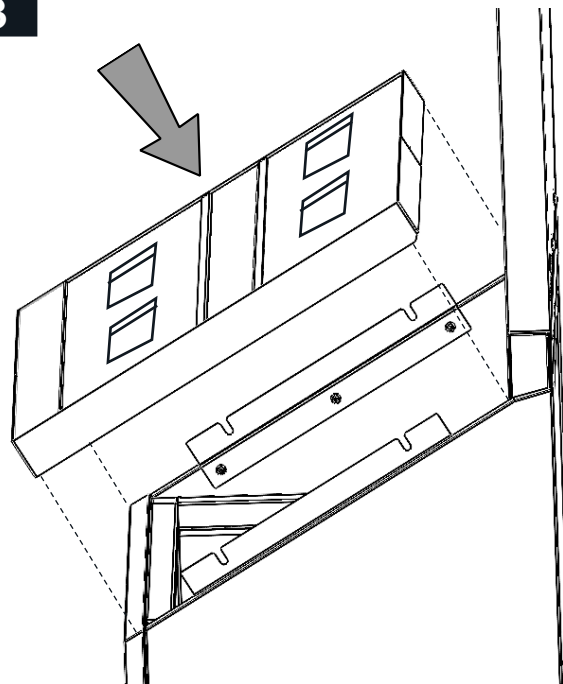

14

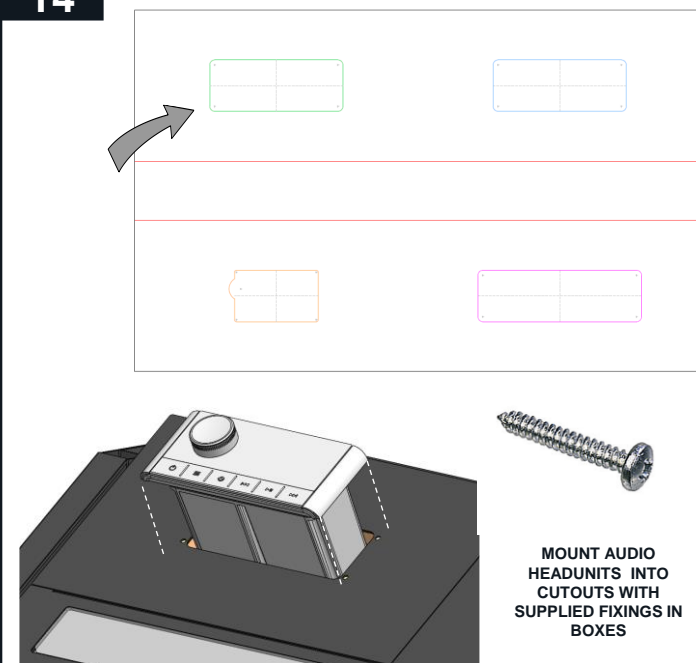

15

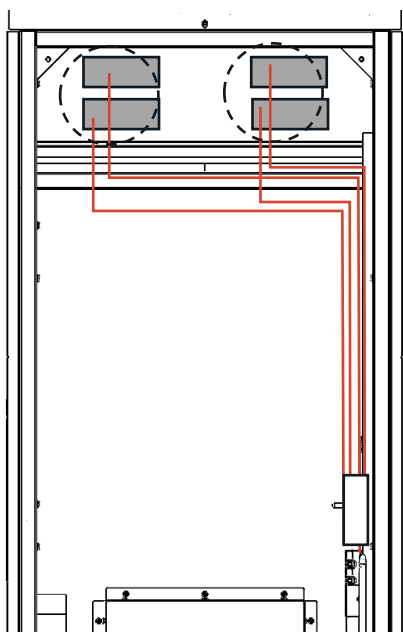

OUT OF THE BACK OF THE HEAD UNIT ARE MULTIPLE CABLES. TO POWER THE UNIT PLEASE LOOK FOR:
RED POSITIVE CABLE
BLACK NEGATIVE CABLE
 ON SOME OF THE UNITS THERE IS ALSO A **YELLOW IGNITION CABLE** WHICH NEED TO BE CRIMPED WITH THE RED CABLE.

JOIN THE ENDS WITH BUTT SPINE CONNECTORS. JOINING INTO THE 2 CORE CABLE CREATED.



THE SUPPLIED 6M 16 AWG TO CORE CABLE /BLACK AND RED. CUT LENGTH 1.5M 60FF LENGHTS

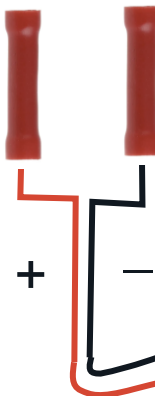
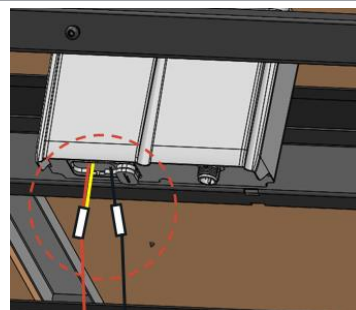

17

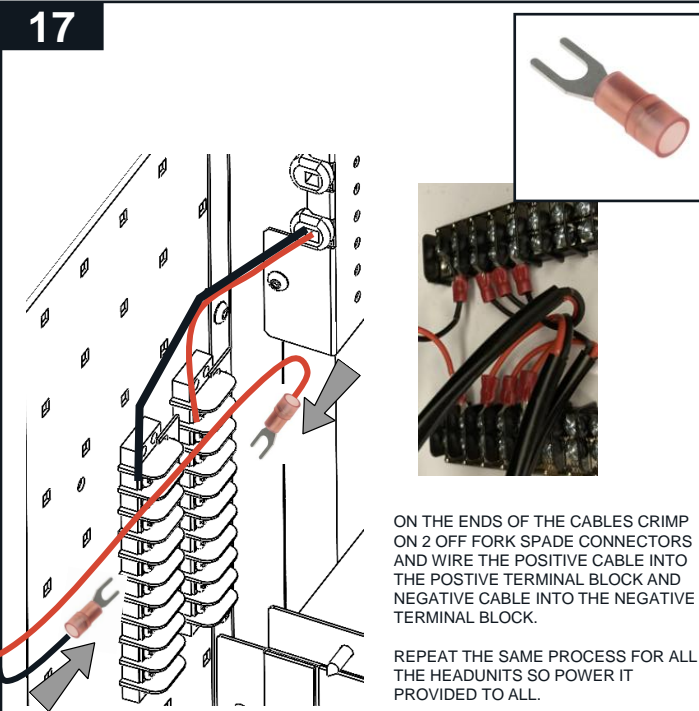

ON THE ENDS OF THE CABLES CRIMP ON 2 OFF FORK SPADE CONNECTORS AND WIRE THE POSITIVE CABLE INTO THE POSTIVE TERMINAL BLOCK AND NEGATIVE CABLE INTO THE NEGATIVE TERMINAL BLOCK.

REPEAT THE SAME PROCESS FOR ALL THE HEADUNITS SO POWER IT PROVIDED TO ALL.

GARMIN

15

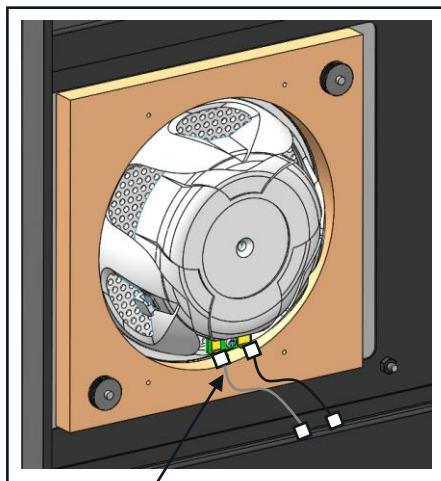

ON THE BACK OF EACH SPEAKER IS A SHORT POSITIVE AND NEGATIVE CABLE LOOM WITH SPADE CONNECTORS

16

POSITIVE
WHITE

NEGATIVE
BLACK/WHITE



17

USE 4 OFF CORE CABLE LOOMS 1.5M LENGTH.

16 AWG 2 CORE CABLE

ALREADY FITTED WITH SPADE CONNECTORS CRIMPED ON TO SUIT SPADE TERMINALS ON SPEAKERS.

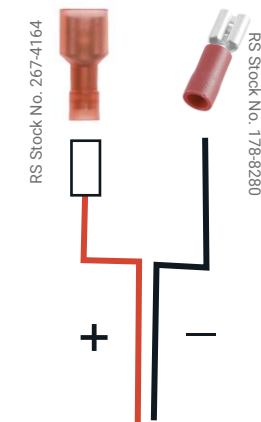
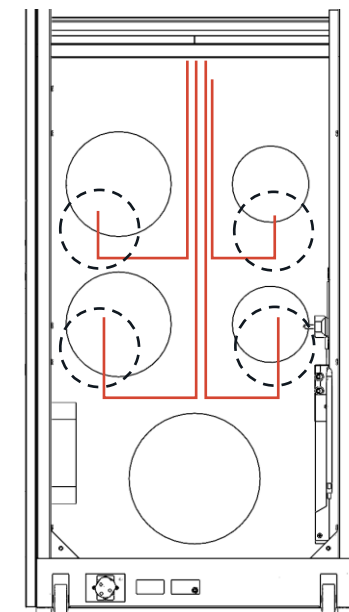

18

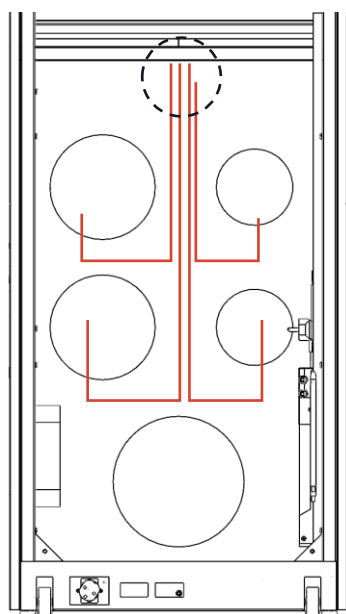

AT THE OTHER END BUTT SPLINE CONNECTORS NEED TO BE FITTED SO THAT THEN CAN BE CRIMPED ONTO THE CABLES COMING OUT OF THE AUDIO HEAD UNITS AT A LATER DATE.

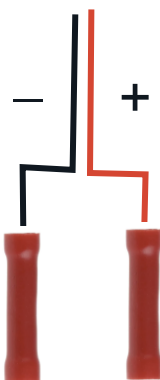

19



EACH PAIR OF SPEAKERS NEED TO BE WIRED INTO THE BACK OF THE HEAD UNIT.

WIRING THE LEFT SPEAKERS LOOM INTO ZONE 1 LEFT SPEAKER, AS LABELED ON THE TAGS ON THE REAR CABLE LOOMS AND THE SAME PROCESS FOR ZONE 1 RIGHT SPEAKER.

MAKE SURE POLARITIES ARE CORRECT.

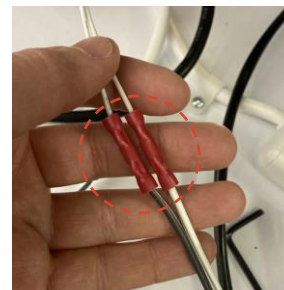

20

CONNECTING AMP

FIT AMP TO INSIDE RH FACE OF GEAR TRAY WITH FIXINGS FOR SMALLER AMPS HOLES WILL NEED TO BE DRILLED SO THAT SUPPLIED FIXINGS MOUNT TO GEAR TRAY

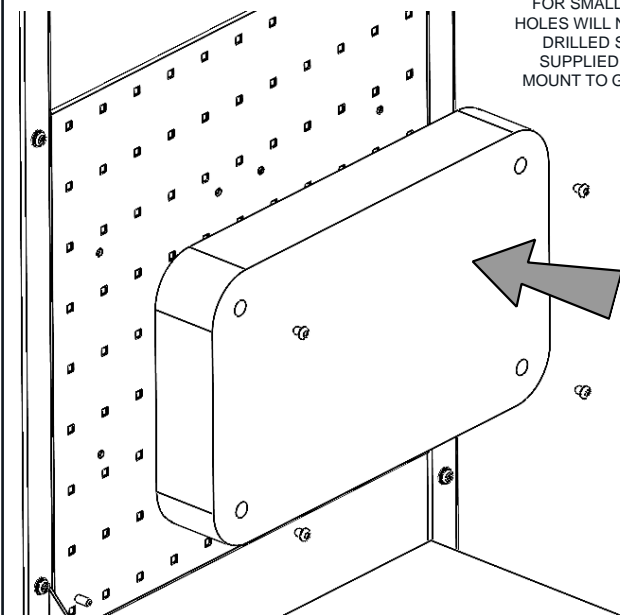

GARMIN®

21

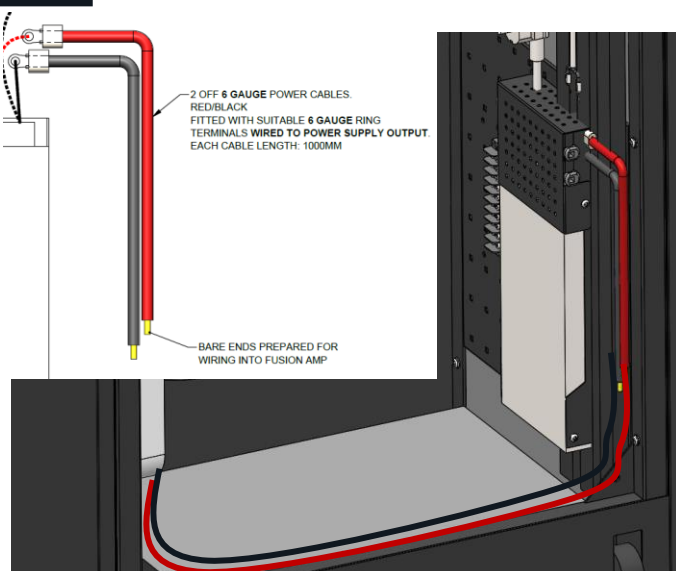

FEED ACROSS LARGE THICK 6 GAUGE CABLE (RED AND BLACK) CABLE TO AMP

22

1 Signal Cable, Length 1.5m (single core 16 gauge wire, single insulated black or grey)

IN ORDER FOR AMP TO SWITCH ON AND OFF WHEN HEAD UNIT IS POWERED UP IT IS IMPORTANT TO INTRODUCE THIS SECTION OF REMOTE CABLE. THIS WILL THEN BE CONNECTED TO THE BACK ON THE HEADUNIT INTO THE AMP ON SWITCH CABLE.



23

A PAIR OF MID SPEAKERS CAN BE CONNECTED TO THE AMP ALONG WITH A SUB

CONNECT THE CABLED INTO THE ZONE 2 TERMINAL BLOCKS ON AMP.

MAKE SURE THE LEFT HAND SPEAKER PLUGS INTO CH 3 AND RIGHT HAND SPEAKER INTO CH 4 ENSURE POLARITIES ARE CORRECT.

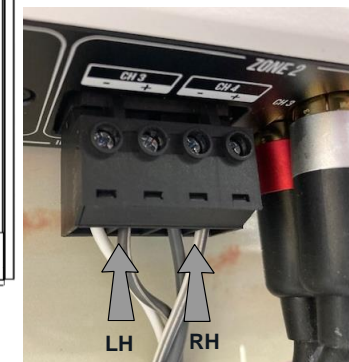
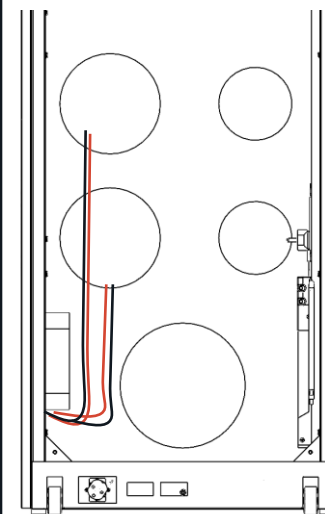

24

CONNECTING RCA CABLES FOR SPEAKERS AND MONO SUB

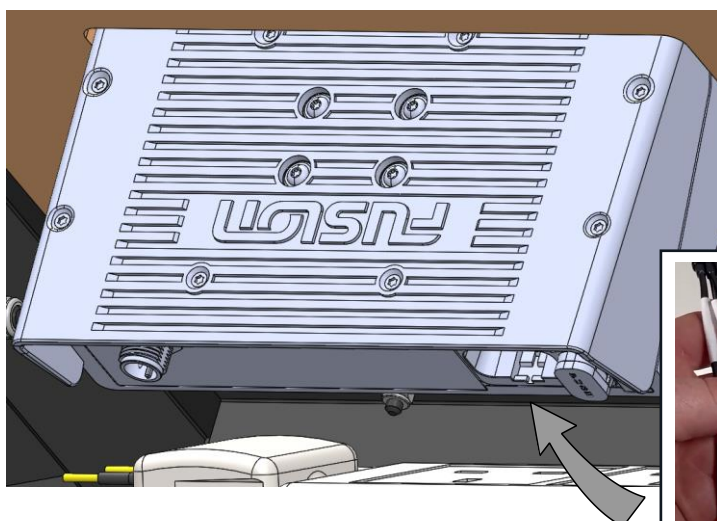

IN ORDER TO PROVIDE CORRECT MUSIC INPUT SIGNAL TO AMP THE HEAD UNIT NEEDS TO BE CORRECTED VIA 3 OFF RCA CABLES.

1 OFF PAIR OF RCA CABLE FOR THE LH SPEAKER AND RH SPEAKER 2 CHANNEL

1 OFF SINGLE RCA CABLE FOR SUB OUTPUT.

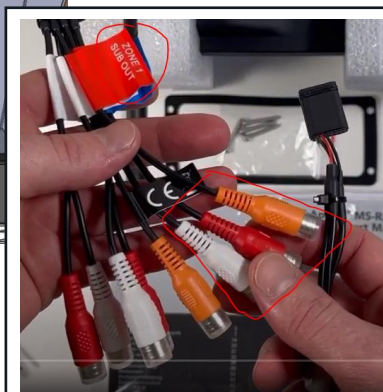

25



AGAIN THE CORRECT CABLES NEED TO BE USED. SO ZONE 1 NEEDS TO BE USED.

START BY PLUGGING 1 OFF 2 CHANNEL PLUGS INTO THE RED AND WHITE RCA CONNECTOR ON BACK OF HEAD UNIT



26

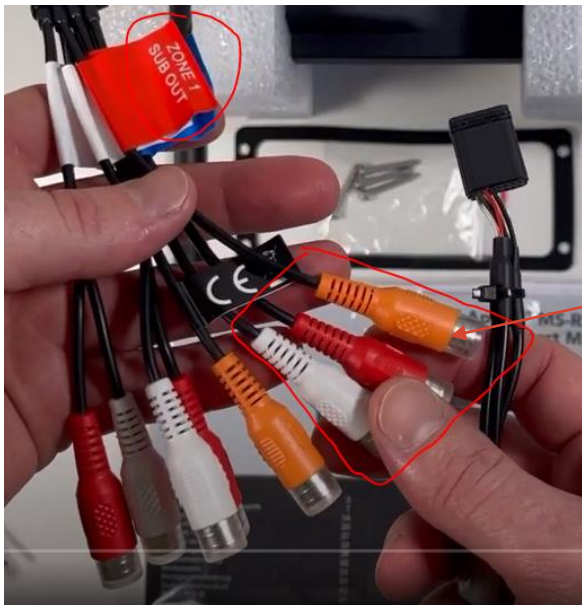

AND THEN PLUG A
1 CHANNEL RCA CABLE INTO
THE ORANGE CONNECTOR
THIS IS FOR THE
SUBWOOFER OUTPUT.



27

CONNECTING RCA CABLES FOR SPEAKERS AND MONO SUB

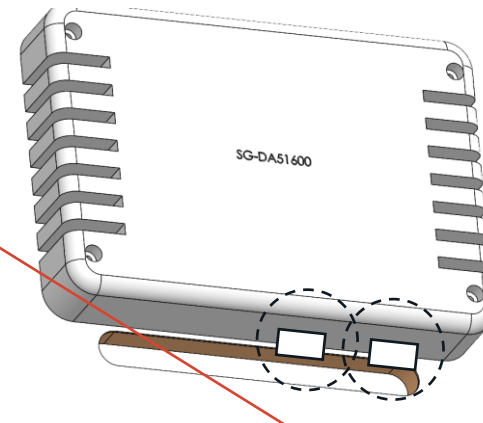

PLUG RCA CABLES INTO RCA
TERMINALS ON BOTTOM
EDGE OF AMP
1 OFF 1 CHANNEL INTO
ZONE 3
1 OFF 2 CHANNEL INTO
ZONE 2

28

SUPPLIED 1 OFF 16AWG 2
CORE CABLE AND CONNECT
TO THE + AND - TERMINAL
ON THE BACK OF THE
SPEAKER

USE THE BUTT SPINE CRIMP
CONNECTORS TO CONNECT
THE 16AWG CABLE

FEED CABLES THROUGH
INTO ZONE 3
TERMINAL BLOCK ON AMP

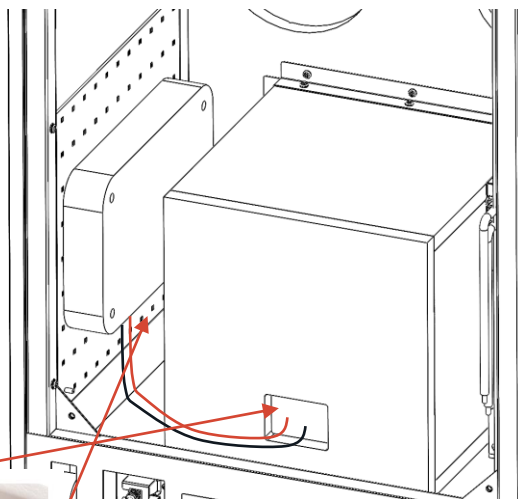

29

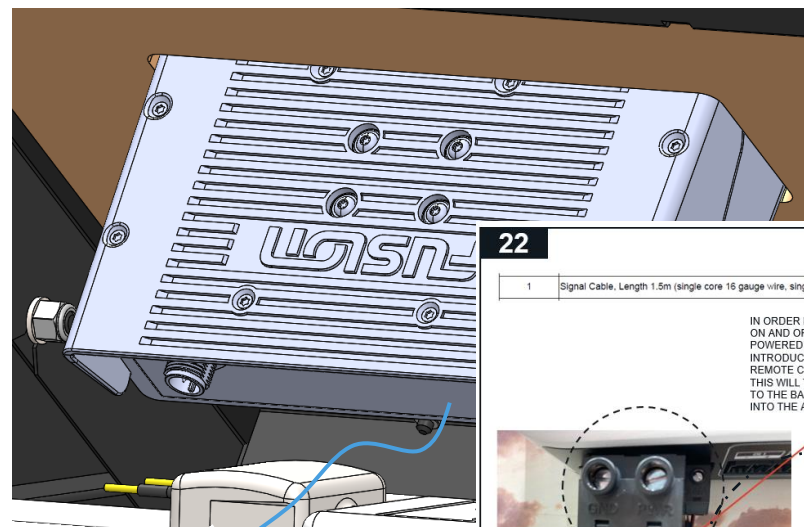

NOW THE CABLE THAT WAS
CREATED IN STEP 22 NEEDS
TO BE CONNECTED TO THE
AMPLIFIER ON BLUE CABLE

CONNECT WITH BUTT SPINE
CRIMP CONNECTOR

RS Stock No. 534-
288

22

1 Signal Cable, Length 1.5m (single core 16 gauge wire, single insulated black or grey)

IN ORDER FOR AMP TO SWITCH
ON AND OFF WHEN HEAD UNIT IS
POWERED UP IT IS IMPORTANT TO
INTRODUCE THIS SECTION OF
REMOTE CABLE.
THIS WILL THEN BE CONNECTED
TO THE BACK ON THE HEADUNIT
INTO THE AMP ON SWITCH CABLE.



WIRE THE RED AND
BLACK CABLE INTO THIS
TERMINAL BLOCK ON
AMP

GARMIN®

30

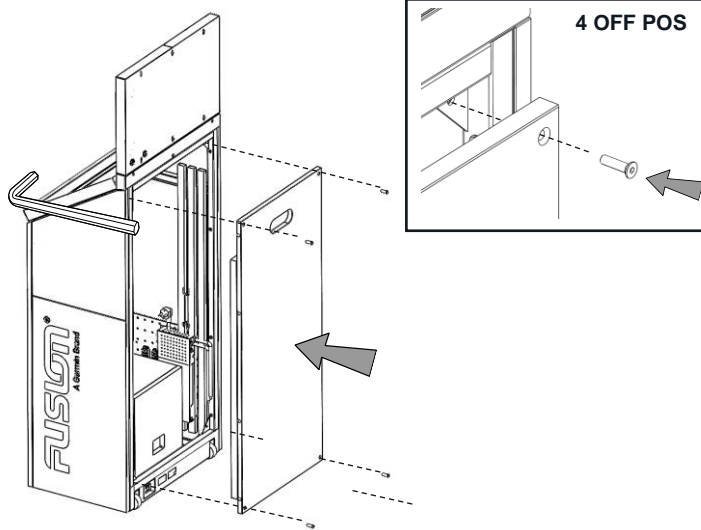

31

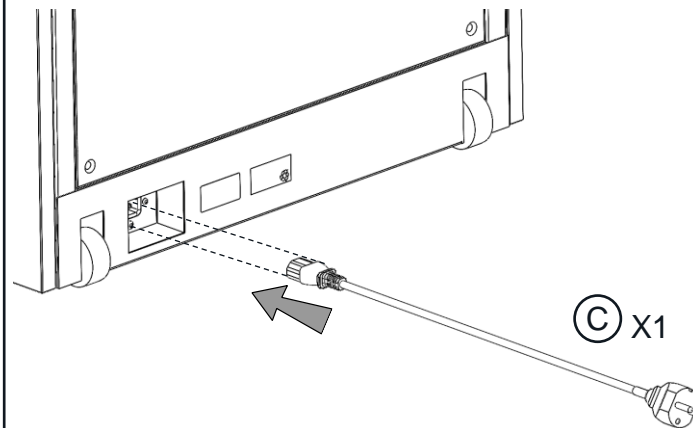

32

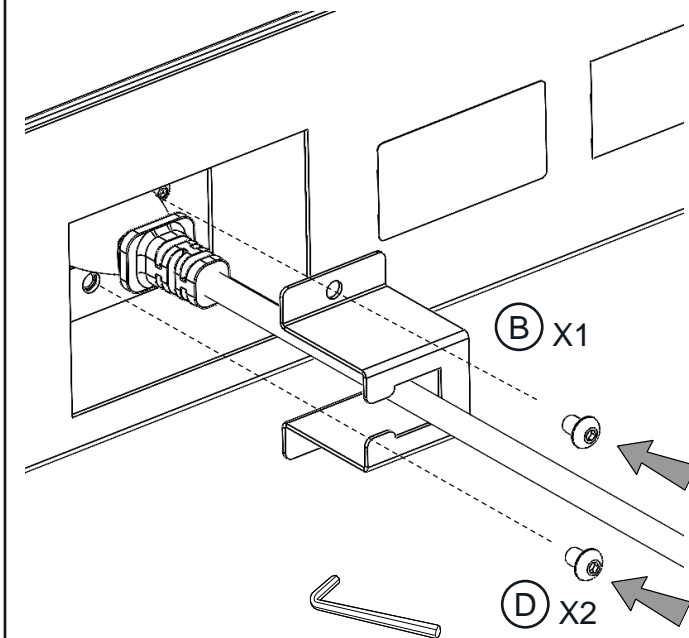

33

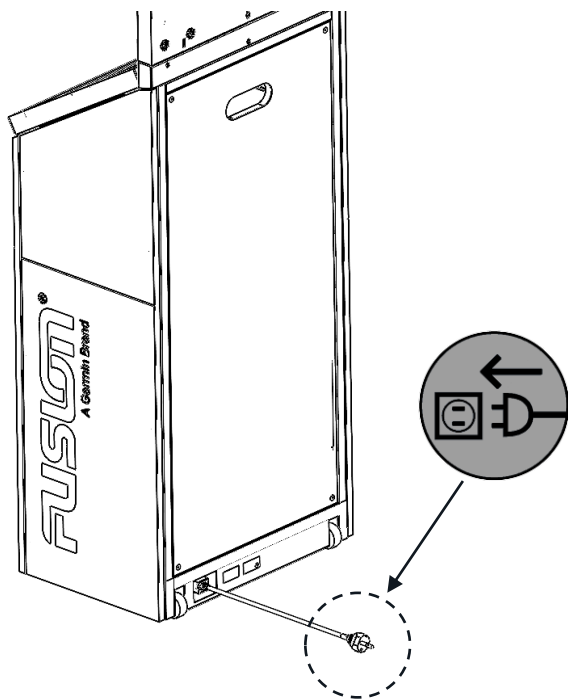

34

ADDING MAGNETIC GRAPHIC

Graphics Not Supplied – to be ordered separately

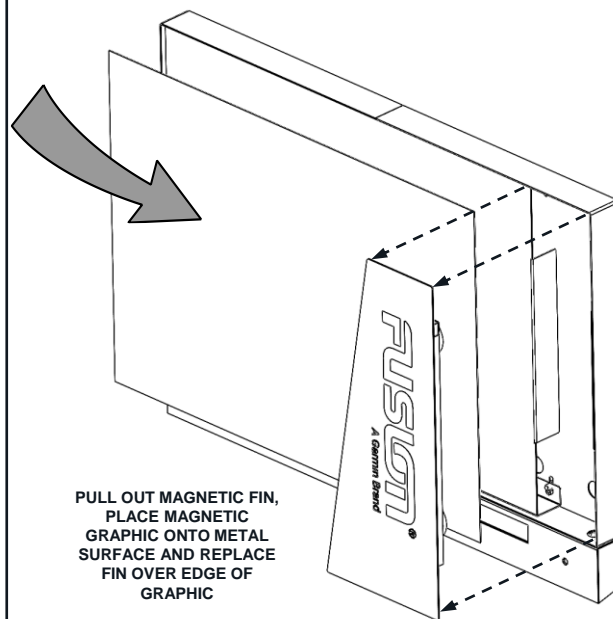

35

ADDING FABRIC LIT GRAPHIC

Graphics Not Supplied – to be ordered separately

