

GARMIN

L60i MINI PLINTH

P13151

15/08/2025

INSTALL GUIDE

TOOLS REQUIRED – SUPPLIED

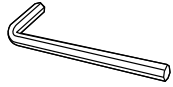

T20 SECURITY TORX KEY

TOOLS REQUIRED – NOT SUPPLIED

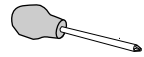

PHILLIPS SCREWDRIVER



CTU KEY

Parts

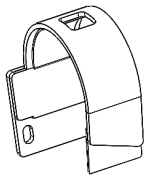

(A) x1

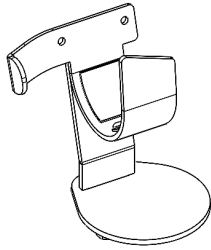

(B) x1

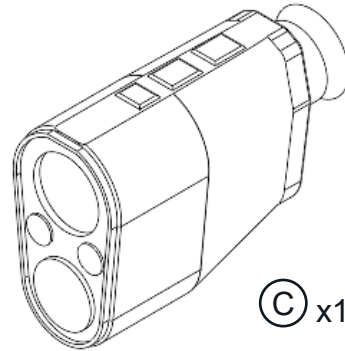

(C) x1

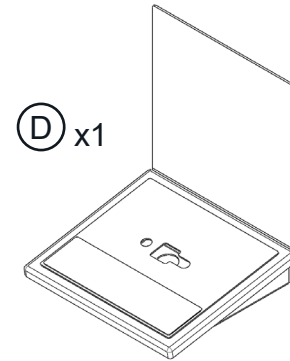

(D) x1

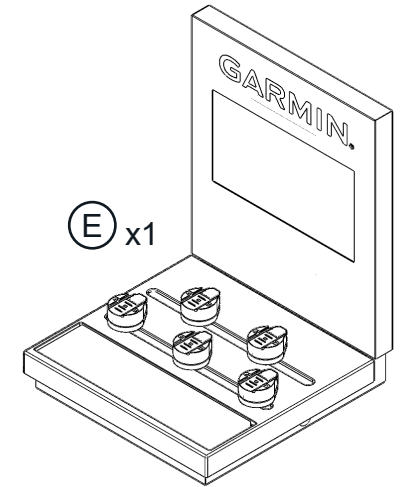

(E) x1



(1) x2

M4x6MM T20 SECURITY TORX BUTTON HEAD



(2) x2

M4x12MM T20 SECURITY TORX BUTTON HEAD



(3) x2

M4 WASHER

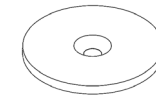

(4) x2

MINI PLINTH WASHER



(5) x2

M4x25MM CSK T20 SECURITY SCREW

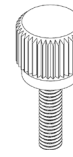

(6) x2

M4x15MM THUMB SCREW

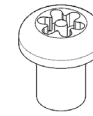

(7) x1

M6x8MM T20 SECURITY SCREW BUTTON HEAD

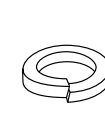

(8) x2

SPRING WASHER

1 ADDING PRODUCT TO CRADLE

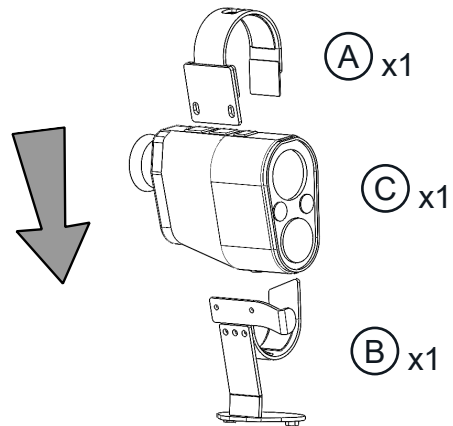

(A) x1

(C) x1

(B) x1

2

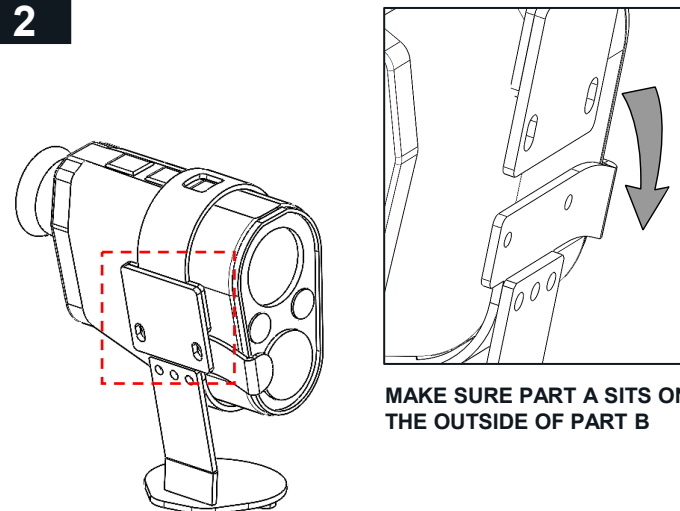

MAKE SURE PART A SITS ON THE OUTSIDE OF PART B

3

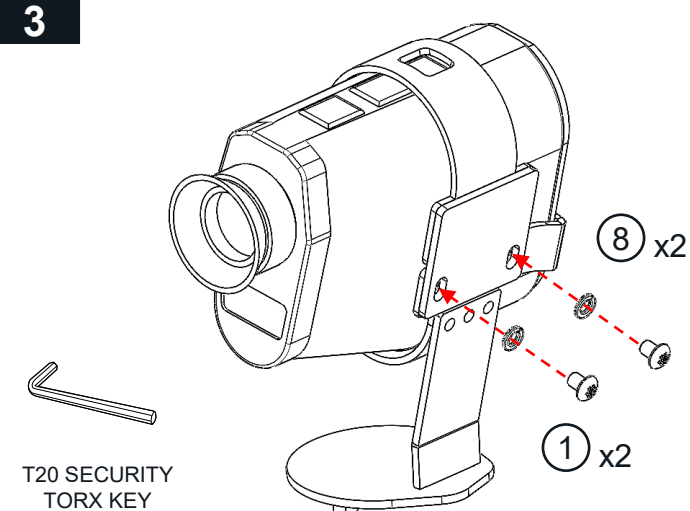

T20 SECURITY TORX KEY

(8) x2

(1) x2

4

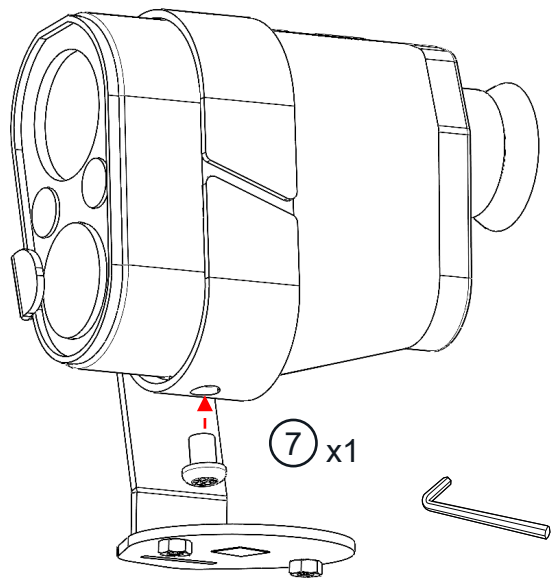

T20 SECURITY TORX KEY

5

MINI PLINTH GRAPHICS

MAG / PHOTOTEX GRAPHIC MUST ALIGN WITH THE CORNERS OF THE MINI PLINTH METALWORK

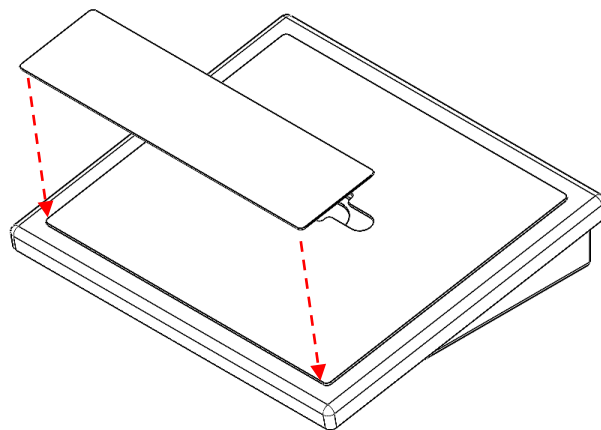

6

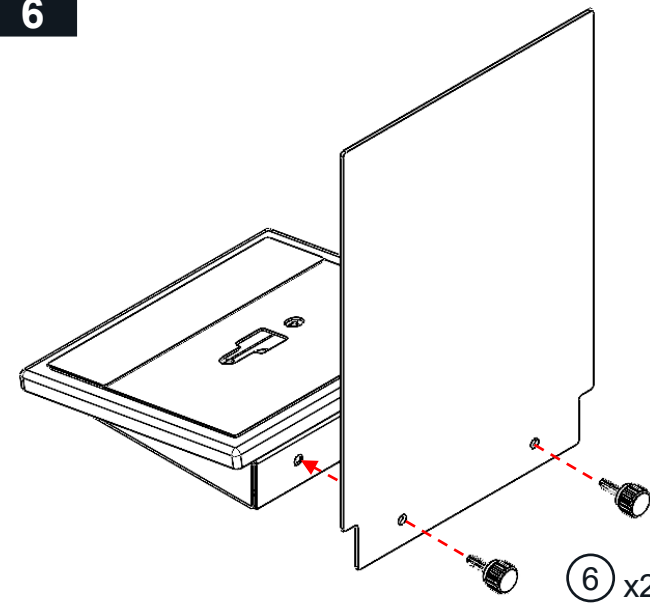

THUMBSCREWS CAN BE USED WITH HIPS OR FOLDED ACRYLIC HEADER

7

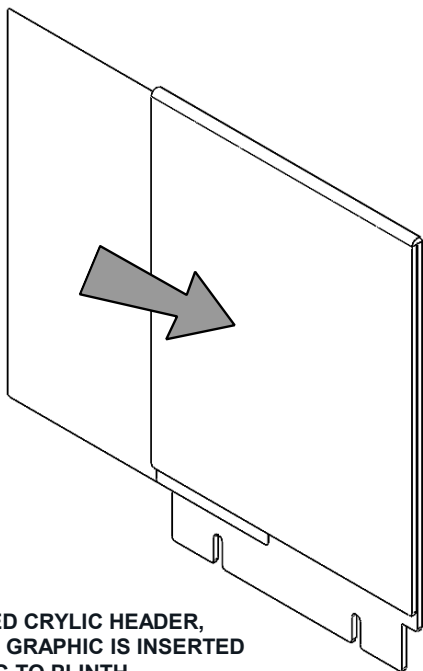

IF USING FOLDED ACRYLIC HEADER, ENSURE PAPER GRAPHIC IS INSERTED BEFORE FITTING TO PLINTH

8

FITTING CRADLE TO MINI PLINTH

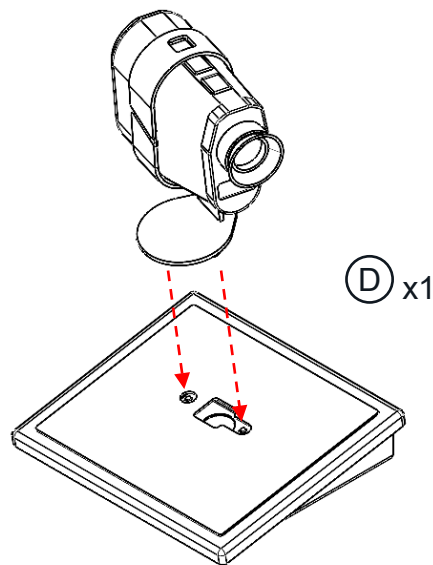

9

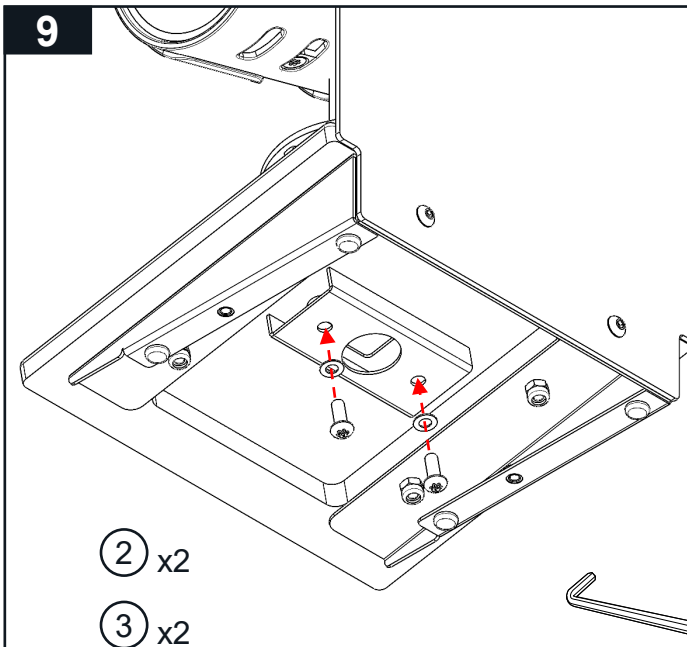

T20 SECURITY TORX KEY

10

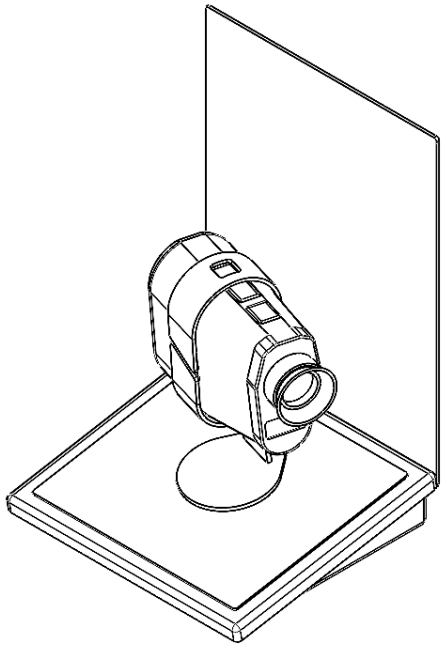

11



FURTHER STEPS ARE FOR
FITTING MINI PLINTH TO MID 2
CTUS – IF NOT REQUIRED,
INSTALL GUIDE STOPS HERE

12

13

FITTING TO CTUS

SHOWN ON MID 2 400 CTU – PLINTH CAN ALSO BE FITTED TO MID 2 600 CTU.
WORKS WITH ANY HEADER COMBINATION



GUIDE SHOWS BLAZE MINI PLINTH BEING FITTED TO CTU – SAME PROCESS APPLIES FOR L60i MINI PLINTH

14

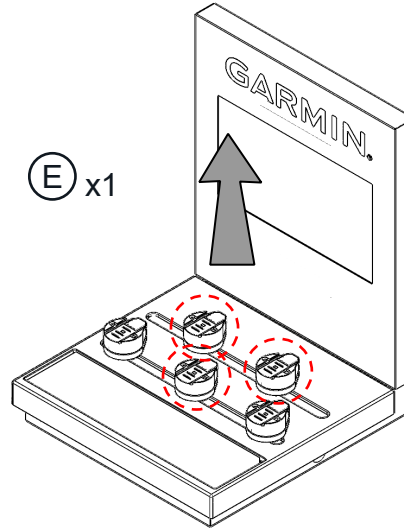

3x SECURITY MOUNTS NEED TO BE REMOVED TO MAKE SPACE FOR MINI PLINTH

15

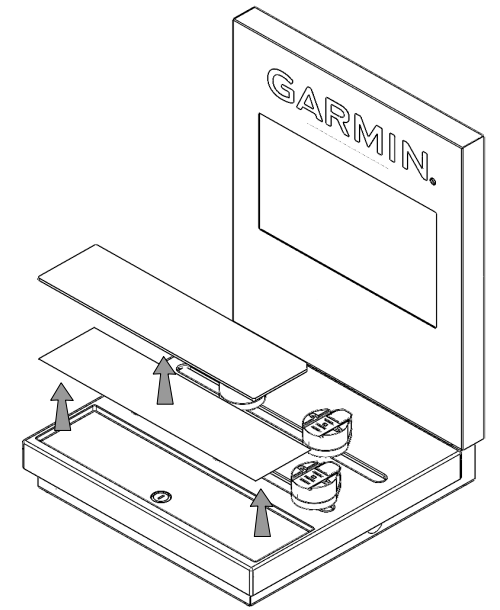

REMOVE PRODUCT INFO CARDS AND LENS

16

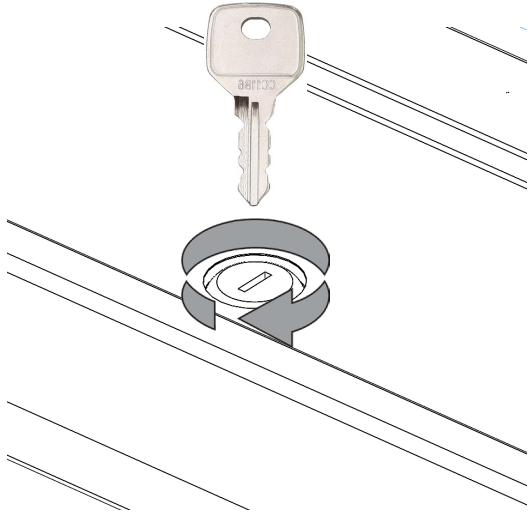

17

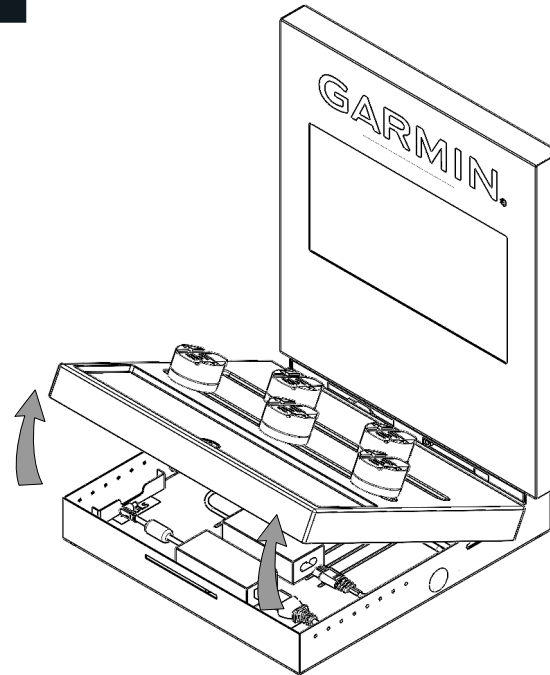

18

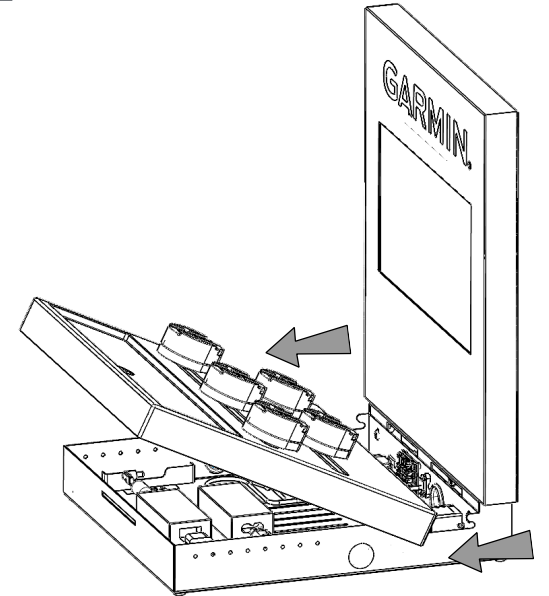

19

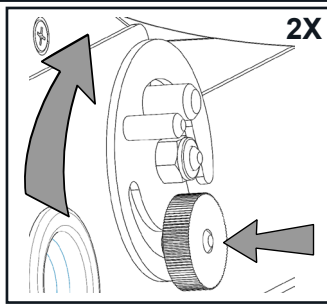
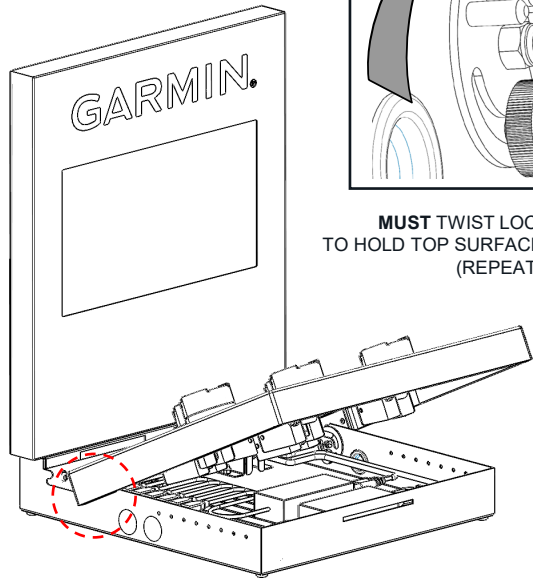

MUST TWIST LOCKING PLATES TO HOLD TOP SURFACE IN POSITION (REPEAT BOTH SIDES)

20

RED SUPPORT ARM MUST BE SWUNG INTO POSITION TO SUPPORT TOP PLATE

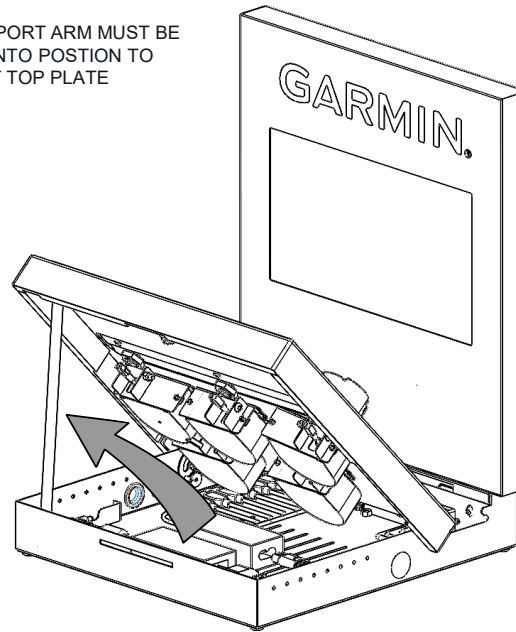

21

REMOVE ANY EXISTING CRADLES FROM THE SECURITY MOUNTS

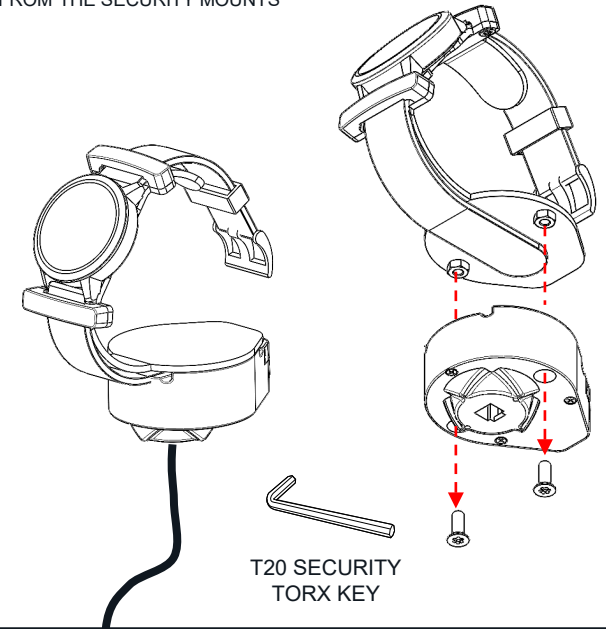

T20 SECURITY TORX KEY

22

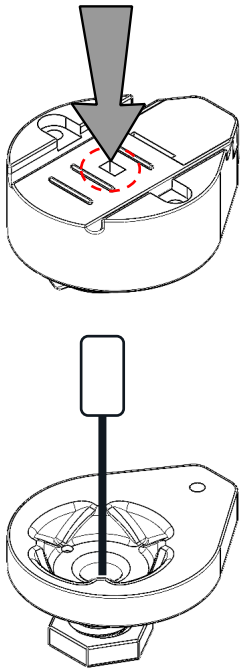

A THIN ALLEN KEY OR SIMILAR NEEDS TO BE INSERTED INTO THE OPENING IN THE TOP OF THE SECURITY MOUNT TO RELEASE THE RECOILER CABLE.

23

OPTIONAL – REMOVING THE RECOILER ASSEMBLIES CIRCLED MAY MAKE INSTALLING THE MINI PLINTH EASIER

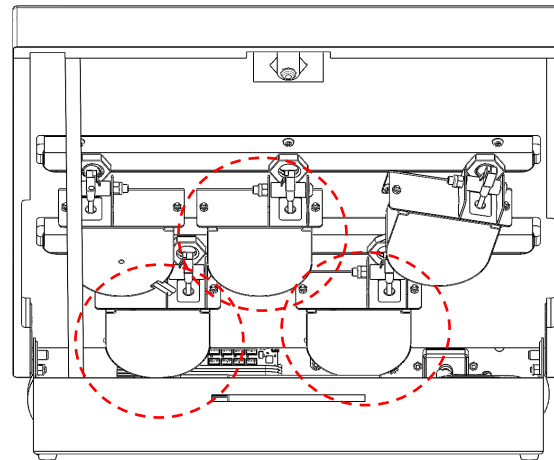

24

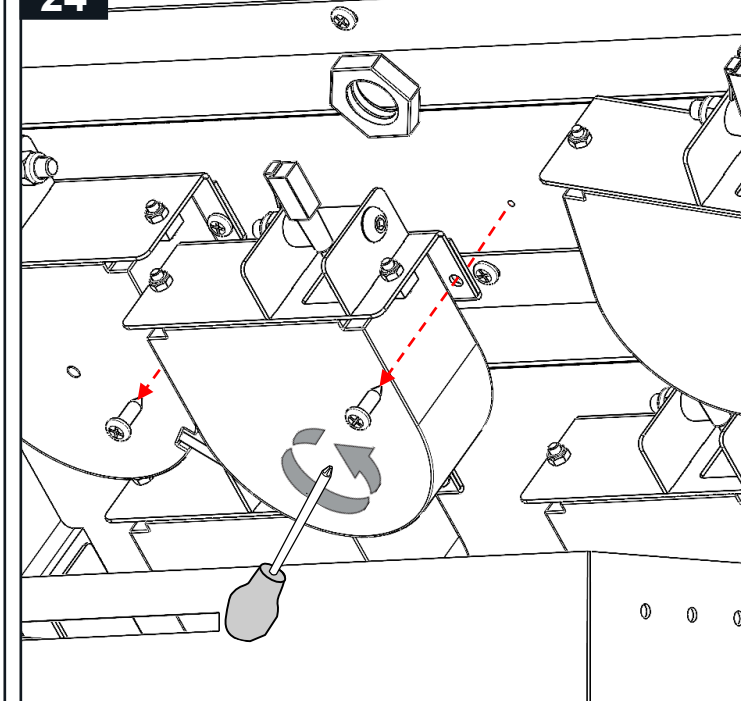

25

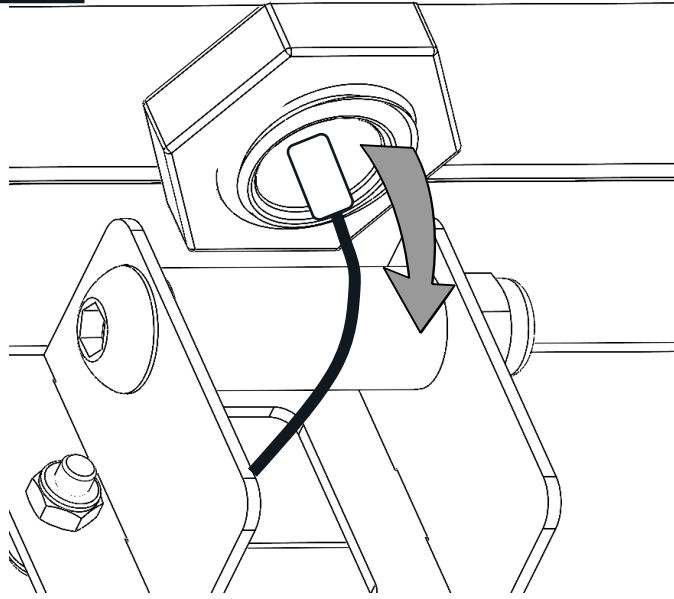

26

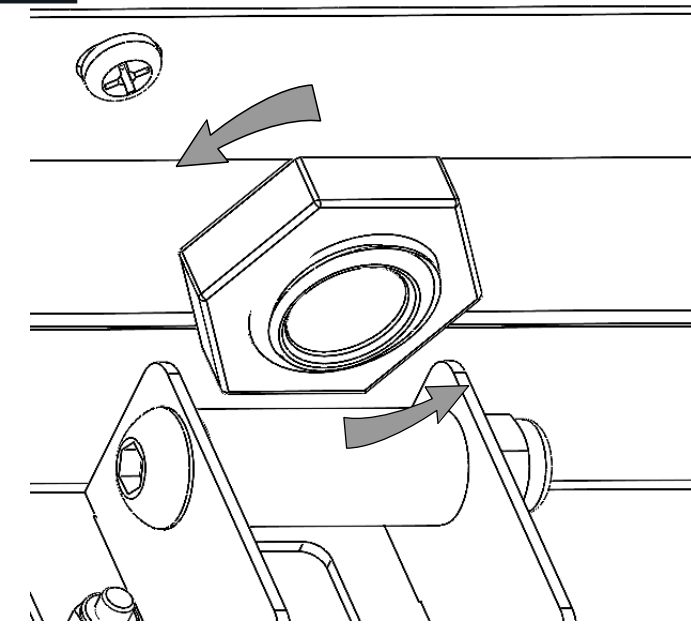

27

REMOVE 3 X SECURITY MOUNTS

ALL REMOVED COMPONENTS SHOULD BE SAFELY STORED FOR FUTURE USE

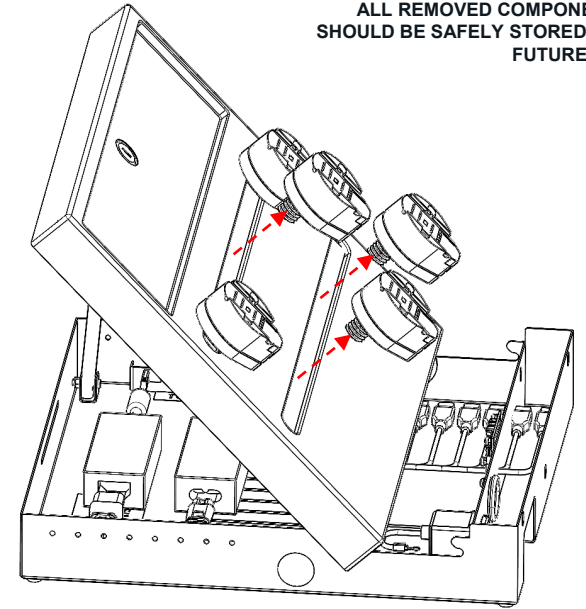

28

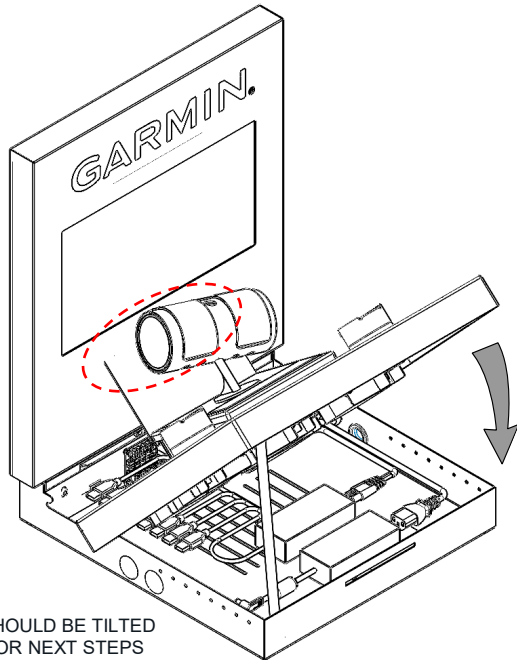

WOOD TOP SHOULD BE TILTED FORWARDS FOR NEXT STEPS OTHERWISE MINI PLINTH GRAPHIC WILL CLASH WITH HEADER

29

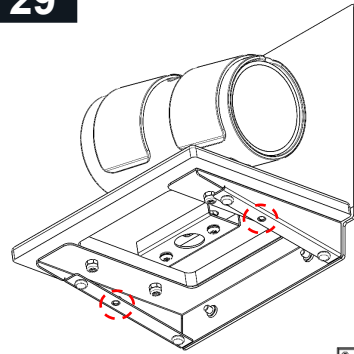

ALIGN THE HOLES IN THE MINI PLINTH METALWORK WITH THE BACK BRUSH STRIP ON CTU

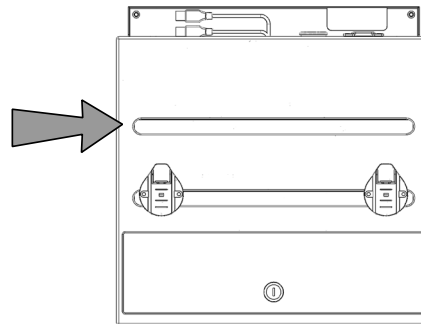

30

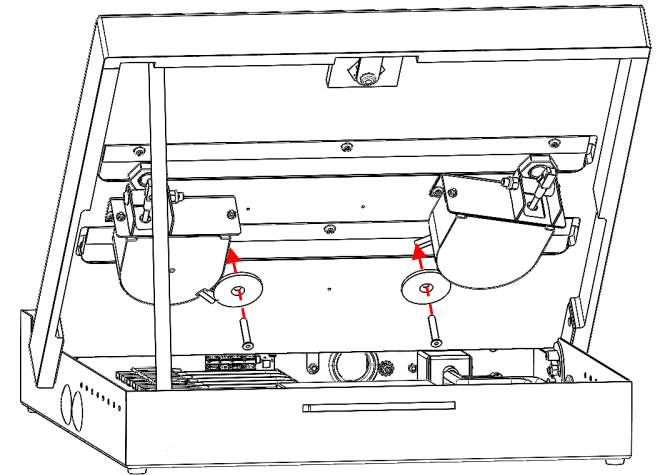

4 x2

5 x2



FIT THE SCREWS AND WASHERS THROUGH THE BRUSHSTRIP TO THE MINI PLINTH METALWORK

T20 SECURITY TORX KEY

31

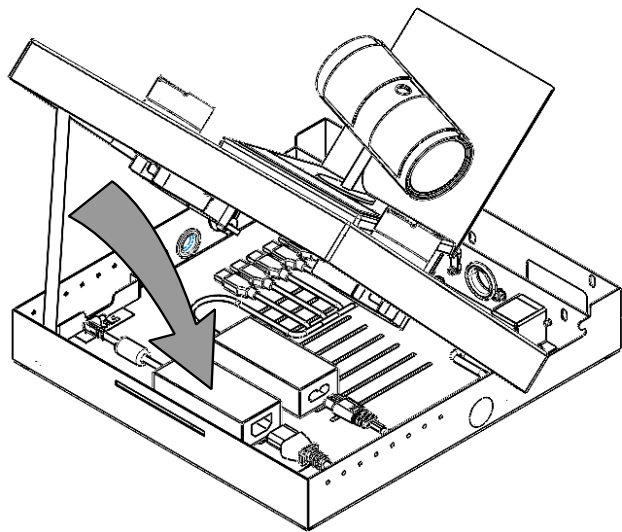

32

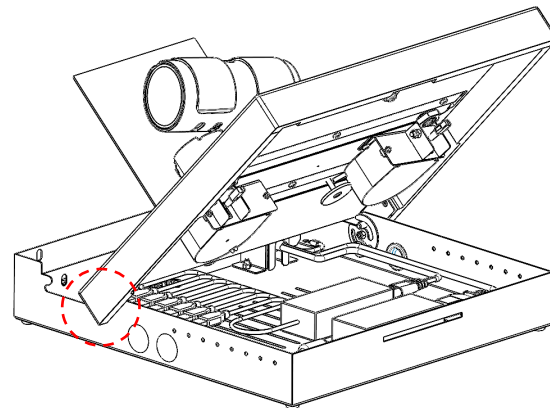

33

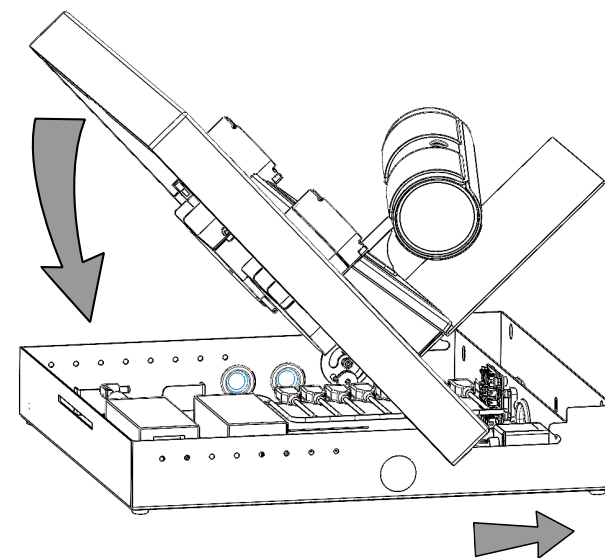

34



35

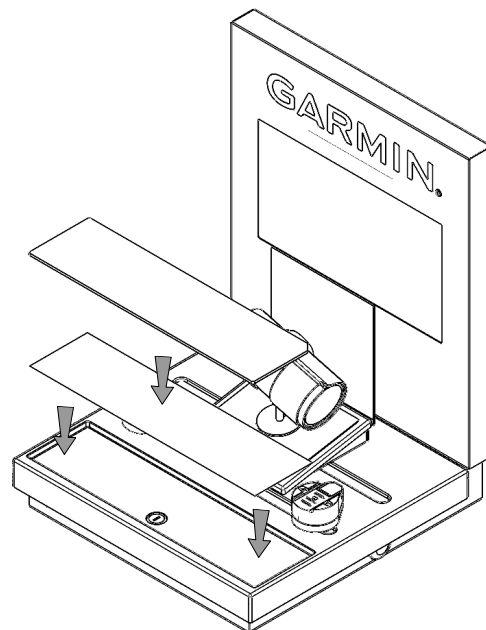

36

