

## ASSEMBLY GUIDE

## TOOLS REQUIRED – SUPPLIED

Parts

Ⓐ X1

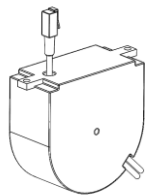

Ⓑ X1



Ⓒ X1

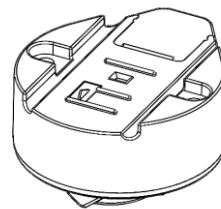

Ⓓ X1



1

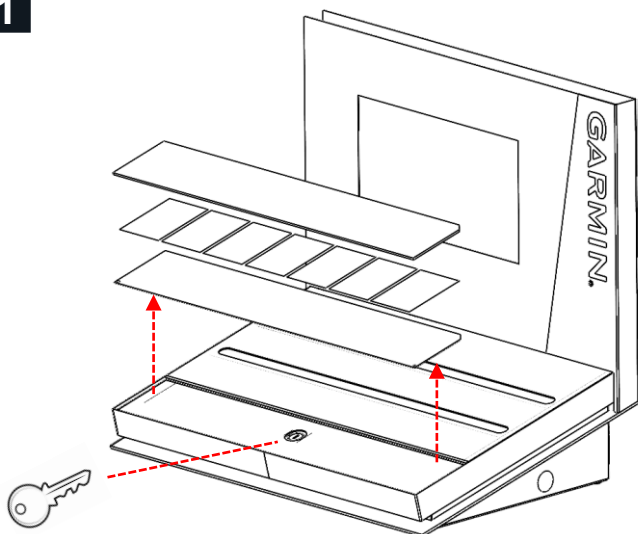

2

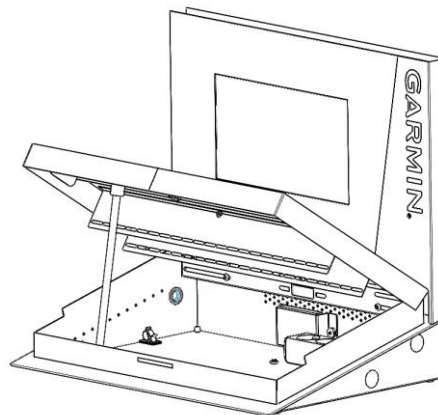

3

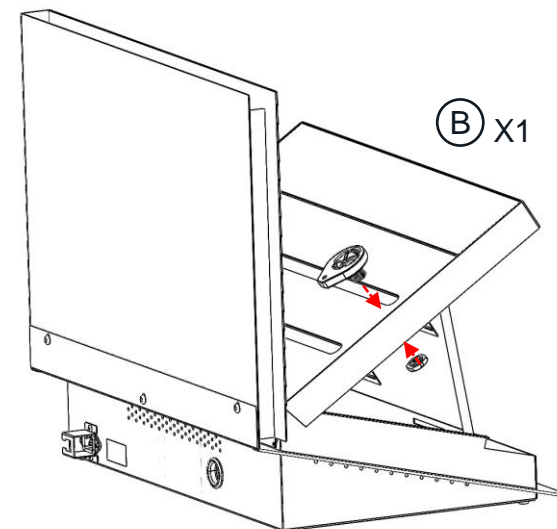

4

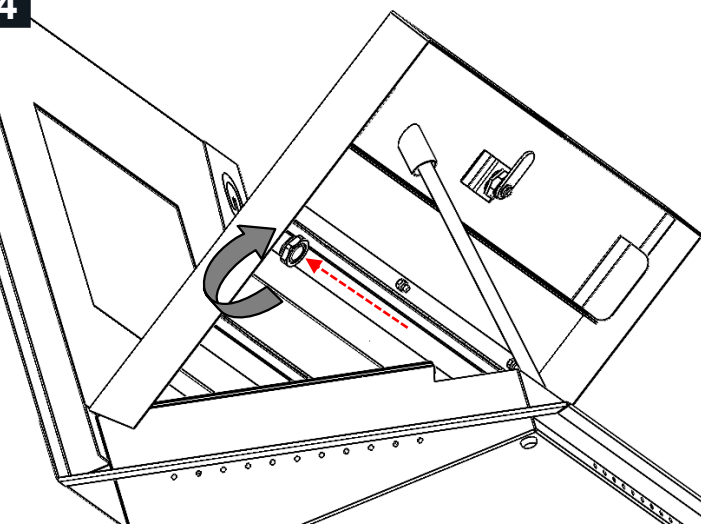

5

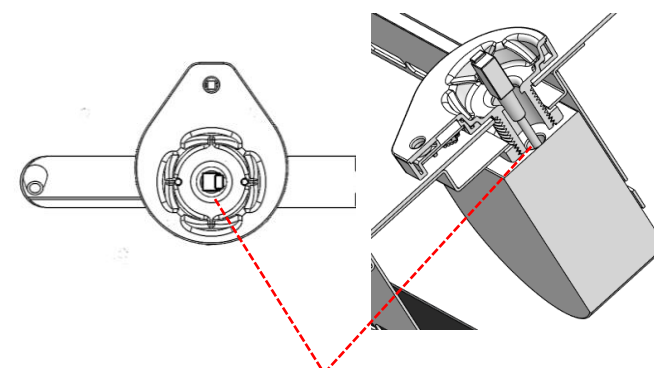
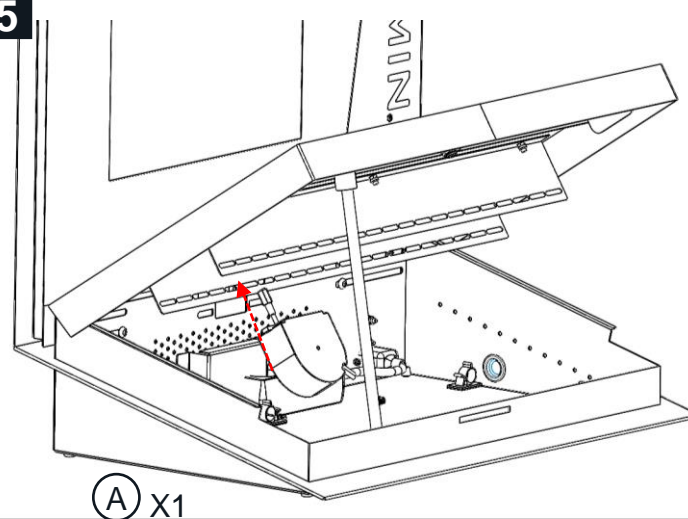

**!CRITICAL!**  
Ensure recoiled cable  
hole is aligned with the  
security mount.

6



CLIP RJ9(1) CONNECTOR INTO  
SOCKET IN TOP MOULDING



7

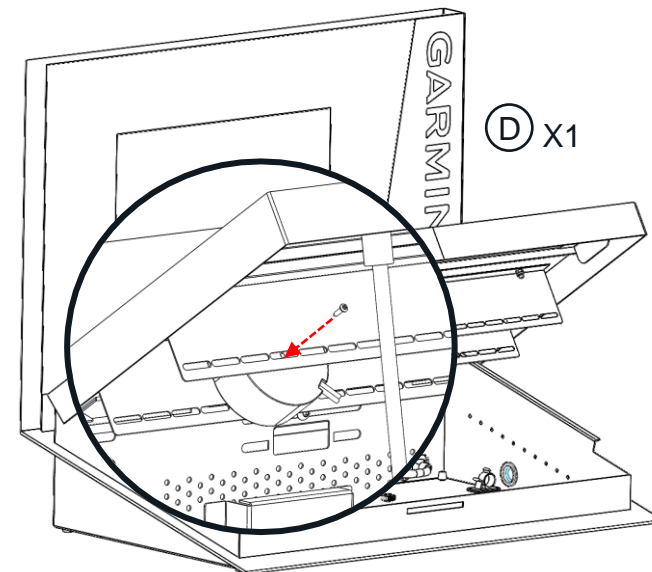

8

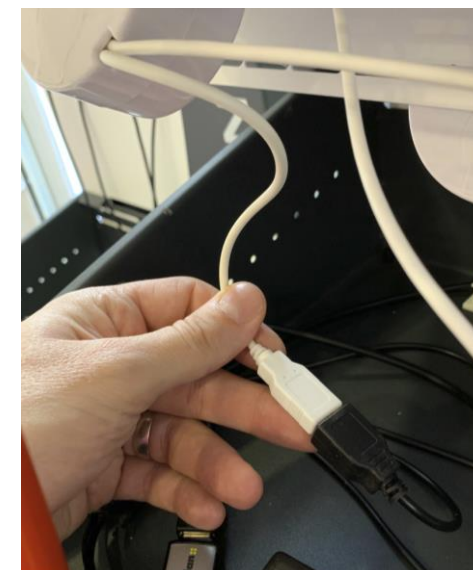
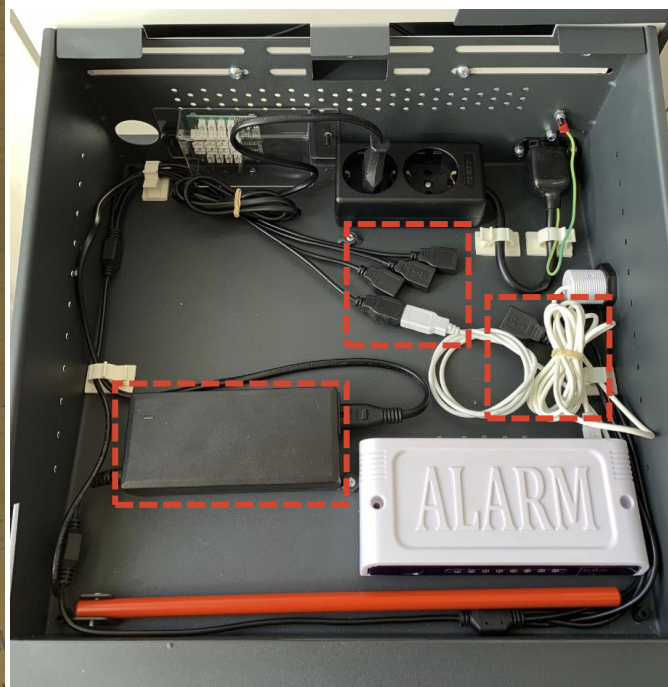
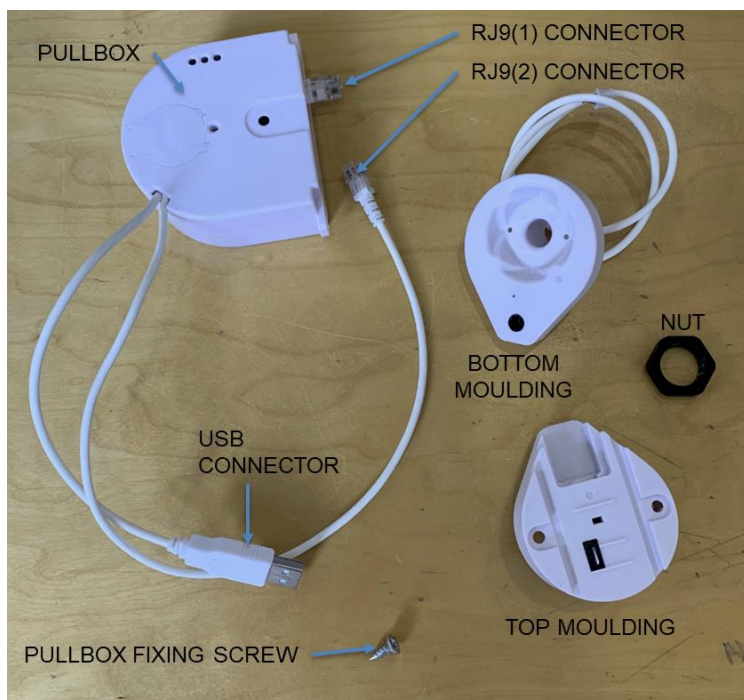

Connect USB from pull box to USB  
splitter in base.



9

TAKE THE RJ9(2) PLUG  
FROM THE RECOILER  
AND PLUG  
IT INTO THE  
CORRESPONDING PORT  
ON THE  
ALARM UNIT

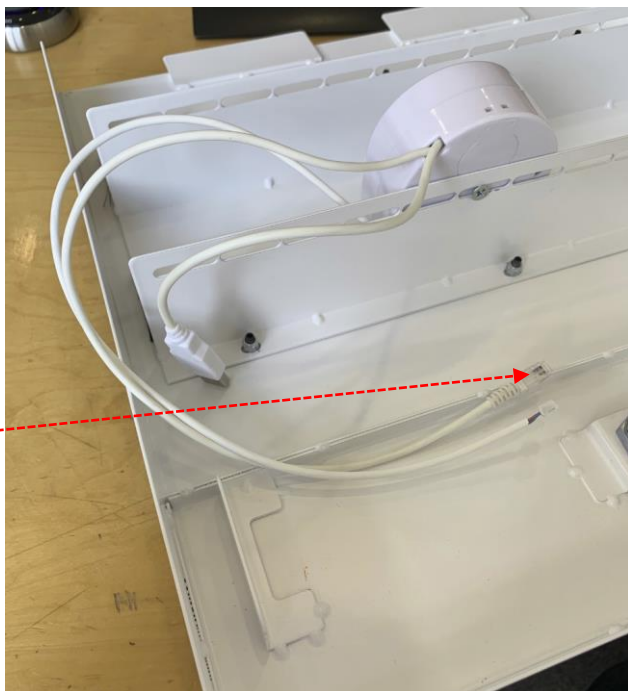

10 Only required for Lift and Learn

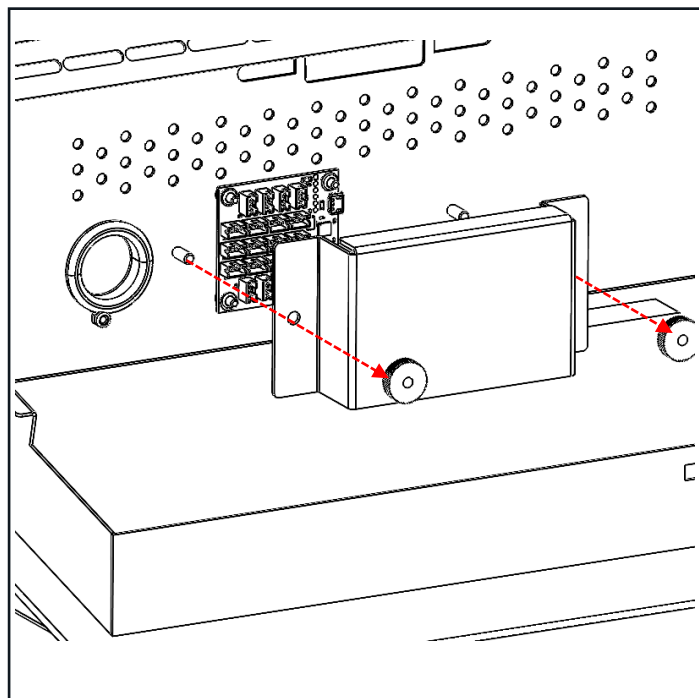

Connect Molex into PCB board

