

ASSEMBLY GUIDE

TOOLS REQUIRED – SUPPLIED

Parts

Ⓐ X1

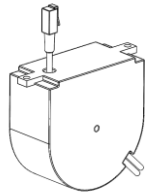

Ⓑ X1

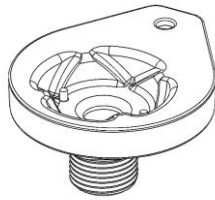

Ⓒ X1

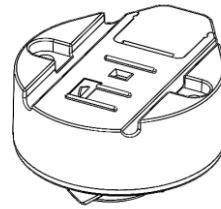

Ⓓ X1



1

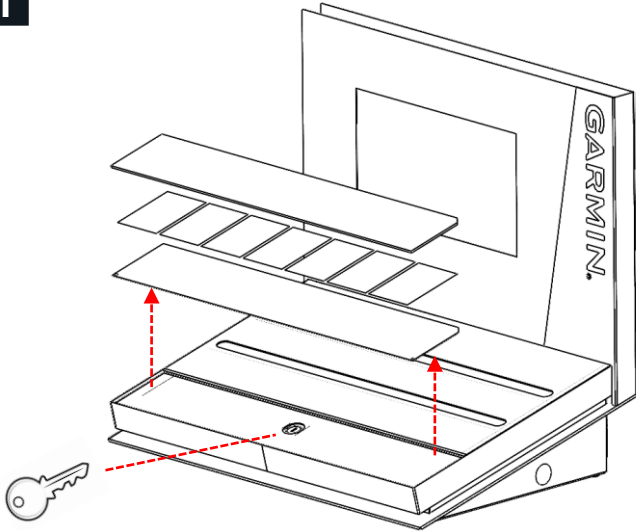

2

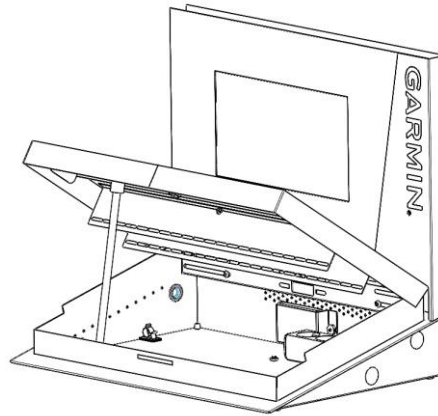

3

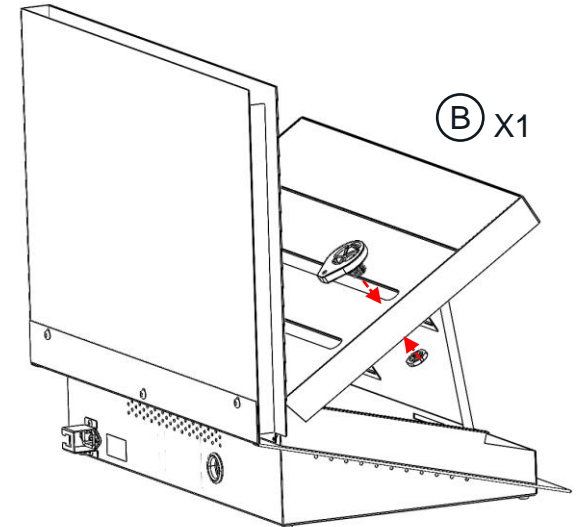

4

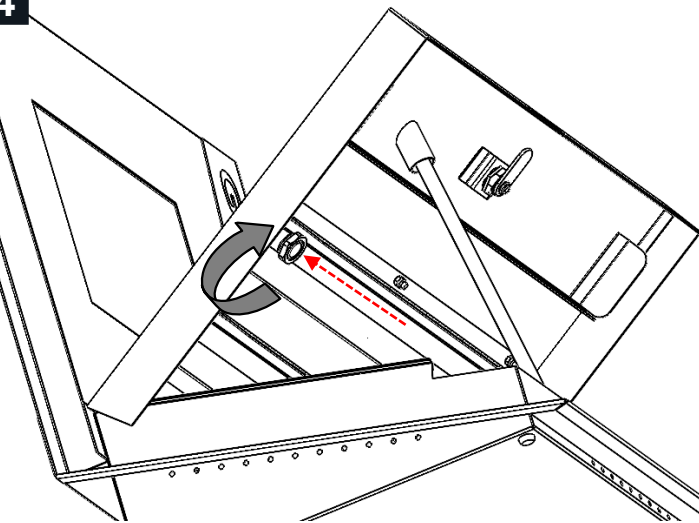

5

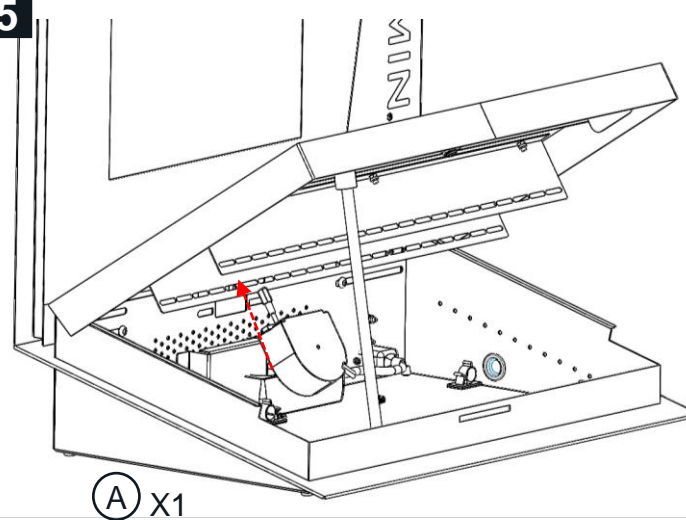

Ⓐ X1

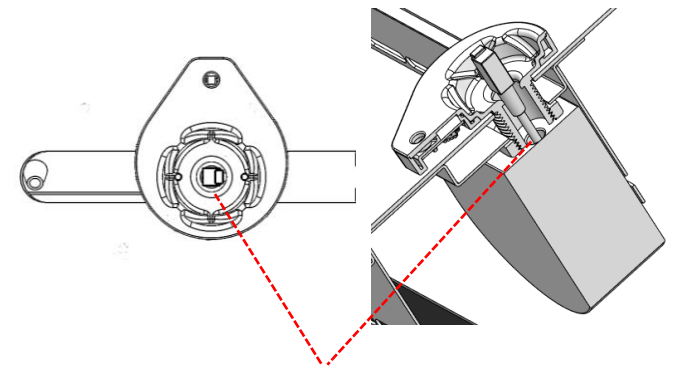

!CRITICAL!
Ensure recoiled cable
hole is aligned with the
security mount.

6



CLIP RJ9(1) CONNECTOR INTO
SOCKET IN TOP MOULDING



7

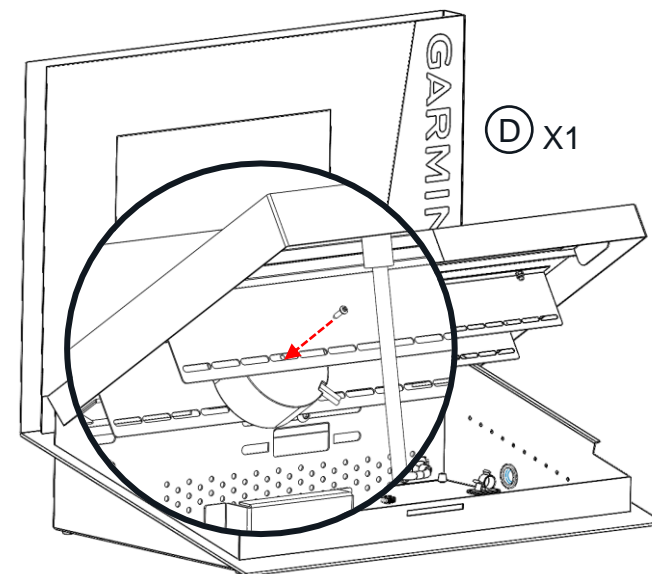

8

