

Tools Required (NOT supplied)

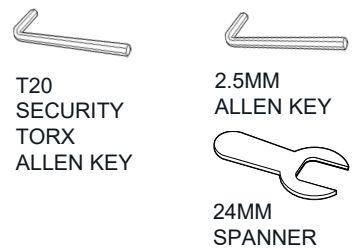

Parts

A x1
NEW TOP



GUIDE SHOWS CTU – 600MM VERSION BUT IS ALSO APPLICABLE FOR CTU – 400MM VERISON.

PLEASE REFER TO INDIVIDUAL STEPS FOR CORRECT UNIT VERSION.

1 UNPLUG DISPLAY

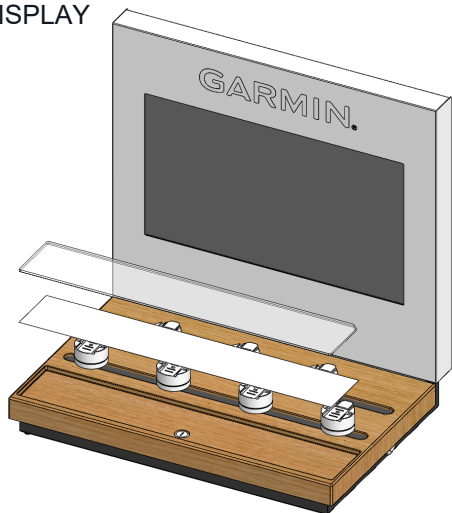
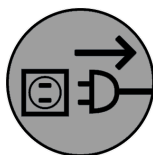

2

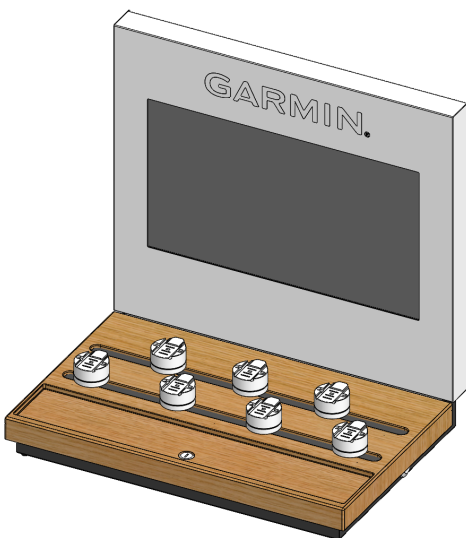

3

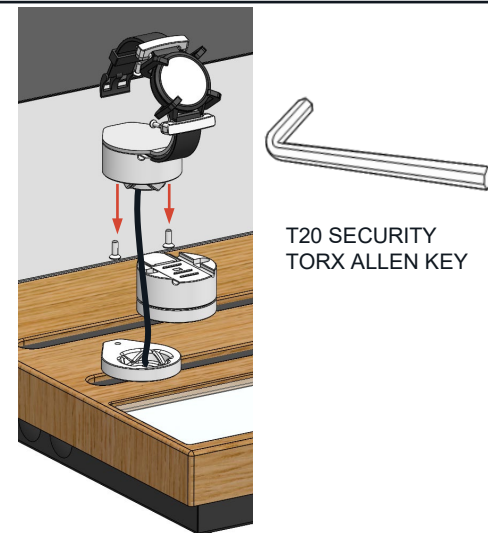

4

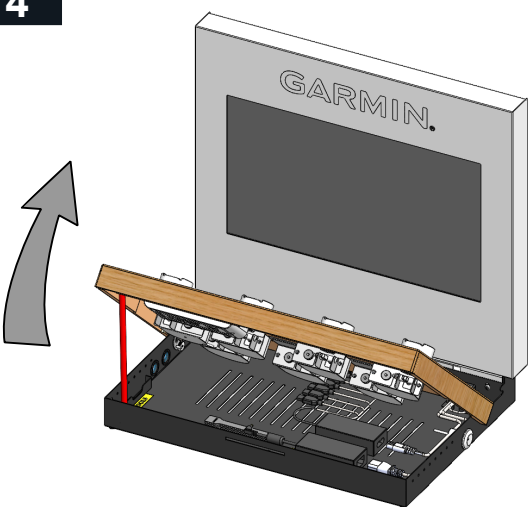

5

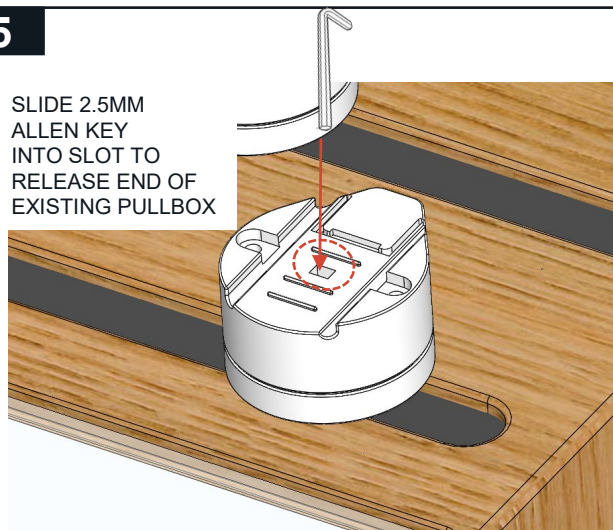

6

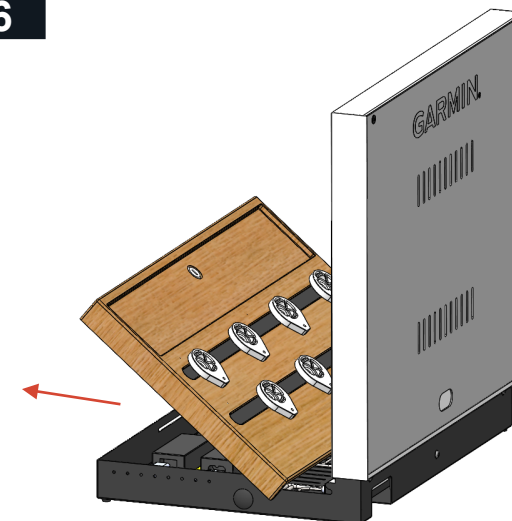

7

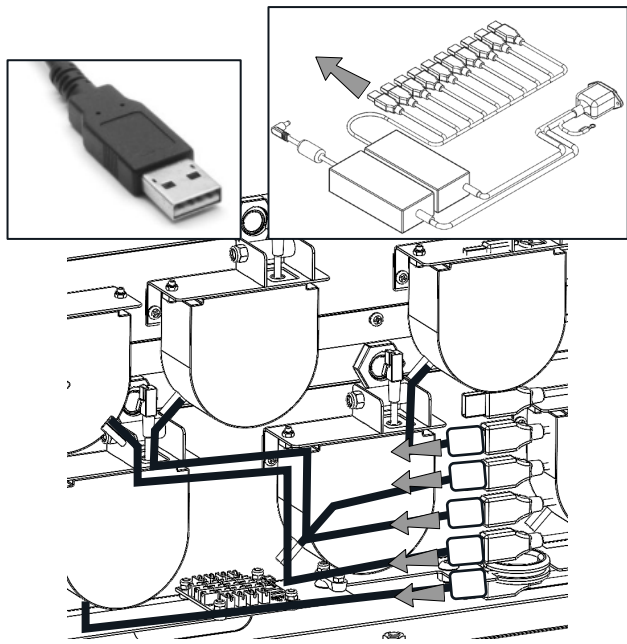

8

CAREFULLY REMOVE ALL PLUGS ON PCB

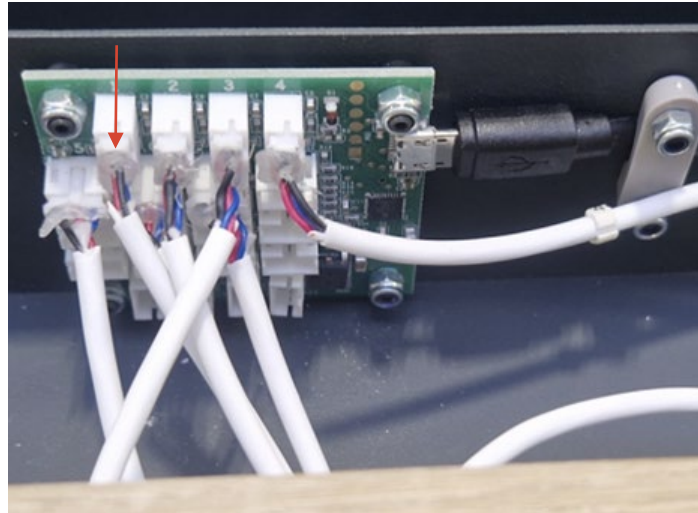

9

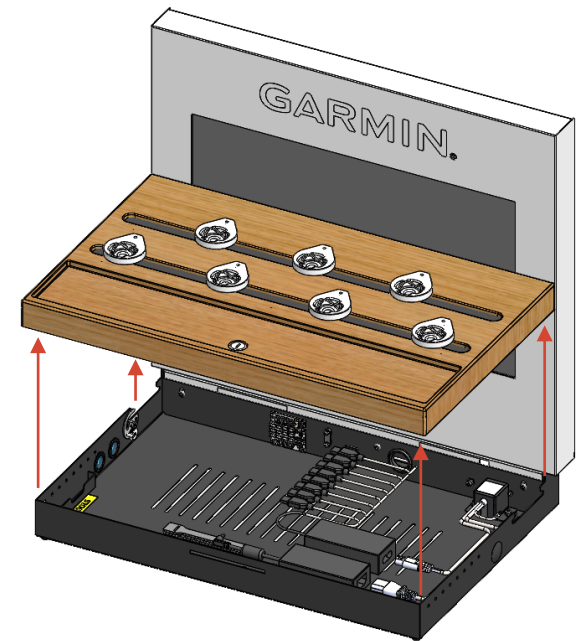

10

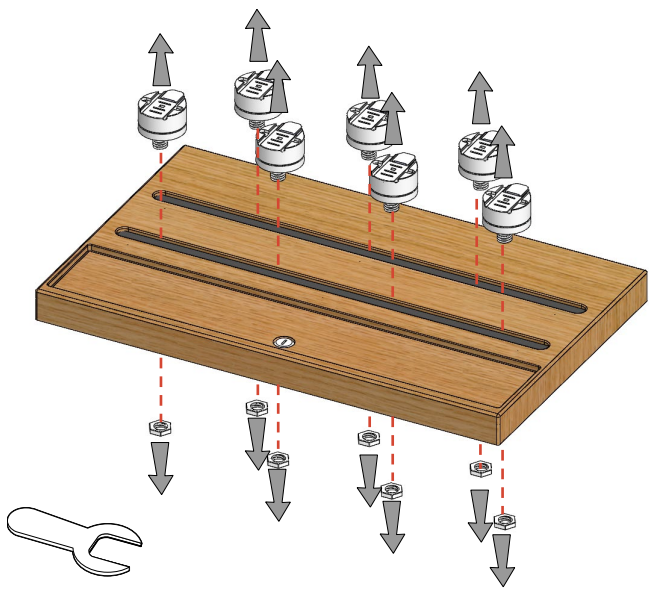

24MM SPANNER

11

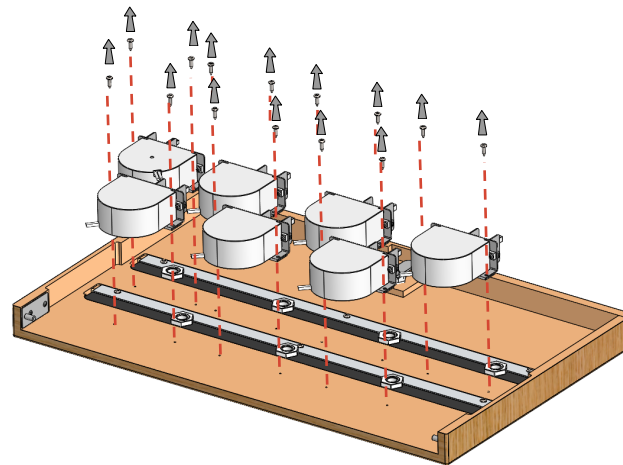

12

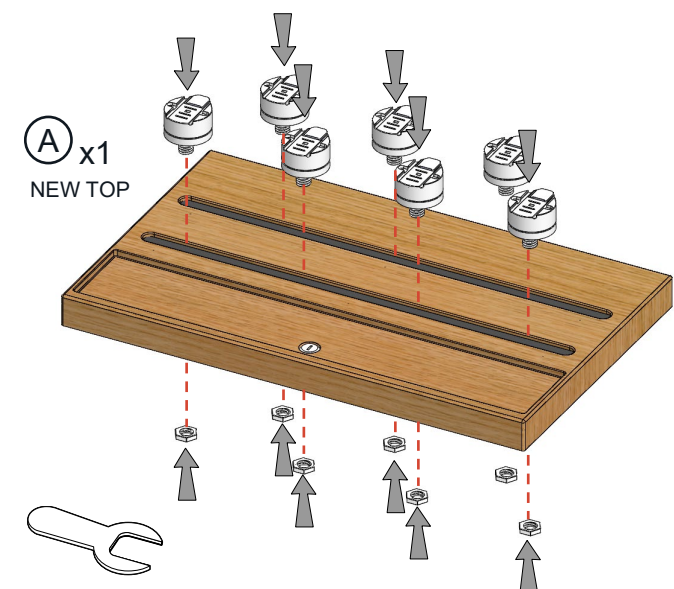

(A) x1
NEW TOP

24MM SPANNER

13 600 VERSION

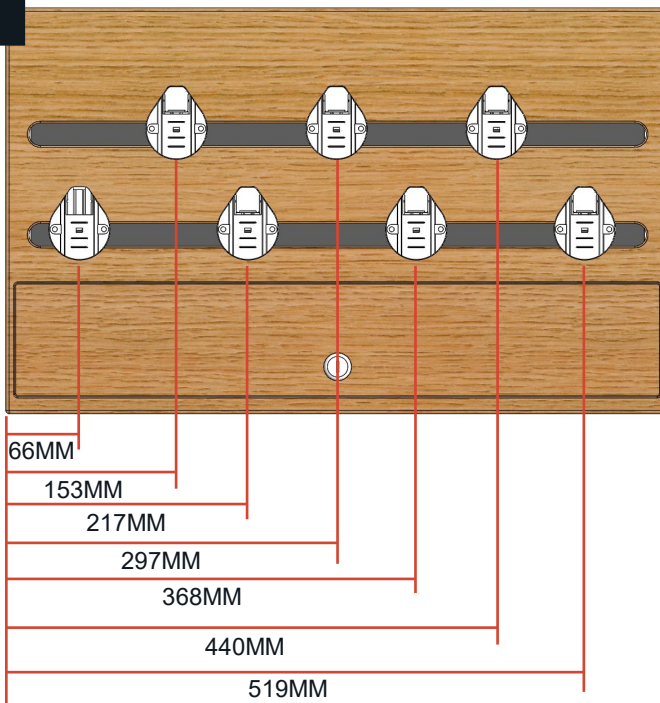

400 VERSION

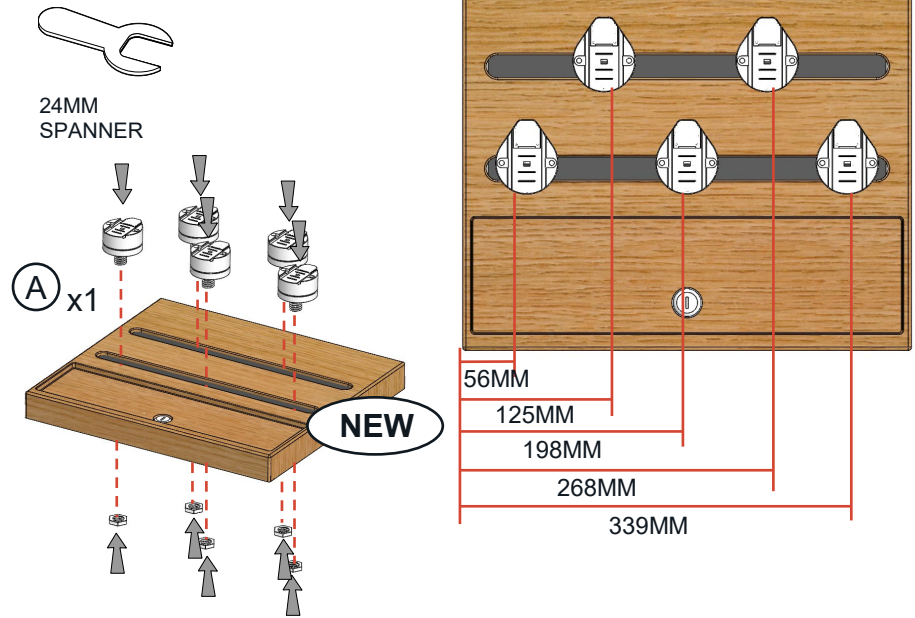

14 600 VERSION

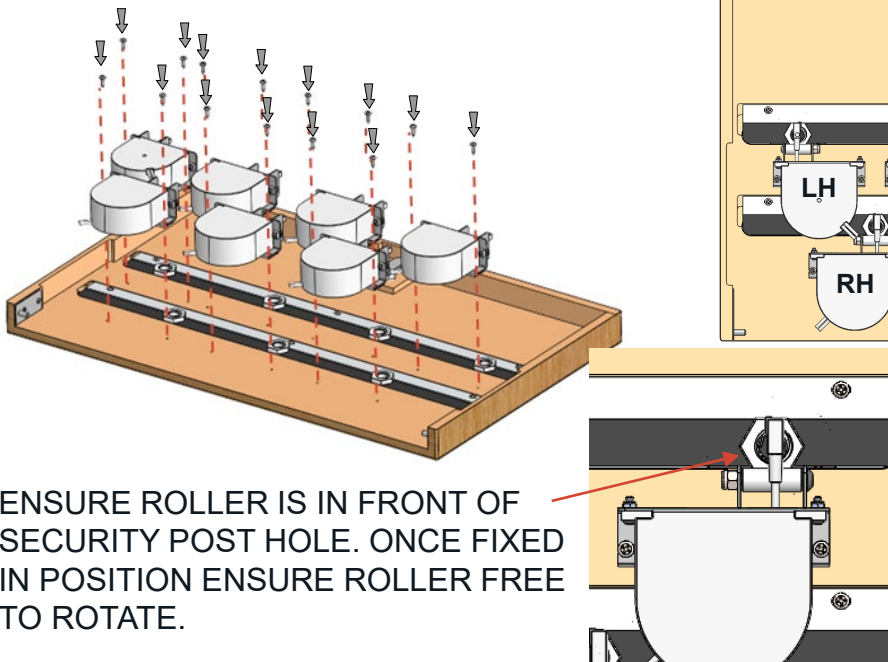

400 VERSION

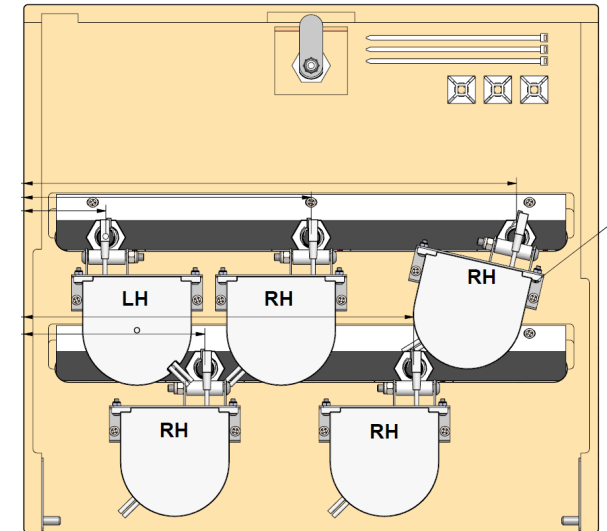

15

TEST RECOILER FOR SMOOTH MOVEMENT

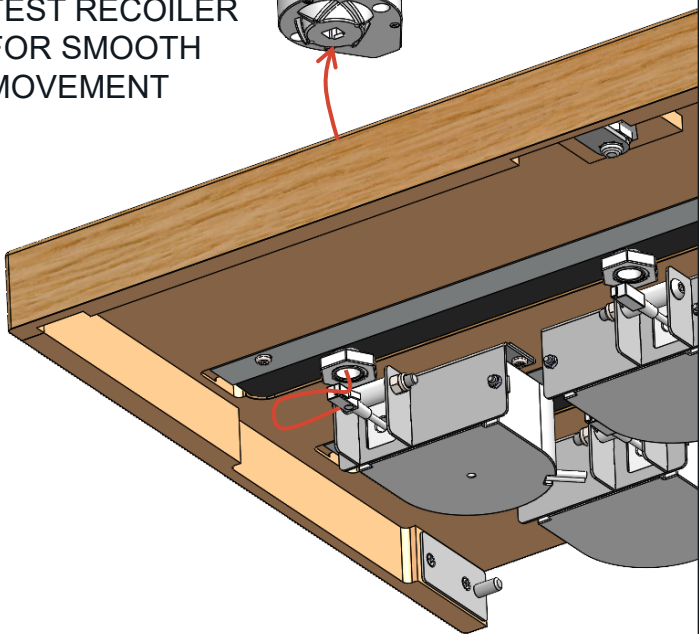
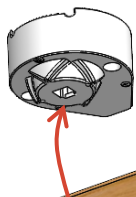

16

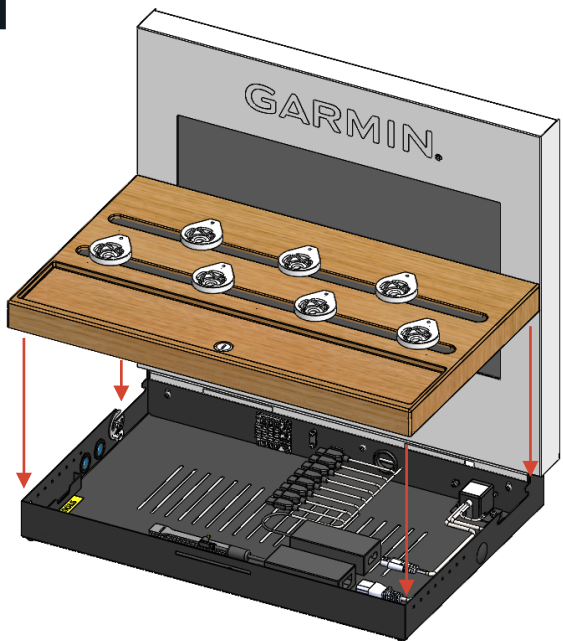

17

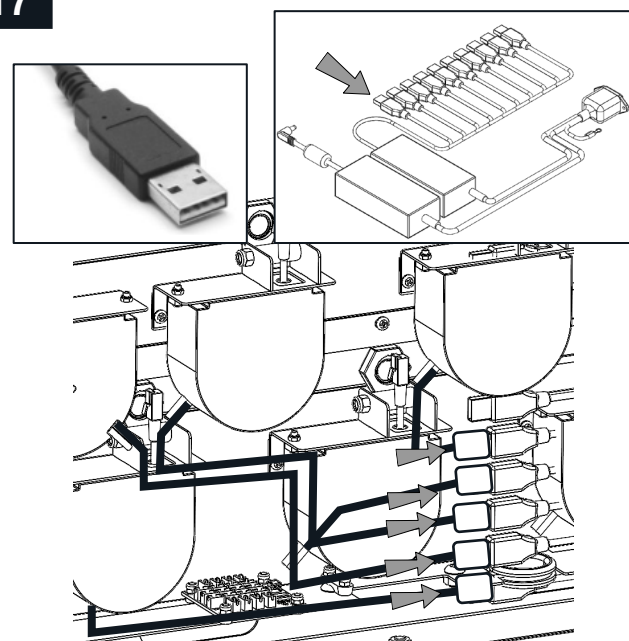

18

PLUG CORRESPONDING POSITIONS TO PCB BOARD

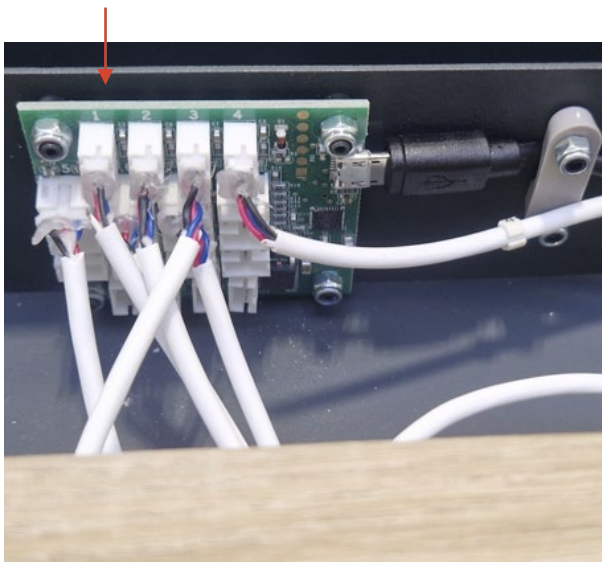

600 VERSION

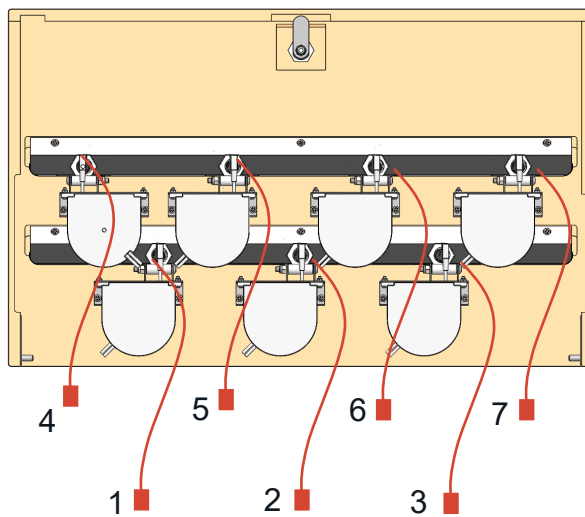

400 VERSION

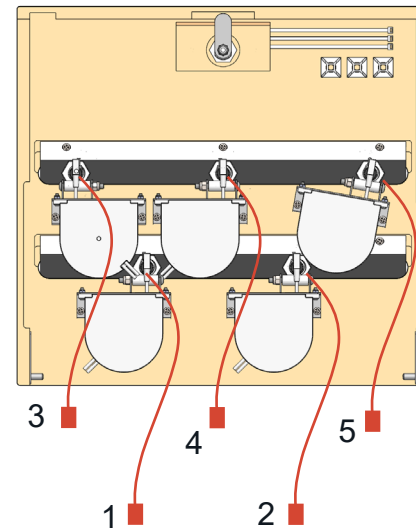

19

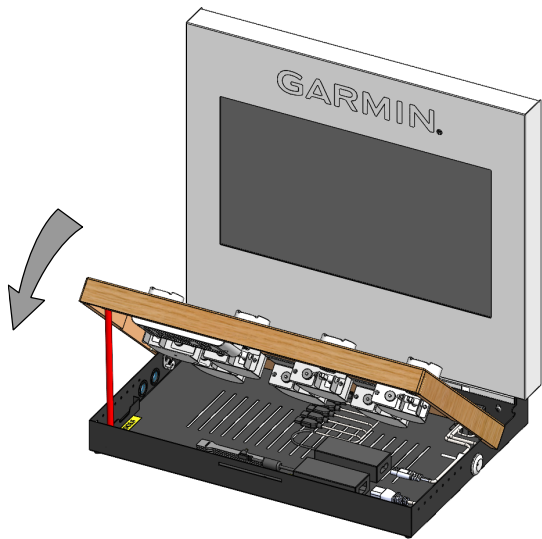

20

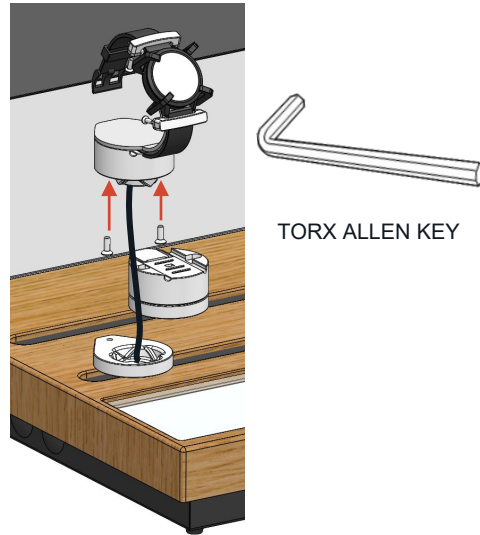

21

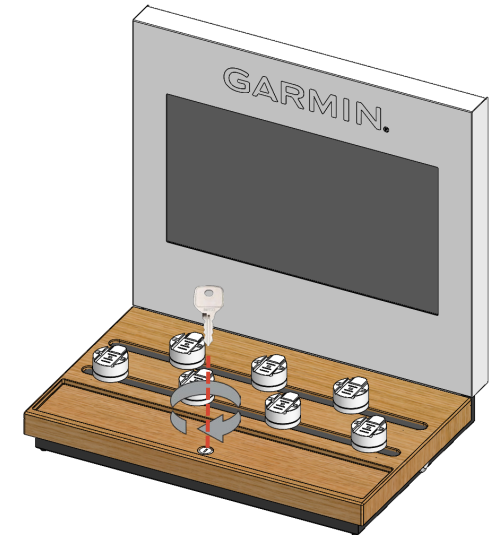

22

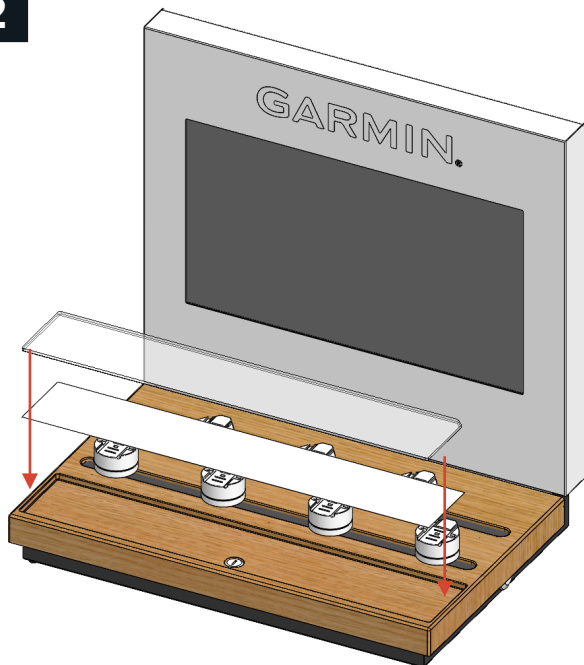

23

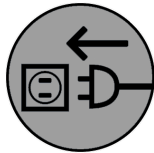

1. PLUG UNIT IN.
2. WAIT FOR SCREEN TO POWER ON.
3. LIFT EACH PRODUCT AND ENSURE THE CORRECT CONTENT PLAYS ON THE SCREEN.
4. IF INCORRECT CONTENT PLAYS PLUGS TO THE PCB WILL NEED TO BE SWAPPED OVER.

